



# All Surface™ Classic/Pink Swingball® Assembly Instructions Adult Assembly Required

**⚠ WARNING!**  
Choking Hazard - Small parts.  
Not for children under 3 years.

Item No. 7227/7219



**1**

## Unpack base

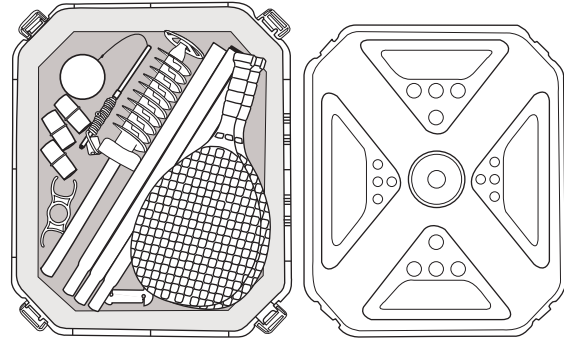

Please dispose of all unwanted packaging.

**2**

## Contents

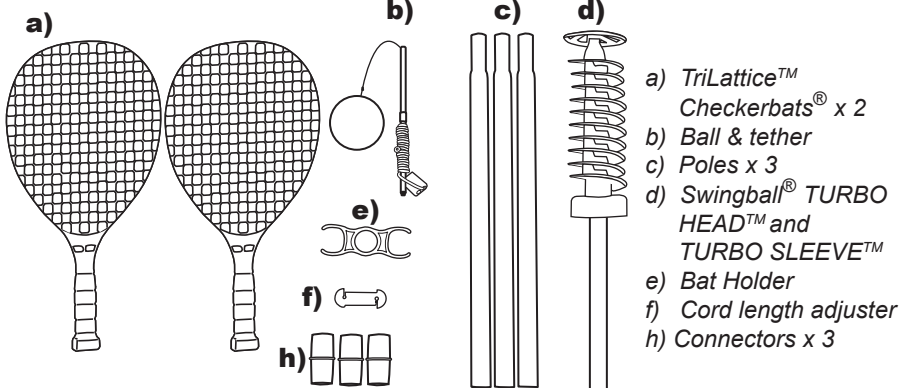

**3**

## Insert first pole into base

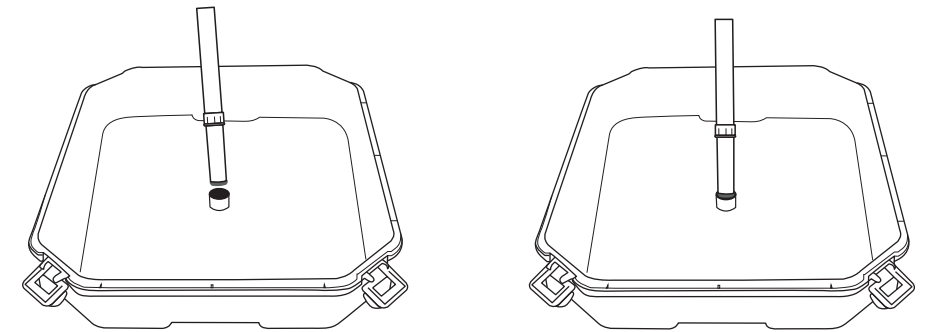

(Please note that the first pole has a plastic stopper in the end.)

**4**

## Fill to the brim with sand or water and slide lid down over pole so that collar on pole is below the lid

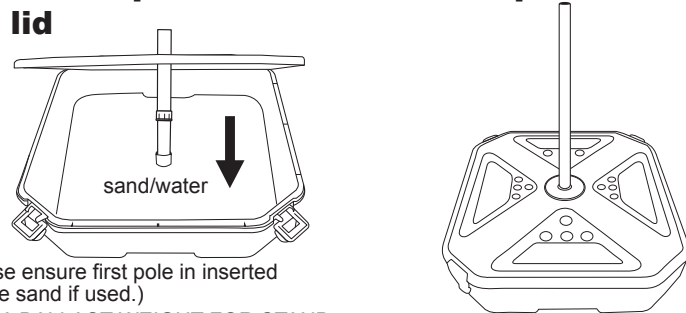

(Please ensure first pole is inserted before sand if used.)

**EXTRA BALLAST WEIGHT FOR STAND:**  
The All Surface™ stand is fine for gentle play if filled with water alone. For more robust play, please add extra ballast such as sand, bricks or stones for extra stability.

**5**

## Fasten clips securely

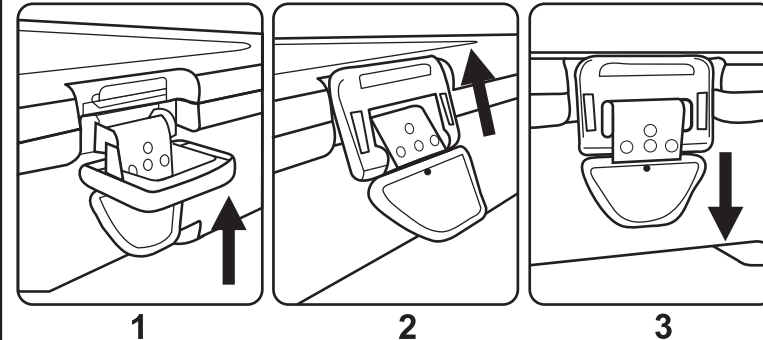

**6**

## Push on connector and second tube

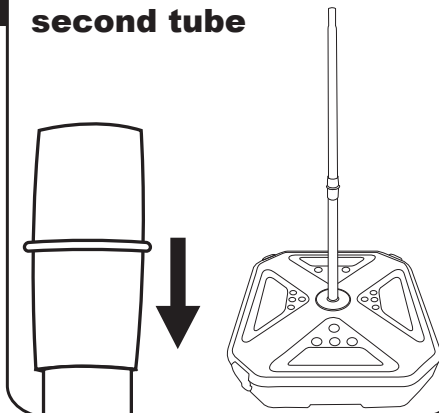

**7**

## Push on connector, bat holder & third tube

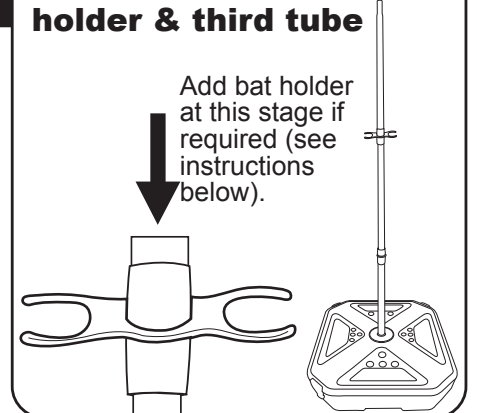

Add bat holder at this stage if required (see instructions below).

**8**

## Push on connector and Swingball® TURBO HEAD™

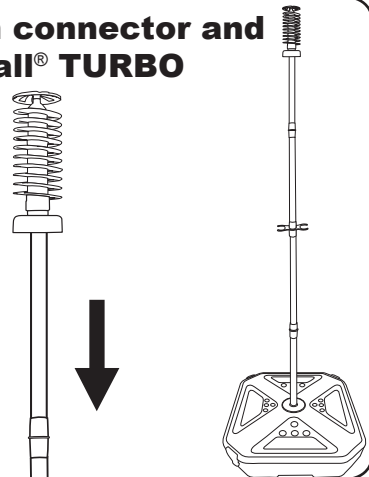

**9**

## Place loose-loop tether over Swingball® TURBO SLEEVE™

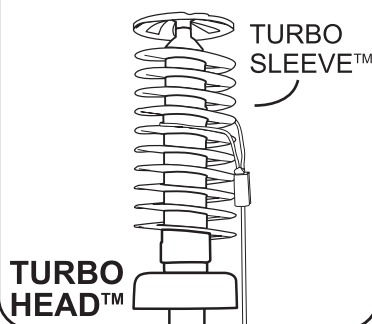

**10**

## Ready to play

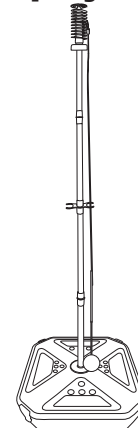

**11**

## To adjust height of All Surface™ Swingball®

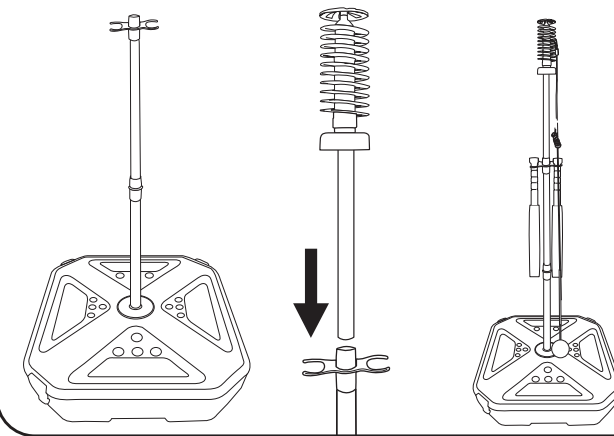

Remove the pole section immediately below the top pole and TURBO HEAD™. Reattach TURBO HEAD™ and pole to top of remaining poles, i.e. use only three poles instead of four.

**12**

## To adjust length of ball and tether

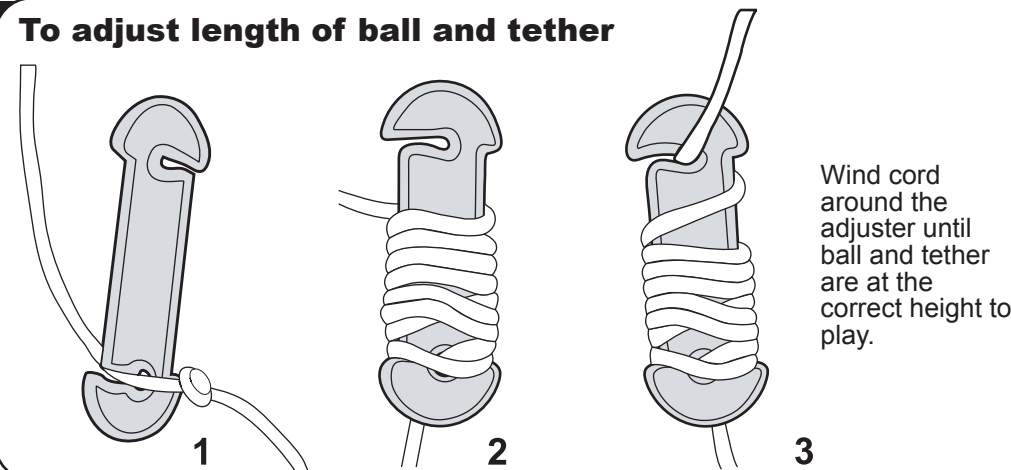

Wind cord around the adjuster until ball and tether are at the correct height to play.

## Bat Holder

**1** If bat holder is required, slide bat holder onto second connector before adding third pole.

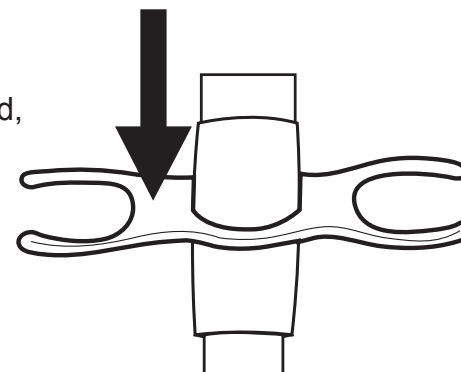

**2** Once the All Surface™ Swingball® is fully assembled, insert bats into bat holder (turn the bats to slide them in and out of the holder).



"click"