

# Atlas - Standard Single Door

Assembly Instructions - Please keep for future reference

144/7174

157/8067

157/4085

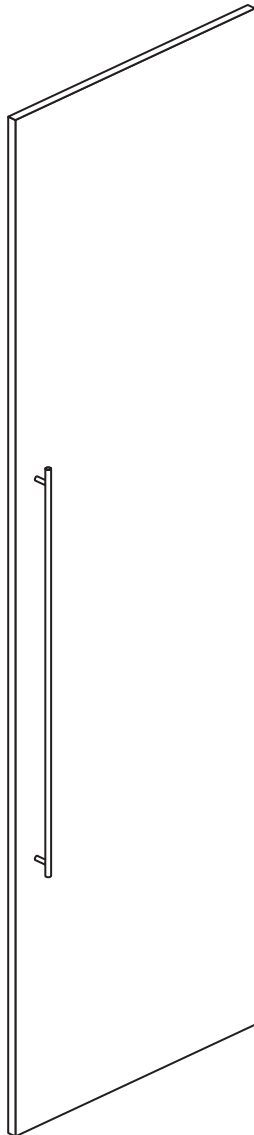

## IMPORTANT

Have you purchased a Single Robe  
and an Internal 3 Drawer Chest?  
The Chest must be placed into the  
Robe BEFORE the Door is fitted.

### Dimensions

Width - 49.5cm

Depth - 1.5cm

Height - 210cm



**MADE IN  
BRITAIN**

**Important** - Please read these instructions fully before starting assembly

If you need help or have damaged or missing parts, call the **Customer Helpline: 08456 400800**



# Safety and Care Advice

**Important** - Please read these instructions fully before starting assembly

- **Warning:** This panel weighs approximately 11kgs. Please lift with care.

- Check you have all the components and tools listed on pages 2 and 3.

- Remove all fittings from the plastic bags and separate them into their groups.

- Keep children and animals away from the work area, small parts could choke if swallowed.

- Parts of the assembly will be easier with 2 people.

- Make sure you have enough space to layout the parts before starting.

- Do not stand or put weight on the product, this could cause damage.

- Assemble the item as close to its final position (in the same room) as possible.

- Assemble on a soft level surface to avoid damaging the unit or your floor (use opened out unit carton).



- We do not recommend the use of power drill/drivers **for inserting screws**, as this could damage the unit. Only use hand screwdrivers.

- **Safety note:** If there is any chance of this unit being pulled over by children etc. it is recommended that the unit is secured to a wall using suitable fixings (not supplied).

- Dispose of all packaging carefully and responsibly.

## Care and maintenance

- Only clean using a damp cloth and mild detergent, do not use bleach or abrasive cleaners.

- From time to time check that there are no loose screws on this unit.

- This product should not be discarded with household waste. Take to your local authority waste disposal centre.

**Note:** If required the next page can be cut out and used as reference throughout the assembly. Keep this page with these instructions for future reference.

# Component - Panel

If you have damaged or missing components, call the  
**Customer Helpline: 08456 400800** quoting the reference  
numbers below

Please check you have the panel listed below



Standard Door (D2398A)  
(2100 x 495mm)

# Components - Fittings

If you have damaged or missing components, call the  
**Customer Helpline: 08456 400800** quoting the reference  
numbers below

These fittings are packed with the Robe Carcass.  
The quantities will depend on which robe you have bought.

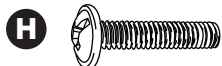

19mm Screw (F461)



13mm Screw (F63)

**N**

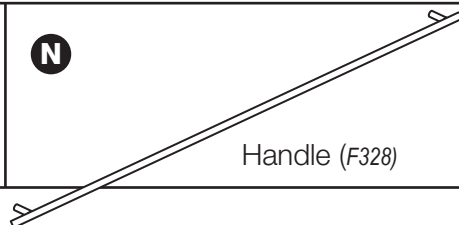

Handle (F328)

**O**

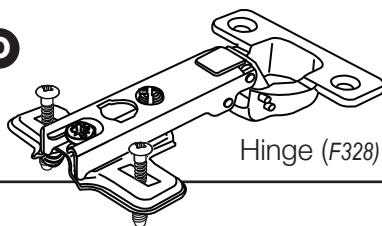

Hinge (F328)



# Assembly Instructions

If you have damaged or missing components, call the  
**Customer Helpline: 08456 400800** quoting the reference  
numbers below

## Step 1

**Have you purchased a Mirror Door?**

### IMPORTANT

If you have purchased a Mirror Door,  
**DO NOT** follow these instructions.  
Please use the instructions packed  
with the Mirror Door.

## Step 2

### **Prepare the door(s)**

Push fit 4 hinges **O** into each door.

Secure each hinge with 2 screws **J**.

**Note:** Before securing with the screws, make sure that the hinges are positioned at 90 degrees with the edge of the door.

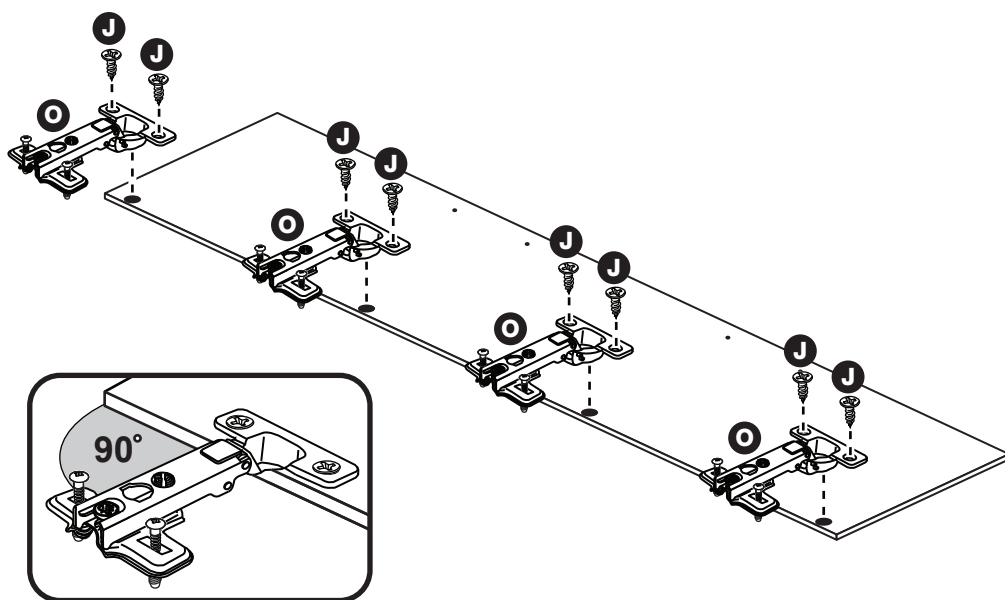

# Assembly Instructions

## Step 3

**For a door which has a handle on the left, drill these 2 handle holes**

**Important:** Please follow these instructions carefully.

Lay the door down onto a smooth surface.

Check that the hinges and holes are in the same place as the diagram.

**Note:** We recommend the use of a small piece of waste wood, placed behind the holes while drilling, to reduce the possibility of any breakout.

Using the pilot holes in the rear face of the door, drill through the 2 holes indicated opposite, using a 2.5mm diameter drill.

Turn the door over and open out the 2.5mm holes that you have just drilled by drilling back through them with a 5mm drill.

### IMPORTANT

This step shows which handle holes to drill for doors that have their handles on the **LEFT**, as shown below.

Go to Step 4 for how to drill a door with its handle on the **RIGHT**.

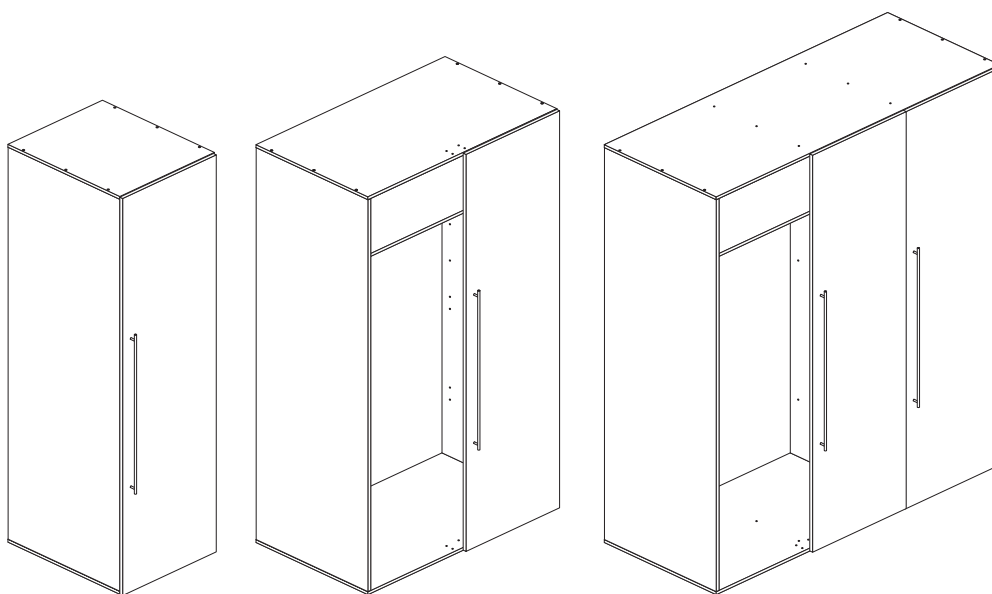

### **ONLY** drill these 2 holes

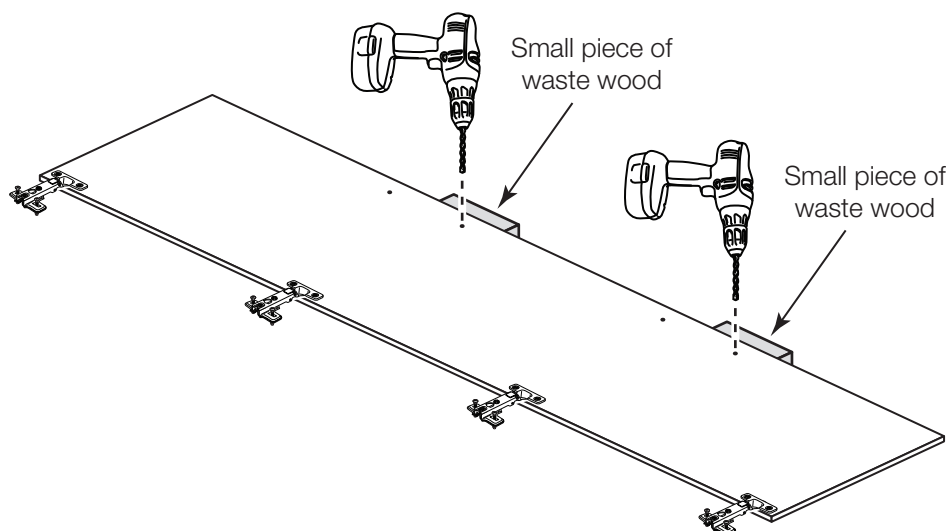

# Assembly Instructions

## Step 4

**For a door which has a handle on the right, drill these 2 handle holes**

**Important:** Please follow these instructions carefully.

Lay the door down onto a smooth surface.

Check that the hinges and holes are in the same place as the diagram.

**Note:** We recommend the use of a small piece of waste wood, placed behind the holes while drilling, to reduce the possibility of any breakout.

Using the pilot holes in the rear face of the door, drill through the 2 holes indicated opposite, using a 2.5mm diameter drill.

Turn the door over and open out the 2.5mm holes that you have just drilled by drilling back through them with a 5mm drill.

### IMPORTANT

This step shows which handle holes to drill for doors that have their handles on the RIGHT, as shown below.

Go to Step 3 for how to drill a door with its handle on the LEFT.

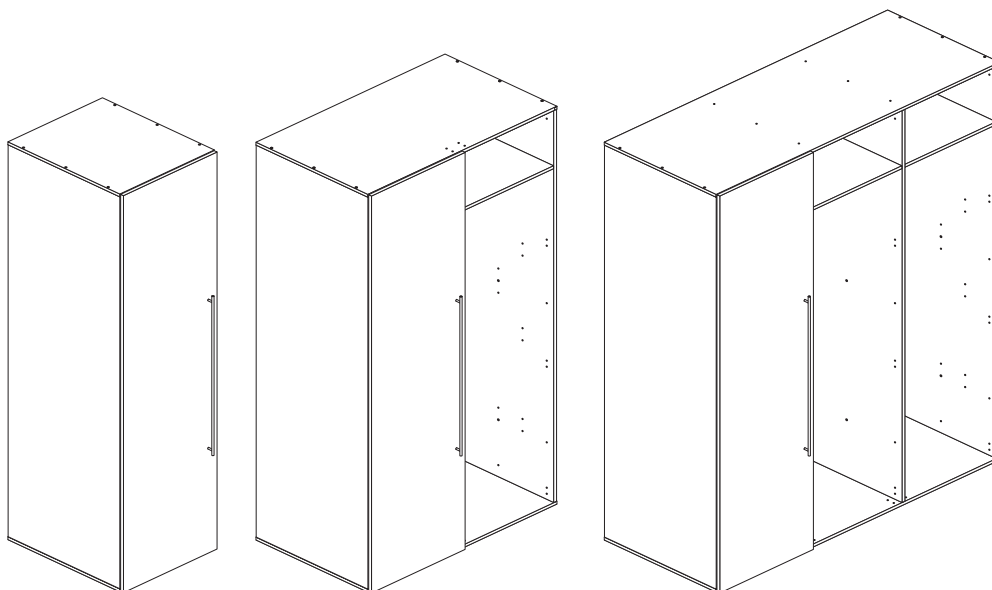

### ONLY drill these 2 holes

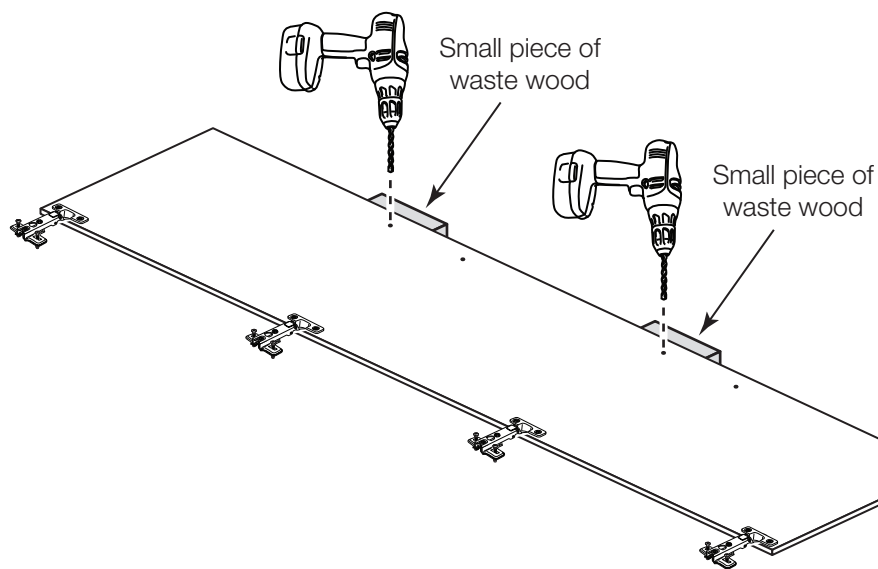

# Assembly Instructions

## Step 5

### Fit the door(s) and the handle(s)

#### *2 people are needed here*

Make sure that the door is the correct way around. The bottom hole on the back surface of the door will be one of holes that you have drilled.

Line up the 2 screws in the top hinge **O** with the 2 holes at the top of the panel and push them in.

Working down the door, push in the other hinges.

When all of the hinges have been pushed into place, tighten the 2 screws on each hinge.

Attach a handle **N** to the door using 2 screws **H**.

Press the screws into the holes in the panels

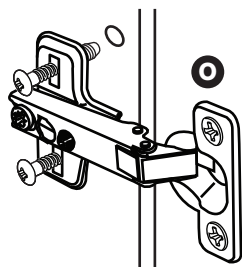

When the hinges have been pushed in, tighten up their screws

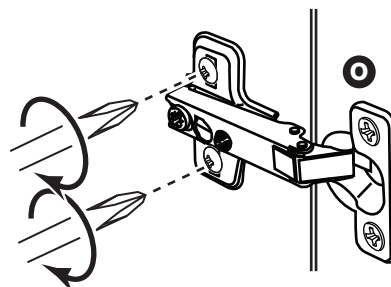

This shows a door being fitted onto the right side of a single robe. The same assembly method applies to all doors and robes.

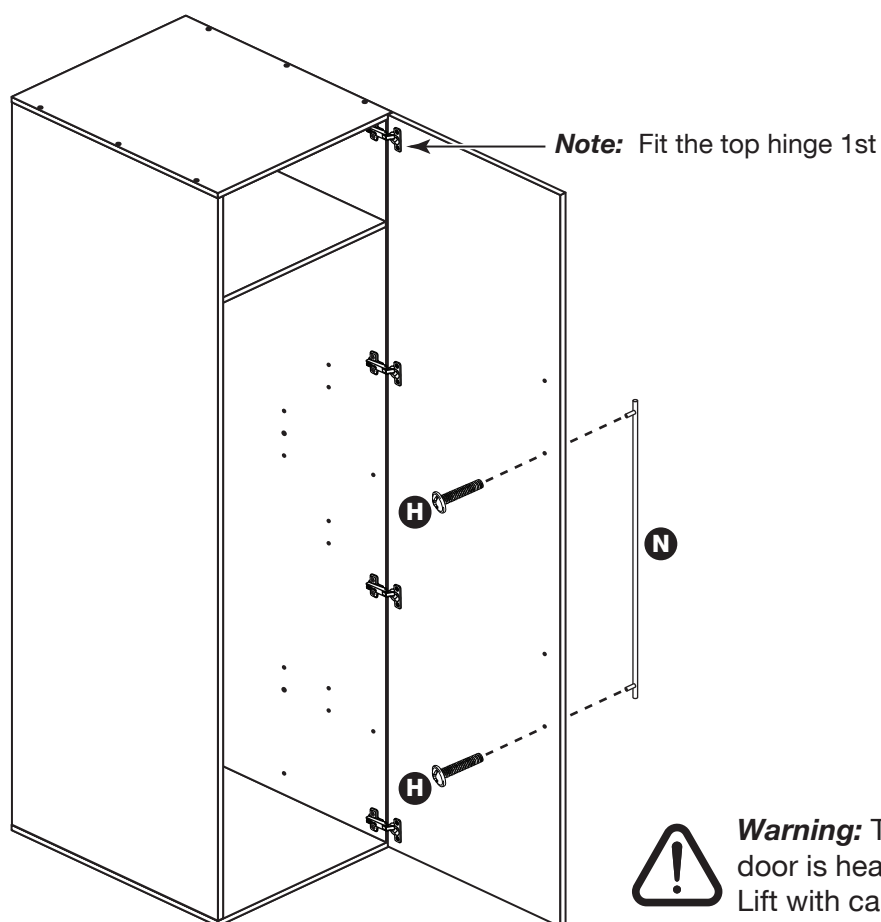

# Assembly Instructions

## Step 6

### Adjust the door if needed

**a:** Before adjusting the door, use a spirit level to check the top (or base) of the unit is level, front-to-back and side-to-side in the 3 positions shown. Use suitable packing pieces (not supplied) to make the unit level BEFORE making any adjustment to the hinges, as shown.

### **b:** Height adjustment.

Loosen screws A on hinge plates and move door up or down as required. Retighten screw A.

### **c:** Forward and Back adjustment.

Loosen screw B on hinge plate and move door in or out as required. Retighten screw B.

### **d:** Sideways adjustment.

To move door 'out' loosen screw C. To move door 'in' tighten screw C.

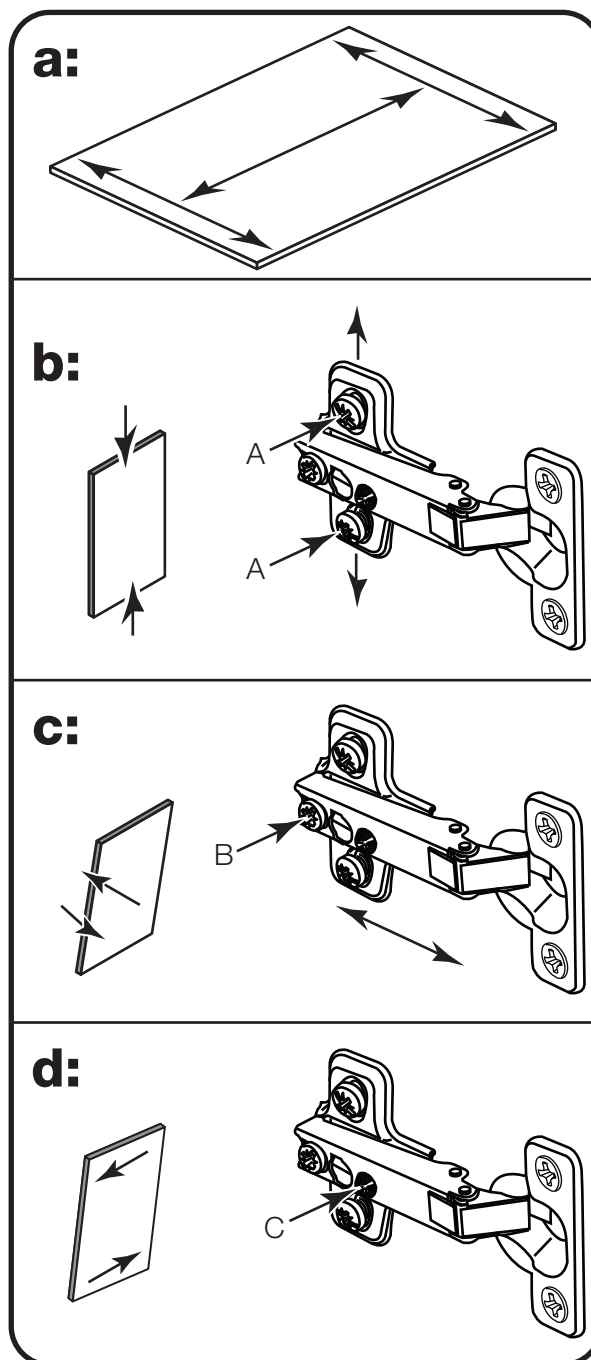

If you need help or have damaged or missing parts, call the Customer Helpline: 08456 400800 and quote the reference numbers on the component pages.

Argos Ltd, 489-499 Avebury Boulevard, Central Milton Keynes, MK9 2NW