

Sand and Water Table w.accessories

Assembly & User Instructions - Please keep for future reference

1465039



Important

Age: 2+ years

Important - Please read these instructions fully before assembly or use

These instructions contain important information which will help you get the best from your product and ensure safe and correct assembly, use and maintenance.

If you need help or have damaged or missing parts, call the **Customer Helpline: 01291 650581**

Parts

If you have damaged or missing parts,
call the **Customer Helpline: 01291 650581**

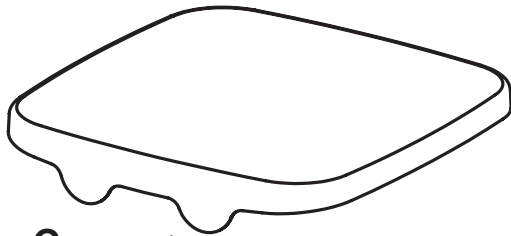

Cover x1
2-33-509

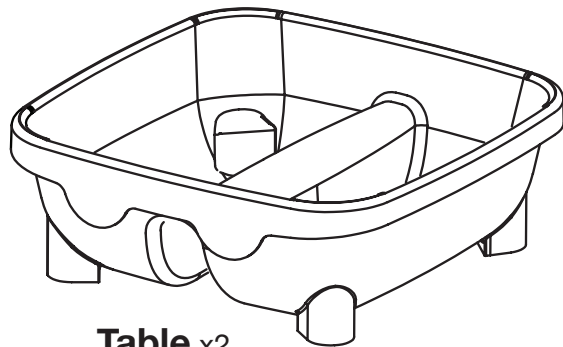
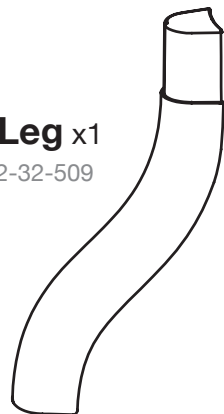

Table x2
1-33-509



Leg x1
2-32-509



Puffer x4
3-33-509



Spatula x1
14-990

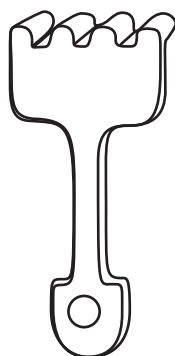

Rake x1
13-990

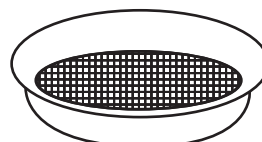

Collander x1
66-990

Assembly Instructions

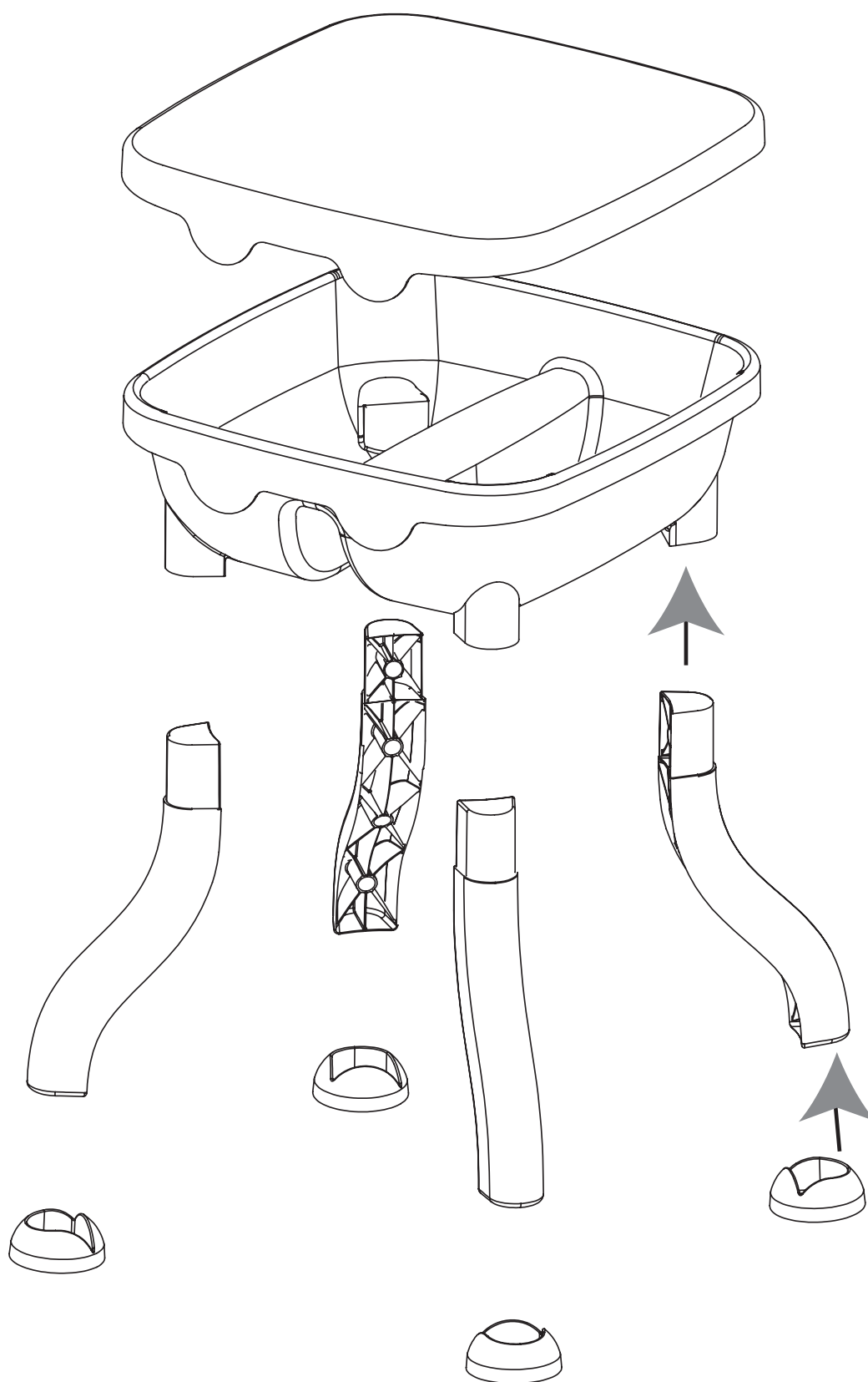

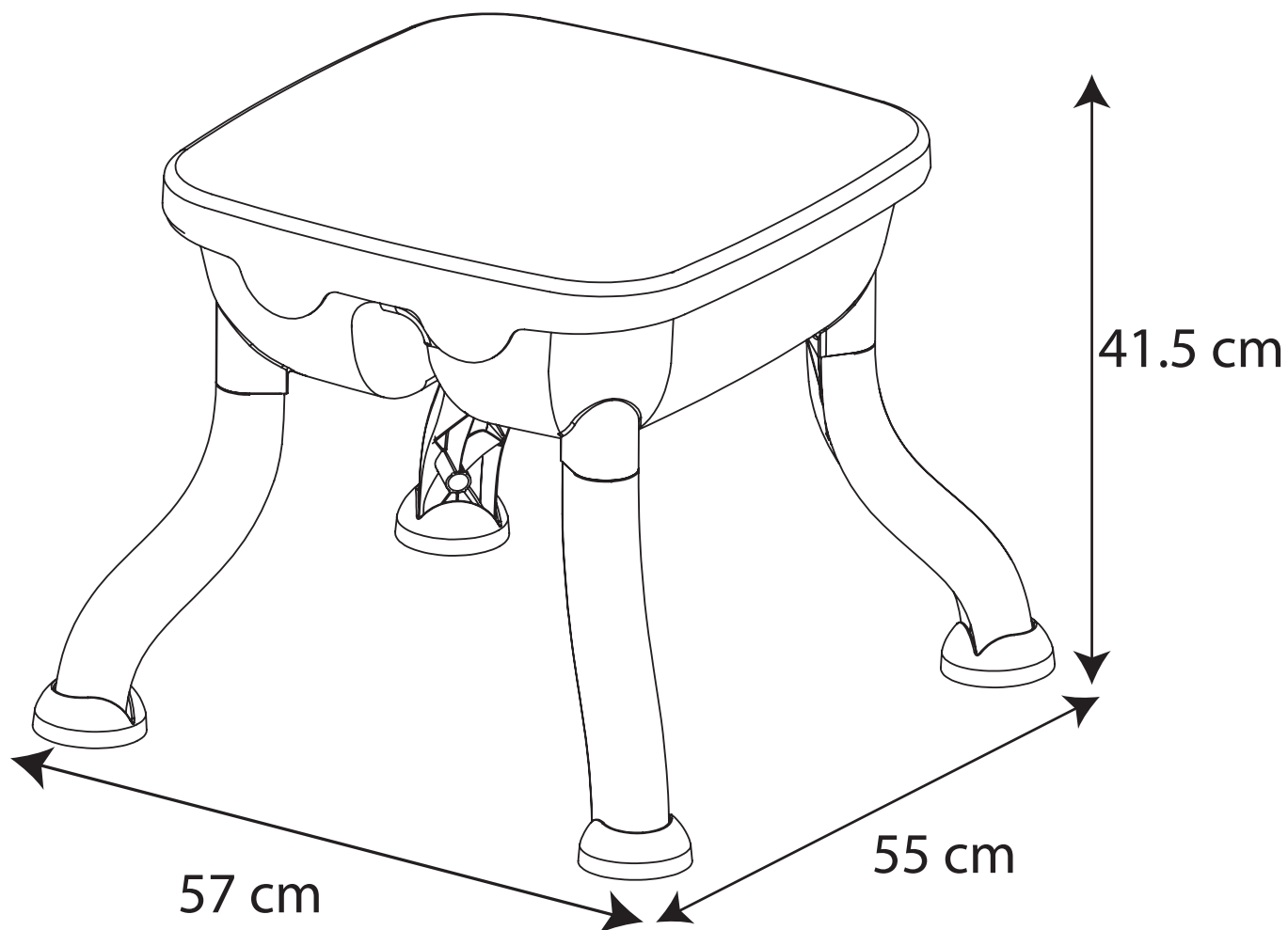

- WARNING! Domestic use only.
- WARNING! For indoor/outdoor use.
- WARNING! Recommended age of use: 2 years and above.
- WARNING! Max. load 30 kg.
- Use under adult supervision.
- Remove all packaging materials such as: bags, bands & cardboard packaging.
- Check the toy regularly before use.
- Adult assembly required.
- Please keep this instruction sheet for future reference.
- Product is not intended to be seated on.



If you need help or have damaged or missing parts, call the **Customer Helpline: 01291 650581**

Produced for Chad Valley Toys. Country of origin: Israel.

Address: Argos LTD 489-499 Avebury Boulevard, Central Milton Keynes, MK9 2NW.

www.argos.co.uk/chadvalley