

Heavy Duty

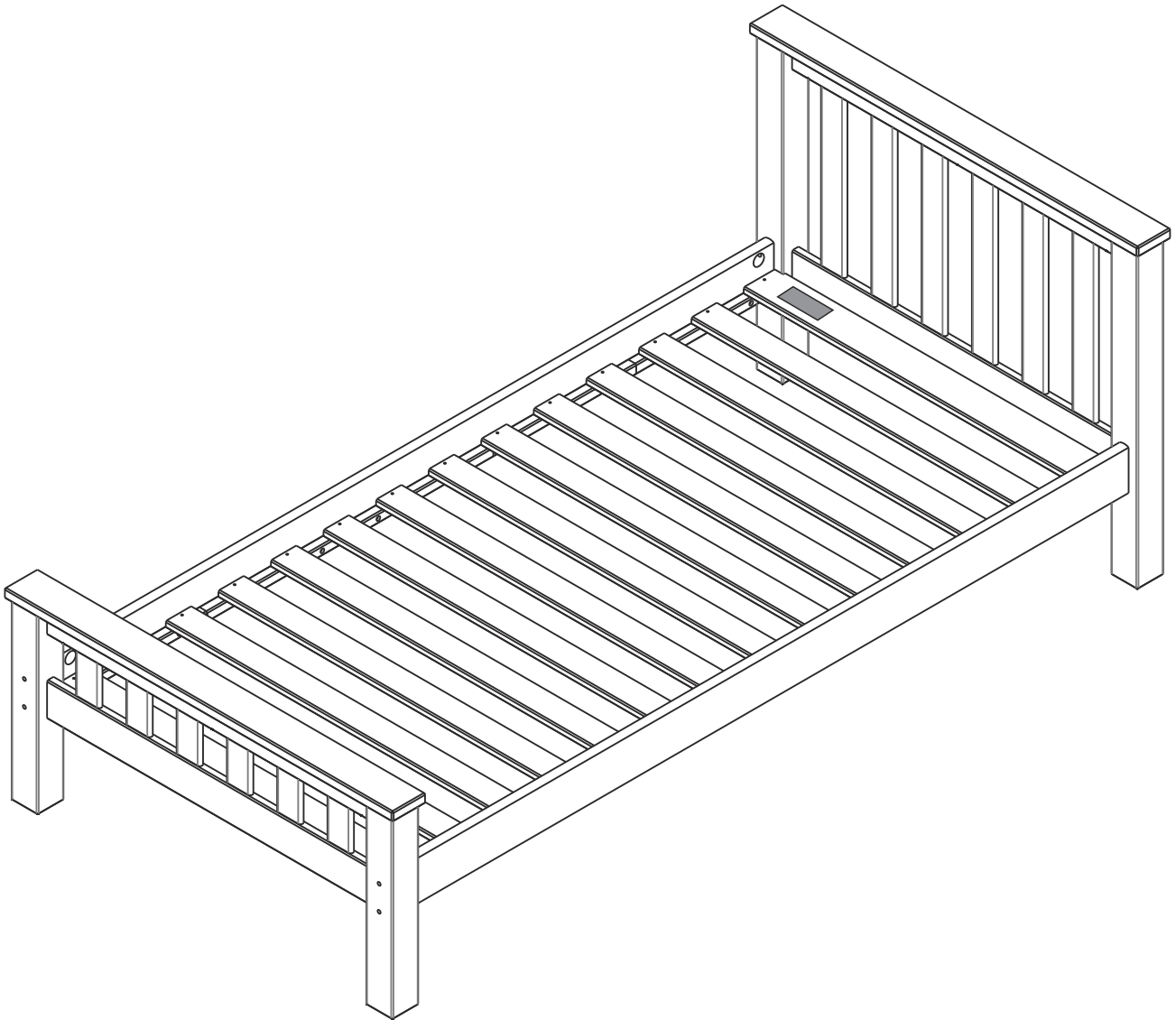

Spare Parts

 www.argos-support.co.uk

 Help@ClickSpares.co.uk

 0370 112 1928

Customer Support

 0345 640 2020



Safety and Care Advice

Product Details Heavy Duty Single Bed Pine 135/6540

IMPORTANT! KEEP IT FOR FUTURE REFERENCE: READ CAREFULLY.

- Keep children and animals away from the work area, small parts could choke if swallowed.
- Make sure you have enough space to layout the parts before starting.
- This product has been constructed to be used in the domestic environment only and not for commercial purpose.

- Assemble the item as close to its final position (in the same room) as possible.
- Assemble on a soft level surface to avoid damaging the unit or your floor.

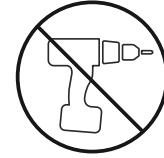

- We do not recommend the use of power drill/drivers for inserting screws as this could damage the unit. Only use hand screwdrivers.
- Parts of the assembly will be easier with 2 people.
- Dispose of all packaging carefully and responsibly.

Care and maintenance

- Use a dry cloth to clean the product, furniture polish is not recommended.
- From time to time check that there are no loose screws, nuts or bolts. If there are please re-tighten.
- This product should not be discarded with household waste. Take to your local authority waste disposal centre.

Additional Guidance

- Assemble all parts and bolts loosely during assembly, only once the product is complete should you fully tighten the bolts.
- Regularly check and ensure that all bolts and fittings are tightened properly.
- Maximum user weight 100kg
- This Product is compliant BS 8509



Safety and Care Advice

Product Details Heavy Duty Single Bed Pine 135/6540

IMPORTANT! KEEP IT FOR FUTURE REFERENCE: READ CAREFULLY.

Warnings for the bed

Warning: Do not place this child's bed near heat sources, windows and other furniture

Warning: Do not use this child's bed if any part is broken, torn or missing.

Warning: Not suitable for children under 4 years.

-Designed and manufactured to BS 8509: 2008 + A1: 2011

-Model: 135/6540

-Retailer: Argos

- The bed is suitable for children age from 4 years and older.

- The bed is suitable for a mattress of 190cm in length and 90cm in width.

- Periodically check that all fittings are always properly tightened.

- Children are likely to play, bounce, jump and climb on beds,

herefore the child's bed should not be placed too close to other,

furniture or windows, blind cords, curtain pulls or other strings or cords and should be placed either tight

to any wall or have a gap of 300mm between the wall and side of the bed.

This bed is not designed to be dismantled for storage or transportation.

Any additional or replacements parts are obtained from Customer Helpline: 03456 400 800

- Assembly to be carried out by a competent adult only!

- During assembly children should be kept away from the product due to possible risk of injury.

- Do not use this item if any components are missing or damaged.

Panels

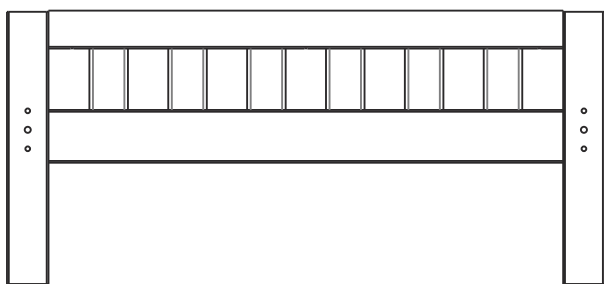

1 Footboard (x01) (1008 x 462mm)

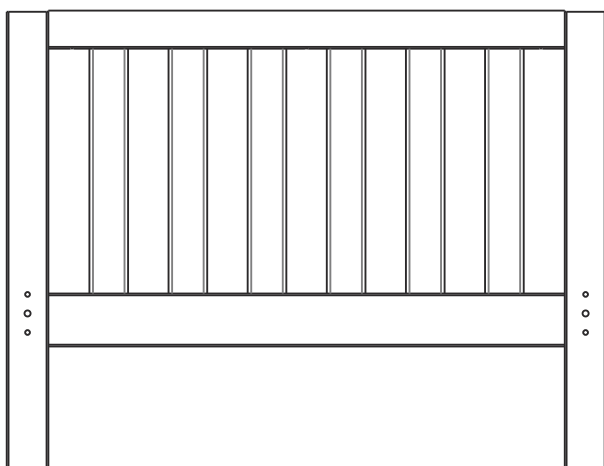

2 Headboard (x01) (1008 x 770mm)

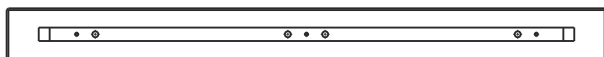

3 Top rail (x02) (1028 x 89mm)



4 Side Rail (x02) (1900 x 110mm)



5 Slat (x01) (910 x 90mm)



6 Slat (x12) (910 x 70mm)



7 Slat with Label (x1) (910 x 90mm)

Fittings

A

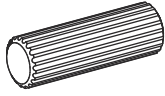

Wooden dowel x 10
10 x 50mm 10005

B

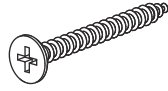

4 x 35mm Screw x 28
9013

C



Half Moon Nut x 4
6000

D

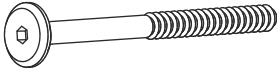

7 x 70mm Bolt x 6
Cab. 13 9112

E

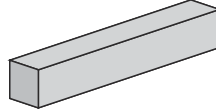

69mm Spacer x 2
11505

F



1/4 x 100mm Bolt x 4
Cab. 17 9200

G

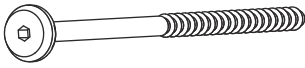

7 x 110mm Bolt x 4
Cab. 17 9117

H

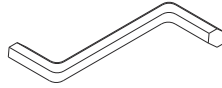

Allen Key

Tools required



Phillips screwdriver
(small & medium)

1

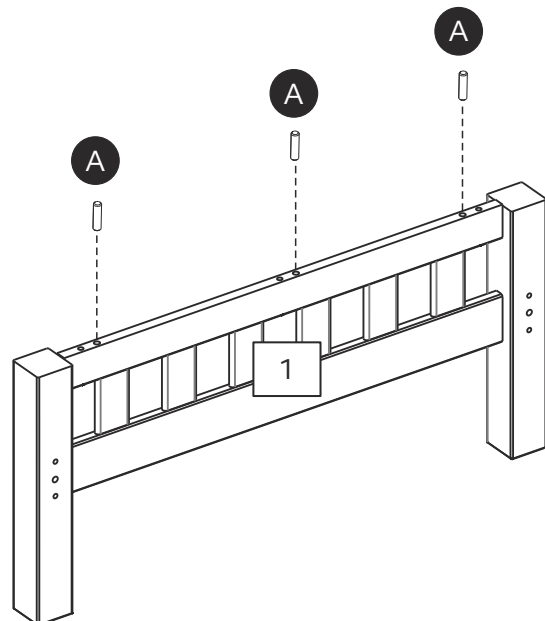
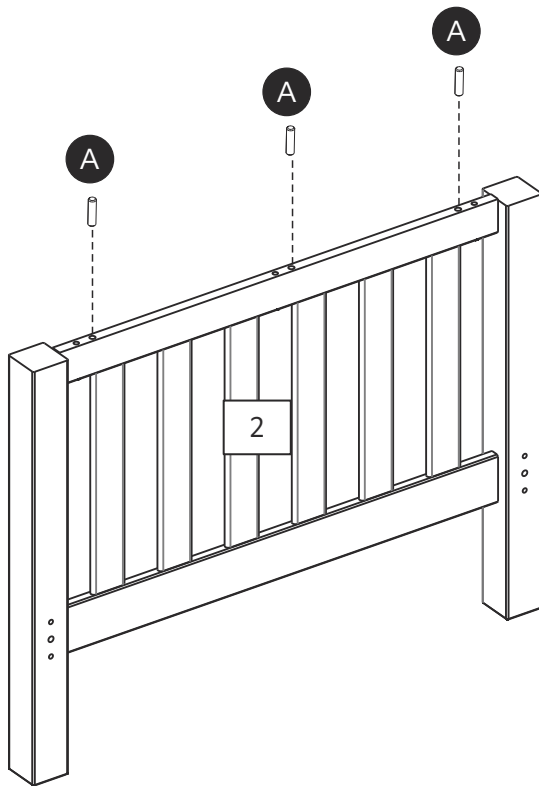
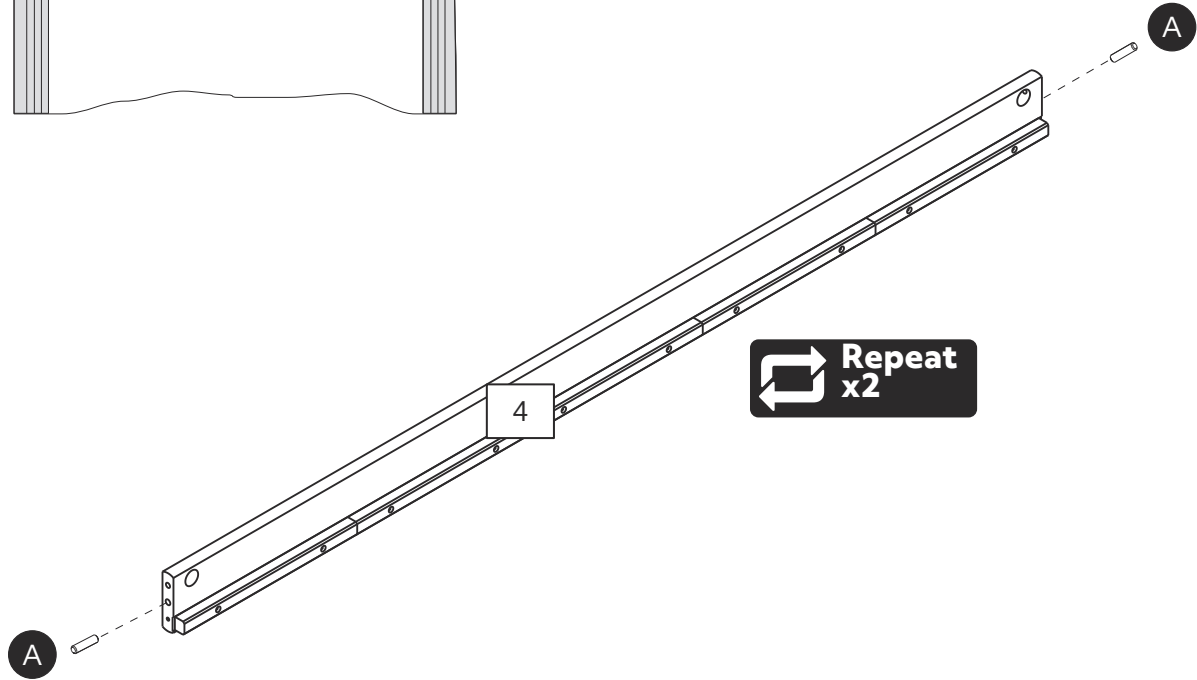
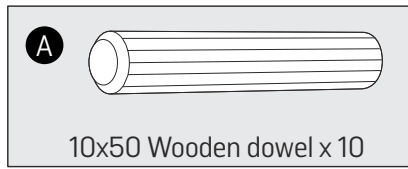
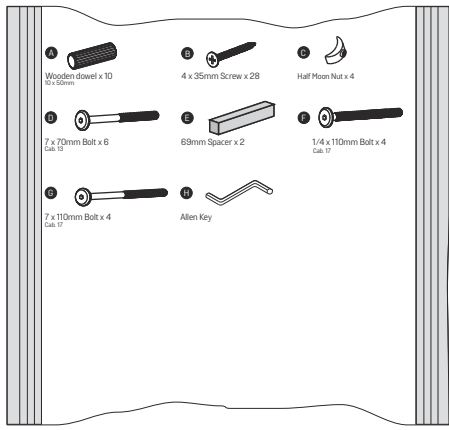

2

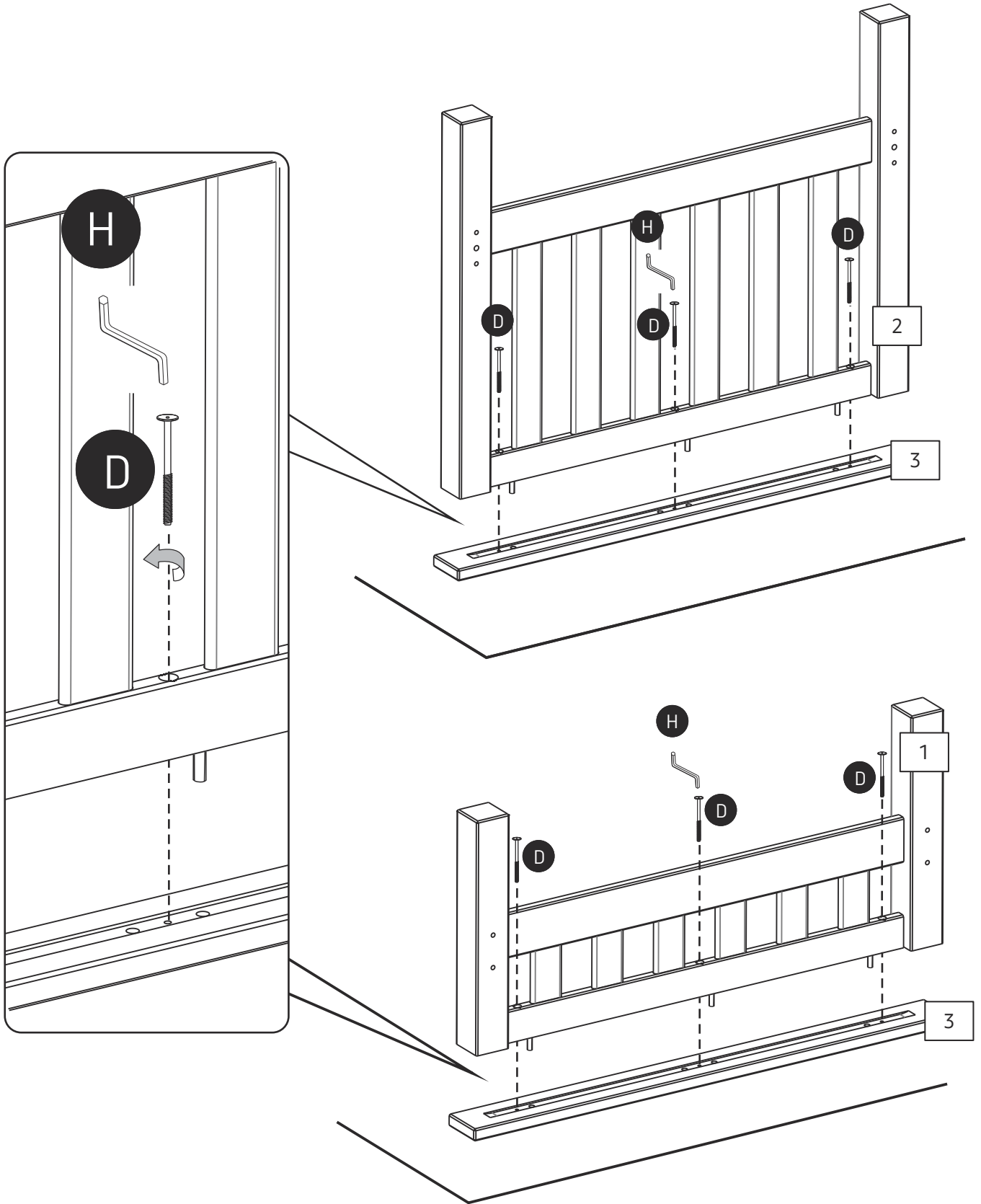
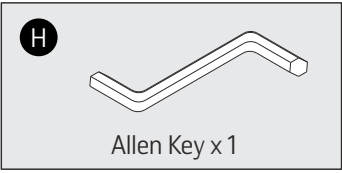
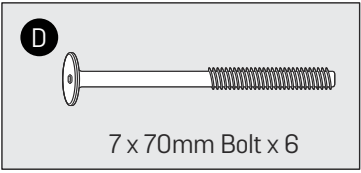

3

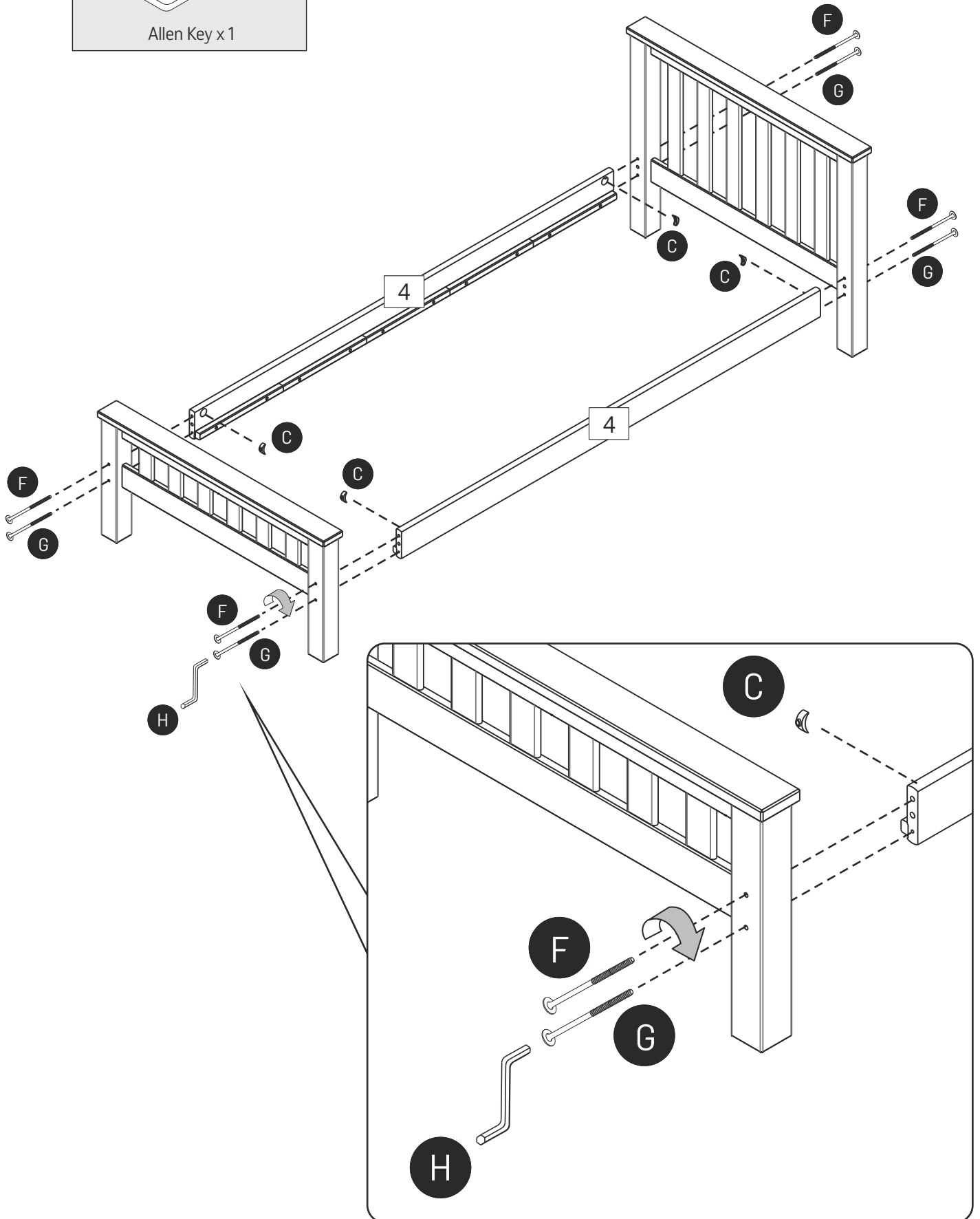
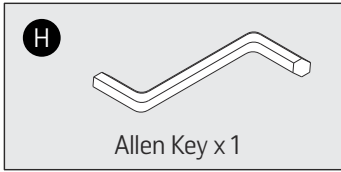
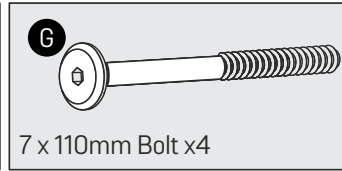
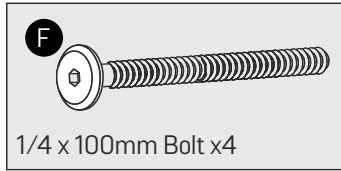

4

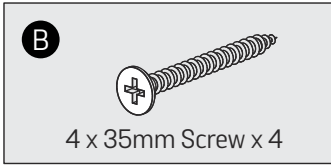

ARGOS LTD
Bs8509: 2008
+A1: 2011

WARNING NOT SUITABLE
FOR CHILDREN
UNDER 4 YEARS

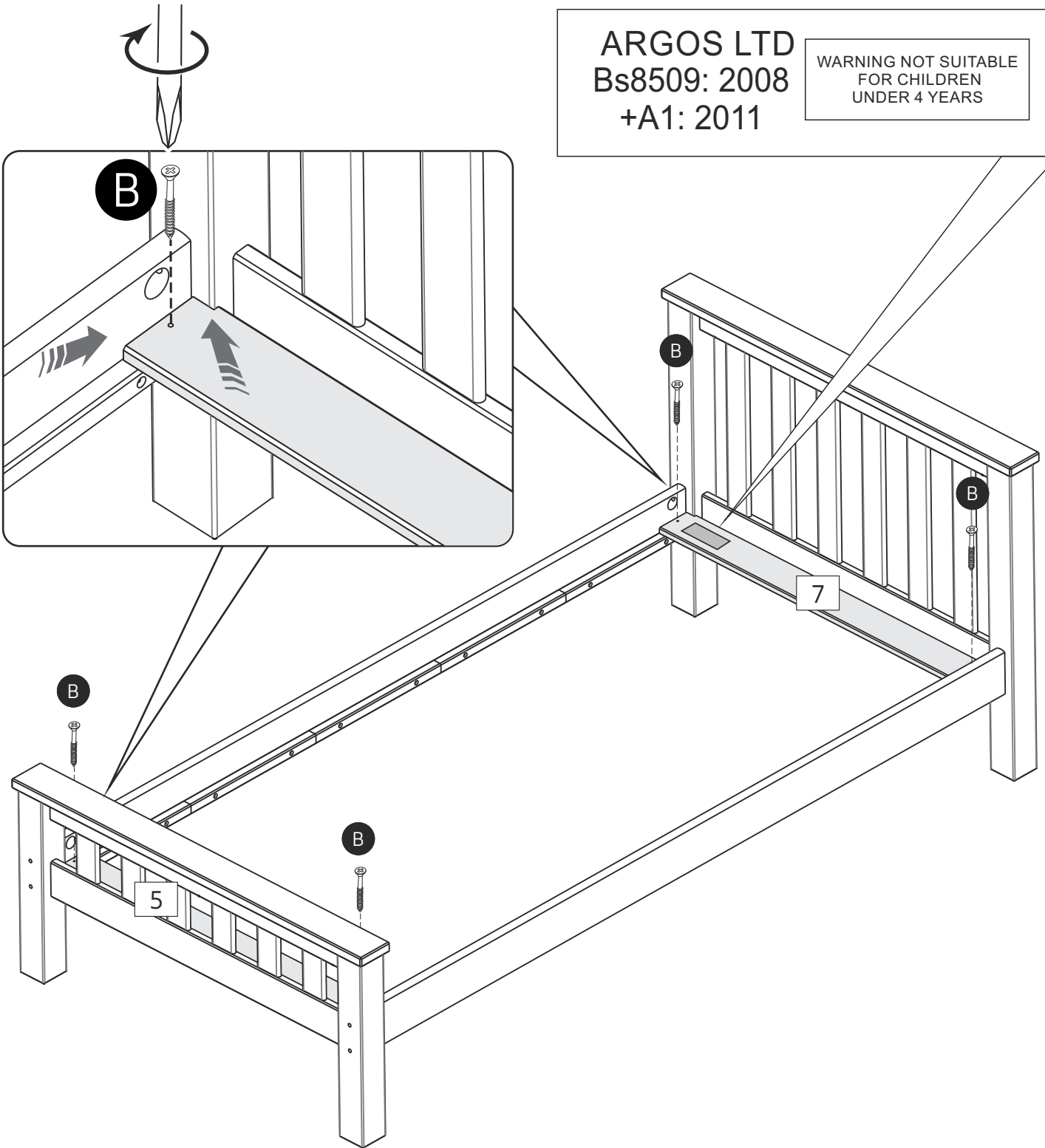

5

