

### 1. PRODUCT OVERVIEW

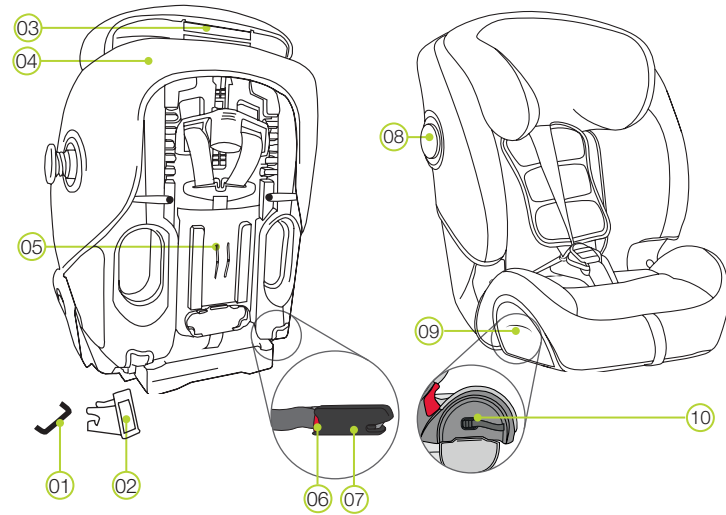

- 01 ISOFIX fastening points (car)
- 02 ISOFIX insertion aids
- 03 Headrest adjuster
- 04 Backrest
- 05 Compartment for the user instructions
- 06 ISOFIT Locking button
- 07 ISOFIT locking arms
- 08 SICT
- 09 Cover flap
- 10 ISOFIT adjustment button

If you have any questions regarding the use of the product, please feel free to contact us:  
**BRITAX RÖMER Kindersicherheit GmbH**  
 Blaubeurer Strasse 71  
 D-89077 Ulm  
 Germany  
 T.: +49 (0) 731 9345-199/-299  
 F.: +49 (0) 731 9345-210  
 E.: service.de@britax.com  
 www.britax.eu

**BRITAX EXCELSIOR LIMITED**  
 1 Churchill Way West  
 Andover  
 Hampshire SP10 3UW  
 United Kingdom  
 T.: +44 (0) 1264 333343  
 F.: +44 (0) 1264 334146  
 E.: service.uk@britax.com  
 www.britax.eu

### 5. CHANGING THE HARNESS

- Removing the 5-point harness**
- Loosen the harness straps as far as possible (see 9.1).
  - Push the shoulder strap adjuster (24) all the way up (see 8.1).
  - Unhook the shoulder straps (13) from the connecting piece (14).
  - Clip the connecting piece (14) at the bottom of the backrest (04) into its holder (11).
  - Push down the strap loops of the shoulder pads (18) from the base of the shoulder strap adjuster (24).
  - Pull the shoulder straps (13) and the strap loops of the shoulder pads (18) out of the belt slots.
  - Undo the Velcro fastener on the crotch cushion (21) and remove it.
  - On the bottom of the seat, unhook the adjusting strap (23) from the metal plate (27).
  - Turn the metal plate (27) (that holds the harness buckle (19) to the seat shell) on end and push it upwards through the belt slot (28).
  - Release the harness buckle (19).
  - Push the straps and buckle tongues (30) through the lap belt slots in the cover.
  - Place the harness buckle (19) under the cover and inside the storage compartment (31) of the backrest (04).
  - Push the adjusting strap (23) under the cover.
  - Fix the shoulder pads (18) and shoulder straps (13) in the rubber loops (32) at the feed-through points (15).
- Installing the 5-point harness**
- To install the straps, follow the steps in reverse order.
  - DANGER!** Tug on the shoulder straps firmly (13) to make sure that the 5-point harness is secure.

**DANGER!** Never use installation method A for the child safety seat unless the harness buckle and shoulder pads are properly attached (the straight edges of the shoulder pads must be pointing towards each other). Make sure that the metal plate of the harness buckle is correctly attached.  
**WARNING!** Ensure that the straps are not twisted, that they have not been accidentally interchanged and that they have been correctly inserted in the belt slots on the cover.

### 2. APPROVAL

<b>BRITAX RÖMER Vehicle child safety seat</b>	Tested and approved according to ECE* R 44/04 *ECE = European Standard for Child Safety Equipment	
	Group	Body weight
<b>EVOLVA 1-2-3 SL</b>	I	9 to 18 kg
<b>SICT</b>	II+III	15 to 36 kg

The child safety seat has been designed, tested and approved according to the requirements of the European Standard for Child Safety Equipment (ECE R 44/04). The seal of approval E (in a circle) and the approval number are located on the orange approval label (sticker on the child safety seat).

- DANGER!** This approval will be invalidated if you make any modifications to the child safety seat. Only the manufacturer is permitted to make modifications to the child safety seat.
- WARNING!** Use the EVOLVA 1-2-3 SL SICT exclusively for securing your child in your vehicle. It is in no way suitable for use as a seat or toy in the home.
- DANGER!** Never secure your child or the child safety seat with a 2-point belt. If you secure your child in the child seat with only a 2-point belt, this may cause serious injuries to your child in the event of an accident and could even result in their death.



### 3. SAFETY NOTES

**Please take the time to read these instructions carefully and keep them to hand in the intended storage compartment (05) on the child safety seat at all times! The instructions must be kept with the child safety seat if the latter is passed on to a third party.**

- DANGER!** For the protection of your child:  
 In the event of an accident at a collision speed of more than 10 km/h, the child safety seat may be damaged without the damage becoming immediately visible. In this case, the child safety seat must be replaced. Please dispose of it properly.
- Always have your child safety seat checked if you suspect it may have been damaged (e.g. if it falls on the ground).
  - Regularly check all important parts for damage. Ensure that all mechanical parts, in particular, are fully functional.
  - Never lubricate or oil parts of the child seat.
  - Never leave your child unattended in the child seat in the vehicle.
  - Only allow your child to enter and exit the vehicle on the pavement side.
  - Protect the child safety seat from intensive direct sunlight when it is not in use. The child safety seat can get very hot in direct sunshine. Children's skin is sensitive and could be harmed as a result.
  - The more snugly the belt fits over your child's body, the better they will be protected. Avoid putting thick clothes on your child under the belt.
  - Take regular breaks on long journeys in order to give your child the opportunity to run about and play.
  - Use on the rear seat: Move the front seat far enough forwards to ensure that your child's feet cannot hit the backrest of the front seat (to prevent risk of injury).
  - If your child tries to open the red ISOFIT safety button (06) or a buckle, stop the vehicle as soon as it is safe to do so. Check whether the child safety seat is correctly fastened and ensure that your child is correctly secured. Explain to your child the dangers associated with their actions.
- DANGER!** For the protection of all vehicle occupants:  
 In the case of an emergency stop or an accident, unsecured persons or objects may cause injury to other vehicle occupants. Please always check that:
- the backrests of the vehicle seats are locked, e.g. that a foldable rear seat bench latch is engaged.
  - all heavy or sharp-edged objects in the vehicle (e.g. on the parcel shelf) are secured.
  - all persons in the vehicle have their seat belts fastened.
  - the child safety seat is always secured when it is in the vehicle, even if no child is being transported.
- WARNING!** For your protection when handling the child seat:
- Never use the child safety seat free standing, not even for test sitting.
  - To avoid damage, ensure that the child safety seat is not jammed in between hard objects (car door, seat rails, etc.).
  - Keep the child safety seat in a safe place when it is not in use. Do not place any heavy objects on the seat and do not store it directly next to sources of heat or in direct sunlight.

### 4. USE IN THE VEHICLE

Please observe the instructions for using children's restraining systems in the operating instructions of your vehicle. The seat can be used in vehicles with ISOFIX anchoring systems (see type list) and in vehicles with a 3-point belt.  
 To determine which seats are approved for use with child safety seats that meet the requirements for weight classes 9 to 18 kg and 15 to 36 kg, please refer to the operating instructions of your vehicle.

The EVOLVA 1-2-3 SL SICT is approved for two different methods of installation:

Group	Installation method	Means by which child is secured	Section of user instructions
1 (9-18 kg)	Vehicle belt	With 5-point harness	A
1 (9-18 kg)	Vehicle belt + soft latch	With 5-point harness	A
2+3 (15-36 kg)	Vehicle belt	Vehicle belt	B
2+3 (15-36 kg)	Vehicle belt + soft latch	Vehicle belt	B

<sup>a)</sup> This means that the child safety seat may only be used in vehicles that are listed in the enclosed vehicle type list. This type list is consistently kept up to date. The latest version can be obtained from us or from www.britax.com

You can use your child safety seat as follows:

In the direction of travel	Yes
Against the direction of travel	No <sup>1)</sup>
With 2-point harness	No
With 3-point belt <sup>2)</sup>	Yes
with ISOFIX fastening points (between seat surface and backrest)	Yes
On front passenger seat	Yes <sup>3)</sup>
On outer rear seat	Yes
On centre rear seat (with 3-point belt)	Yes <sup>4)</sup>

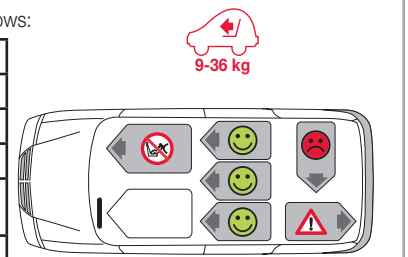

- Use on a rearward-facing vehicle seat (e.g. in a van or minibus) is only permitted if the vehicle seat is also approved for use by adults. The seat may not be in the area of effect of an airbag.
- The safety belt must be approved to ECE R 16 or a comparable standard, e.g. see whether there is an "E" or "e" in a circle on the belt test label.
- If there is a front airbag: Slide the vehicle seat a long way back and refer to any instructions in the vehicle owner's manual.
- Cannot be used if the vehicle seat is equipped with only a 2-point belt.

### 6. CARE AND MAINTENANCE

Please ensure that you only use original BRITAX RÖMER replacement covers, as the seat cover is an integral part of the child safety seat and fulfils important functions to ensure the smooth operation of the system. Replacement covers are available from your dealer.

- The cover can be removed and washed in accordance with the instructions on the wash care label.
  - The plastic parts can be cleaned using soapy water. Do not use any caustic cleaning agents (such as solvents).
- DANGER!** The child seat must not be used without the seat cover.  
**CAUTION!** Never remove the buckle tongues (30) from the straps.

- Removing the cover**
- Adjust the headrest by moving it up (16) (see 9.1).
  - Unhook the edge of the cover and the rubber loops on the back of the headrest (16).
  - Pull off the cover of the headrest (16).
  - Unhook the rubber loops from the retaining screws on the backrest (04).
  - Loosen the shoulder straps (13) (see 9.2).
  - Undo the Velcro fastener on the crotch cushion (21) and remove it.
  - Open the snaps on the left and right-hand sides of the backrest cover (04).
  - Unthread the harness buckle (19) and the adjusting strap (23) from the cover.
  - On the bottom of the seat, unhook the rubber loop of the cover from the retaining screws and cover flaps (24).
  - Working from the side, carefully pull the edge of the cover on the backrest (04) over the SICT (08).
  - Slide the cover with opening over the headrest (16).
- The cover can now be washed in accordance with the instructions on the wash care label.
- Re-fitting the cover**
- Proceed in reverse order to re-fit the cover.
  - WARNING!** Ensure that the straps are not twisted and that they have been correctly inserted in the belt slots on the cover.

### 7. HARNESS BUCKLE CARE

To ensure the safety of your child, it is absolutely essential that the harness buckle continues to function correctly. Harness buckle malfunctions are usually caused by a build-up of soiling or by external objects.

- Possible faults:
- When you press the red release button, it takes a long time for the buckle tongues to be ejected.
  - The buckle tongues no longer engage (i.e. when you try to push them in, they pop out again).
  - The buckle tongues engage without an audible "click".
  - The buckle tongues are difficult to push in (you feel a certain amount of resistance).
- Remedy:** Clean the harness buckle so that it functions properly again:

- Cleaning the harness buckle**
- Remove the harness buckle (19) (see 5.1).
  - Soak the buckle (19) in warm water containing washing-up liquid for at least an hour.
  - Rinse the buckle (19) thoroughly and dry it.
  - Turn the metal plate (27) on end and push it downwards through the belt slot (28) in the cover and through the seat shell.
  - Turn the metal plate (27) 90° and hook the adjusting strap (23) into the metal plate (27) (5.8).
- DANGER!** Tug hard on the harness buckle (19) to make sure that it is secure.
- Push the crotch cushion (21) into the belt slot and use the Velcro fastener to fix it to the harness buckle.

**DISPOSAL:**  
 Please observe the waste disposal regulations in your country.

Disposal of packaging	Container for cardboard boxes
Seat cover	Residual waste, waste incineration
Plastic parts	To be placed in the corresponding container according to labelling
Metal parts	Container for metals
Belt straps	Container for polyester
Buckle and tongue	Residual waste

**9 to 36 kg**  
 (~9 months to 12 years of age)

**britax römer**

## EVOLVA 1-2-3 SL SICT

User instructions



8. PREPARATORY WORK

Before proceeding, please read the section that describes the desired installation method.

Installation methods A2 and B2 only (ISOFIT)



- 1. If your vehicle is not fitted with ISOFIX insertion aids as standard, clamp the two insertion aids 02 (which are included in the scope of delivery of the seat\*) onto the two ISOFIX fastening points 01 of your vehicle with the opening pointing upwards.

Tip! The ISOFIX fastening points are located between the surface and the backrest of the vehicle seat.

\* The insertion aids make it easier to install the child safety seat when using the ISOFIX fastening points and they prevent damage to the car seat covers. If you do not need them, they must be removed from the child safety seat and kept somewhere safe. On vehicles with a fold-down backrest, the insertion aids must be removed before folding down the backrest. Problems are typically caused by soiling or external objects in the insertion aids and on the hook. Remove soiling or external objects to rectify such problems.

Installation method A only (group 1 / 9-18 kg)

- 2.A Make sure that the 5-point harness has been installed correctly (see 5.).
3.A Adjust the headrest 16 of the child safety seat as appropriate for the size of your child (see 8.1).

Installation method B only (groups 2 + 3 / 15-36 kg)

- 2.B Remove the 5-point harness (see 5.).
3.B Adjust the headrest 16 of the child safety seat as appropriate for the size of your child (see 8.2).

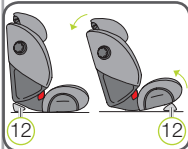

ALL installation methods

4. Adjust the child safety seat to achieve the desired angle of inclination.

For an upright seating position: Move the spacer wedge 12 to the rear position.

For a reclined seating position: Move the spacer wedge 12 to the front position.

Tip! If you find that the vehicle seat belt is too short during the installation process, try using the child safety seat in the upright seating position.

5. Place the child safety seat facing forward (in the direction of travel) on a suitable vehicle seat.

6. If the headrest of the vehicle seat prevents the child safety seat from being fastened in place properly, it should be removed (see the operating instructions of your vehicle).

After removing the headrest, secure it in a suitable place in the vehicle so that it cannot be thrown around.

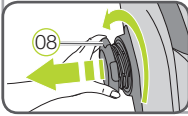

7. Unscrew the SICT 08 anti-clockwise (on the side closer to the vehicle door) until there is a distance of 5 mm between it and the vehicle door or until it has been unscrewed to the maximum.

8.1 Adjusting the headrest (installation with 5-point harness)

A correctly set headrest 16 ensures that the shoulder straps 13 are optimally positioned, and gives your child optimum protection.

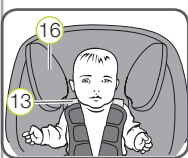

The headrest 16 must be adjusted so that the shoulder straps 13 are at the same level as your child's shoulders.

WARNING! The shoulder straps 13 are not allowed to run behind your child's back, or level with/above their ears.

To adjust the height of the shoulder straps:

- 1. Loosen the 5-point harness of the child safety seat to the maximum possible extent (see 9.1).

Rear of the child safety seat:

- 2. Tilt the shoulder strap adjuster 24 upwards and move it at the same time to set the shoulder straps 13 to the correct height. To lock the shoulder strap adjuster 24 in the ideal position for your child, simply let go of it.

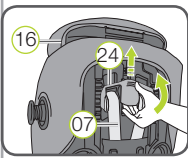

8.2 Adjusting the headrest (3-point seat belt)

A correctly set headrest 16 ensures that the diagonal seat belt section 25 is optimally positioned, and gives your child optimum protection.



The headrest 16 must be adjusted so that there is a space two fingers wide between the headrest 16 and your child's shoulders.

To adjust the height of the headrest to fit your child:

- 1. Move the shoulder strap adjuster 24 to its top position (see 8.1).

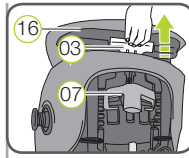

- 2. Remove the 5-point harness (see 5.).
3. Have your child sit down in the child seat.
4. Press the headrest adjuster 03 on the back of the headrest 16.
5. You can now move the unlocked headrest 16 to the desired height. As soon as you release the headrest adjuster 03, the headrest 16 will lock into place.
6. Check the height. If the headrest 16 is still too high even when in the lowest position, you can make an additional adjustment with the shoulder strap adjuster 24 as described in Section 8.1.

9. Installation

CAUTION! To protect your vehicle:

- Certain car seat covers made from more sensitive materials (e.g. velour, leather, etc.) may sustain signs of wear and tear when using child safety seats. For optimum protection of your car seat covers, we recommend using the BRITAX RÖMER car seat protector from our range of accessories.

A1 GROUP 1 (9-18 kg) Installing the seat with the vehicle's 3-point seat belt

The EVOLVA 1-2-3 SL SICT is installed permanently in the vehicle by means of the vehicle's 3-point seat belt. Your child is then buckled in using the 5-point harness of the child safety seat.

- 1. Carry out the steps in Section "8. PREPARATORY WORK".
2. Go to Section A2 and follow the steps relating to the vehicle's 3-point seat belt.
3. Give the child safety seat a firm pull forwards to ensure that it is securely fastened.
4. Secure your child as described in Section "9.1 Buckling in your child using the 5-point harness".
5. Carry out the steps in Section "9.3 Checklist".

A2 GROUP 1 (9-18 kg) Installing the seat with ISOFIT and the vehicle's 3-point seat belt

The EVOLVA 1-2-3 SL SICT is installed permanently in the vehicle by means of the ISOFIT system and the vehicle's 3-point seat belt. Your child is then buckled in using the 5-point harness of the child safety seat.

- 1. Carry out the steps in Section "8. PREPARATORY WORK".
2. ISOFIT 1/3
2.1 Open the cover flap that is furthest from the vehicle door 09.
2.2 Hold the ISOFIT adjustment button 10 down and fully extend the ISOFIT locking arm furthest from the vehicle door 07.
2.3 Press the red ISOFIT locking button 06 to ensure that the hook on the ISOFIT locking arm 07 is open and ready for use.
2.4 Push the ISOFIT locking arm 07 into the insertion aid 02 until the ISOFIT locking arm 07 engages with a clicking sound.
2.5 Open the cover flap that is closest to the vehicle door 09.
2.6 Hold the ISOFIT adjustment button 10 down and fully extend the ISOFIT locking arm closest to the vehicle door 07.
2.7 Press the red ISOFIT locking button 06 to ensure that the hook on the ISOFIT locking arm 07 is open and ready for use.
2.8 Push the ISOFIT locking arm 07 into the insertion aid 02 until the ISOFIT locking arm 07 engages with a clicking sound.

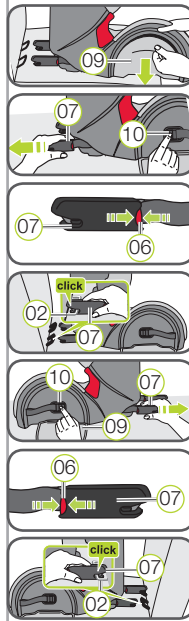

- DANGER! Check that the ISOFIT locking arm 07 is correctly engaged by pulling on it.
3. Vehicle's 3-point seat belt
3.1 Place the diagonal seat belt section 25 between the headrest 16 and the backrest 04 of the child safety seat. Ensure that the belt is not twisted.
3.2 Place the lap belt section 26 in the light red belt guide 20.
3.3 Combine around 80 cm of the diagonal seat belt section 25 and the lap belt section 26.

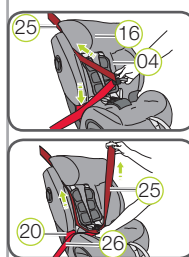

- 3.4 Turn the child safety seat away from the vehicle seat slightly.
3.5 Guide the vehicle seat belt through the first feed-through point 15 of the backrest 04 from the front.
3.6 Guide the vehicle seat belt back through the second feed-through point 15 from the back to the front and engage the buckle tongue in the vehicle seat belt buckle 34 so that it makes an audible clicking sound.
3.7 Place the diagonal seat belt section 25 and lap belt section 26 on the side of the vehicle seat belt buckle into the light red belt guide 20 on the vehicle seat belt buckle 34.
3.8 Using one knee, press down hard on the child safety seat. At the same time, firmly tug the diagonal seat belt section 25 at the bottom (where it connects to the vehicle seat belt buckle) to pull it up.
3.9 Hold the diagonal seat belt section firmly at the bottom, and pull the diagonal seat belt section 25 forwards above the feed-through point 15. Take your weight off the child safety seat and pull the diagonal seat belt section 25 to tighten it up again.
4. ISOFIT 2/3
4.1 Firmly pull the ISOFIT adjusting straps 29 on the left and right one after the other while at the same time pushing the child safety seat backwards.
4.2 Store the ISOFIT adjusting straps 29 in the openings on both sides that are intended for this purpose and then close the cover flaps 24 again on both sides.
5. ISOFIT 3/3 and the vehicle's 3-point seat belt
Give the child safety seat a firm pull forwards to ensure that it is securely fastened and check the ISOFIT locking arms 07 again to ensure that both are fully locked in place.

9.1 Buckling in your child using the 5-point seat belt
The more snugly the belt fits over your child's body, the better they will be protected. Therefore, avoid putting thick clothes on your child under the belt.

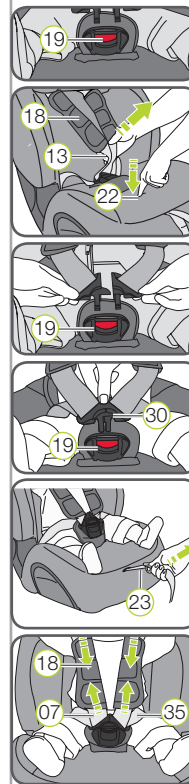

- 1. Open the harness buckle 19 (press the red release button).
2. Press the adjustment button 22 while at the same time pulling both shoulder straps 13 below the shoulder pads 18 forwards.
3. Have your child sit down in the child seat.
4. Check that the headrest 16 has been set correctly and adjust it if necessary [see 8.1].
5. Ensure that your child's back is lying flat against the backrest of the child safety seat.
6. Bring the two buckle tongues 30 together and connect them to each other before inserting them into the harness buckle 19 (there should be an audible clicking sound).
7. Pull the shoulder straps 13 to tighten the lap belt section and make sure that the harness is lying flat.
8. Pull the adjusting strap 23 until there is an audible clicking sound.
9. Give the adjusting strap 23 another pull until there is an audible clicking sound to indicate that the harness has been tightened sufficiently.

B1 GROUP 2-3 (15-36 kg) Installing the seat with the vehicle's 3-point seat belt

The EVOLVA 1-2-3 SL SICT is not installed permanently in the vehicle. It is simply secured together with your child using the vehicle's 3-point seat belt.

- 1. Carry out the steps in Section "8. PREPARATORY WORK". Ensure that the backrest 04 is flush with the backrest of the vehicle seat.
2. Carry out the steps in Section "9.2 Buckling in your child using the 3-point seat belt".

B2 GROUP 2-3 (15-36 kg) Installing the seat with ISOFIT and the vehicle's 3-point seat belt

The EVOLVA 1-2-3 SL SICT is installed permanently in the vehicle by means of the ISOFIT system. Your child is then buckled into the seat using the vehicle's 3-point seat belt.

- 1. Carry out the steps in Section "8. PREPARATORY WORK".
2. Go to Section A2 and follow the ISOFIT steps described there.
3. Give the child safety seat a firm pull forwards to ensure that it is securely fastened and check the ISOFIT locking arms 07 again to ensure that both are fully locked in place.
4. Follow the steps in Sections 9.2 and 9.3.

9.2 Buckling in your child using the 3-point seat belt

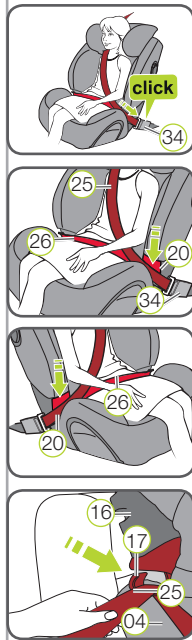

- 1. Have your child sit down in the child seat.
2. Pull out the vehicle belt and guide it in front of your child to the vehicle seat belt buckle 34.
3. Engage the buckle tongue in the vehicle seat belt buckle 34 so that it makes an audible clicking sound.
4. Place the diagonal seat belt section 25 and lap belt section 26 on the side of the vehicle seat belt buckle 34 into the light red belt guide 20 of the child safety seat.
5. Also place the lap belt section 26 on the other side of the seat cushion in the light red belt guide 20.
6. Guide the diagonal seat belt section 25 into the dark red belt holder 17 of the headrest 16 until it lies completely inside the belt holder 17 and is not twisted.
7. Make sure that the diagonal belt 25 runs over your child's shoulder, and not in front of his or her neck.
8. Tighten the vehicle seat belt by pulling on the diagonal seat belt section 25.

9.3 Checklist
For the safety of your child, before every journey in the car check that...
the child safety seat is securely fastened,
the straps are tight and not twisted,
the SICT 08 is being used correctly,
the headrest 16 has been correctly adjusted for the size of your child.

Installation method A only (group 1)
the diagonal seat belt section 25 runs between the headrest 16 and the backrest 04,
the straps of the child safety seat are close to the body without constricting the child,
the buckle tongues 30 are engaged in the harness buckle 19,
the shoulder pads 18 are in the right position on your child's body.

Installation method B only (groups 2+3)
the diagonal seat belt section 25 runs through the dark red belt holder 17 of the headrest 16,
the lap belt 26 runs in the bright red belt guides on both sides of the seat cushion 20,
the diagonal seat belt section 25 on the side of the vehicle seat belt buckle 34 also runs through the light red belt guide 20 of the child safety seat,
the diagonal seat belt section 25 runs diagonally backwards,
the vehicle seat belt buckle 34 is not positioned in the bright red belt guide 20 in the seat cushion.

Installation methods A2 and B2 only (ISOFIT)
the child safety seat is slotted in on both sides with the ISOFIT locking arms 07 in the ISOFIT fastening points 01.