

# 1 ASSEMBLY

Unpack the lawnmower ensuring all parts are present (see parts list overleaf) before discarding the packaging.

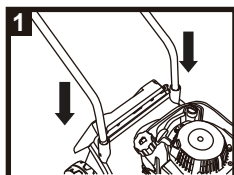

Insert lower handle into the sockets in the deck and push down firmly until fully seated. Fix with screws provided.

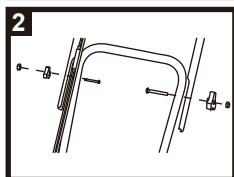

Locate upper handle bar on lower with the bolts. Secure the left bolt using plastic tightening knob ensuring cables are not twisted.

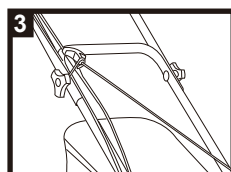

Locate the rope guide over the right hand bolt so the 90° bend sits on top of the handle bar and secure using the plastic knob.

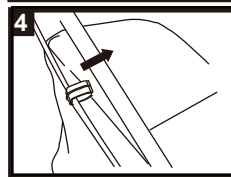

Using the cable clamp provided, secure the cables to the handle without trapping them.

# 3 COLD ENGINE STARTING

Fill the petrol tank with 0.9L of normal 95 Octane petrol (standard unleaded) using a funnel and measuring jug.

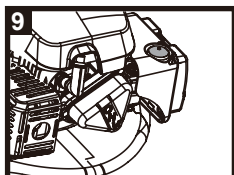

When starting a cold engine, press down the primer fully 3~5 times. When starting a warm engine, the primer does not need to be used.

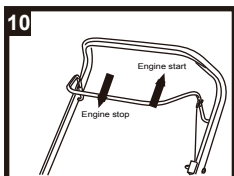

Hold the stop/start bar firmly to the handle to disengage the motor brake and automatic cut out.

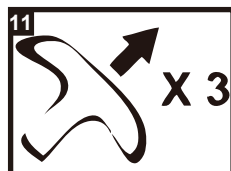

To start the engine slowly pull the start cord out until resistance is felt (approx 10-15cm) then start the engine with a sharp vigorous pull.

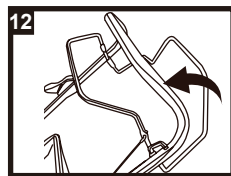

Engage the propulsion lever, the mower will drive ahead automatically.

To stop the mower release the stop/start bar.

# 2 PREPARING YOUR MOWER

Follow these steps to ensure quick and easy set up every time.

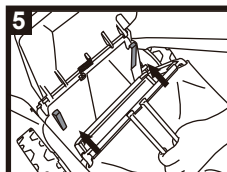

Lift the flap and hook the grass bag over the plastic hooks on the rear of the mower.

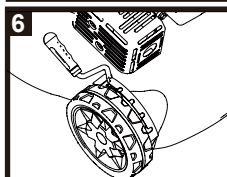

Adjust the cutting height lever located on the front right wheel.

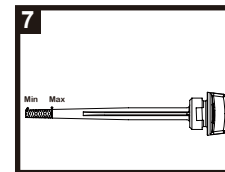

The engine does not come with oil. Add a minimum of 0.4 litres of oil. (SAE30 or 4-stroke oil) CHECK THE ENGINE OIL BEFORE EVERY USE.

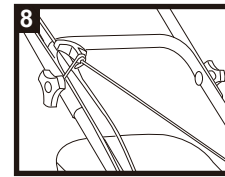

Slowly pull out starter cord & hook it through the eye of rope guide. This is where you start the mower from.

# IMPORTANT INFORMATION!

Always read the instruction manual thoroughly before starting the lawnmower.



In cold weather it may be necessary to repeat the cold engine starting process.



Never allow the starter cord to snap back.



Check the oil level before every use. Always use high quality detergent oil classified SAE30 oil (or equivalent eg 5W 30, often termed as 4 Stroke lawn mower oil).

If you have any difficulties please contact the

helpline on 01904 727508 email [support@coreservice.co.uk](mailto:support@coreservice.co.uk)

or visit [www.coreservie.co.uk](http://www.coreservie.co.uk)

## 40cm Petrol Self Propelled Lawnmower

# ***challenge***<sup>®</sup>

## **QUICK START GUIDE**

**ALWAYS READ THE  
INSTRUCTION MANUAL AND  
SAFETY WARNINGS THOROUGHLY  
BEFORE USE.**

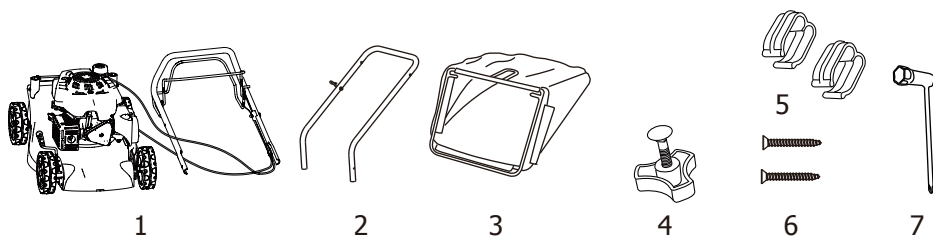
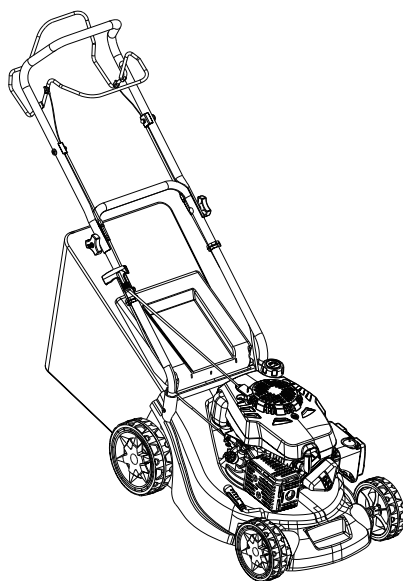

1. Mower
2. Lower handle
3. Grass collection bag
4. Handle fixing knob & square neck bolt 2 sets
5. Cable clip 2pcs
6. Self-tapping screw 2pcs
7. Spark plug spanner & Philips screwdriver 1pc

For technical advice, spare parts and service support 7 days a week please call:

**01904 727508**

**Mon-Fri: 9am-5pm  
Sat-Sun: 11am-4pm**

Email: [support@coreservice.co.uk](mailto:support@coreservice.co.uk)

Website: [www.coreservice.co.uk](http://www.coreservice.co.uk)