

Components

(A) 1XSeat Cushion

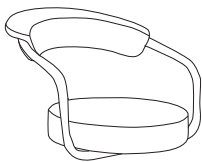

(B) 1XSeat support

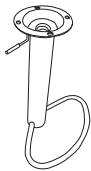

(C) 1Xbase

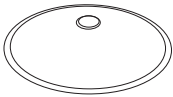

(D) 1XGas lift



(E) 1XCover



EXECUTIVE BAR STOOL WITH BACK REST

Simple Assembly Instructions - please keep for future reference

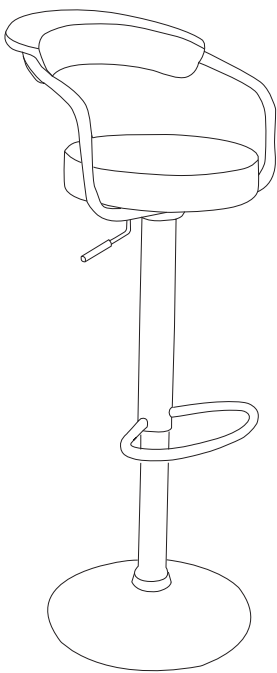

IMPORTANT

- 1.Read these instructions carefully and familiarise yourself with the procedure before assembling the unit.

2.Check that you have all the component parts following the list on the back cover and familiarise yourself with each part before proceedi.
- 3.Take all the fittings out of the plastic bag and separate them into their groups.

4.Ensure you have enough space to lay out all the pares before assembly.

5.To avoid scrathching it is recommended that you assemble the unit on a soft level surface.

Fittings

(A) 4XBolt

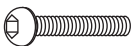

(B) 1XTool



Assembly Instructions

NOTE: It would be useful to ask some one to help you at this stage.

1. Use Bolts (A) to fix the seat cushion.(A)
See fig.1

2. Insert the Gas lift (D) into the Base (C).
Then slide the Cover (E) over the top.

carefully locate the Seat Cushion onto the base unit.

See fig.2

NOTE: Ensure the Gas lift is fully inserted and well fitted.

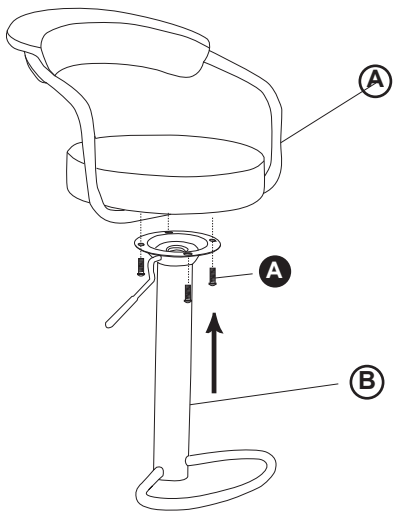

fig.1

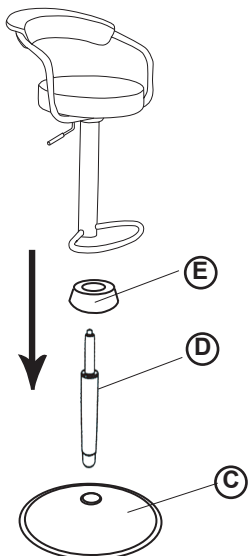
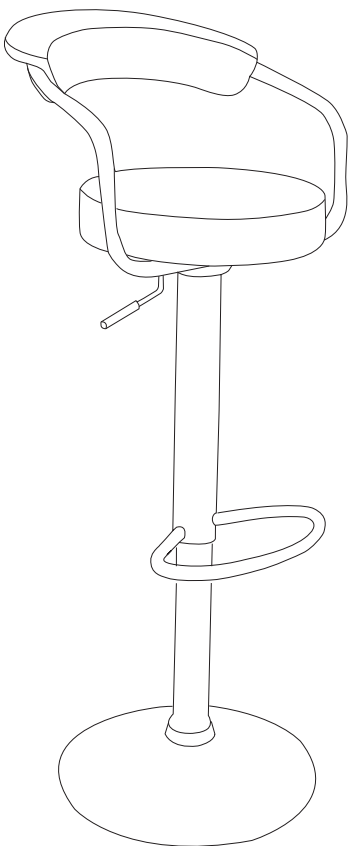

fig.2

Assembly Instructions

WARNING:

Do not stand on this product.Do not use this product as a step ladder.
Use this product only for seating one person at a time.
Do not use this product unless all bolts, screws and knobs are firmly secured.
At least every 4 months,check all bolts, screws and knobs, to be sure they are tight.
If parts are missing, broken or damaged or worn,stop use of this product until repairs are made & using factory authorized parts.
Failure to follow these warnings could result in serious injury.



Care and Maintenance

Safety
To avoid any risk of suffocation to animals children dispose or the plastic bags immediately.

cleaning
As with all surfaces clean with a damp cloth and mild detergent,do not use bleach or abrasive products.

Fitting
Form time to time please ensure there are no loose screws on the product.