



# INSTRUCTIONS

## Retractable Gate

**F820N (white)**  
**F943N (black)**

Patent No. 1/604,922

### IMPORTANT! READ AND FOLLOW THESE INSTRUCTIONS CAREFULLY AND KEEP FOR FUTURE REFERENCE

Read the entire instructions before assembling and installing this product.  
If you sell or give away this product, make sure you give this instruction to the new owner.

## WARNING

**WARNING**– Incorrect installation can be dangerous.

**WARNING**– Do not use the safety barrier if any components are damaged or missing.  
**WARNING**– The safety barrier must not be fitted across windows.

**WARNING**– Never use this gate without securely installed Locking Brackets and Locking Hooks.

This safety barrier conforms to EN1930:2011;

This safety gate is for domestic use only;  
This safety gate has been designed for use with children up to 24 months of age;  
Never use with a child able to climb over or dislodge/open the gate;  
The surfaces that the gate is to be fixed to must be suitable for the purpose and must be structurally sound;



**WARNING:** This package contains small parts and sharp points in an unassembled state. Keep out of reach of children. Adult assembly required.

The clearance space between the Base of Casing and the floor MUST NOT exceed 0.3cm (0.12in);

If the safety gate is used at the bottom of stairs to prevent the child climbing up the stairs, it must be placed at the front of the lowest stair;

If the safety gate is used at the top of the stairs to prevent child falling down the stairs, it must not be placed on any stair below the level of the top stair;

At the top of landing, position the gate 15cm (6in) away from the top step;  
This safety gate has a manual close system;  
This safety gate must NEVER be used as a pool or pond barrier;  
Never leave a child unattended.  
This safety gate does not replace proper adult supervision.

## PARTS LIST

- Included**
- A** Gate Panel
  - B** Cover
  - C** Upper Bracket (x2)
  - D** Lower Bracket (x2)
  - E** Upper Hook (x2)
  - F** Lower Hook (x2)
  - G** Locking Rod
  - H** Screws 4x25mm (5/32 x 1in) (x16)
  - I** Masonry/Brick Plugs (x16)
  - J** Templates (x2)
- Includes 2 sets of mounting brackets for convenient 'clip-on/clip-off' relocation

- Pre-assembled**
- K** Base of Casing
  - L** Top of Casing
  - M** Release Button

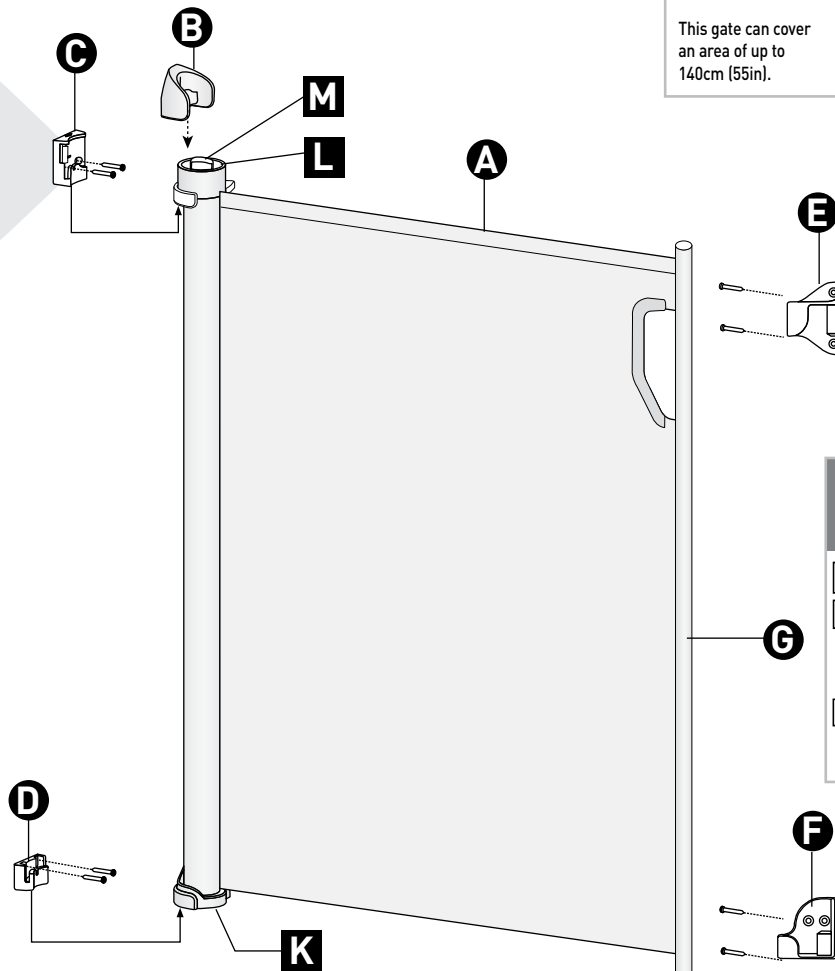
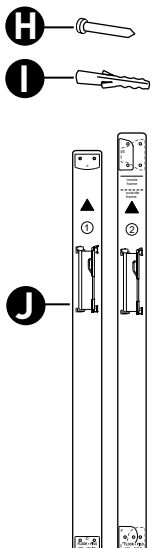
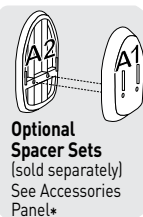

### Before you start

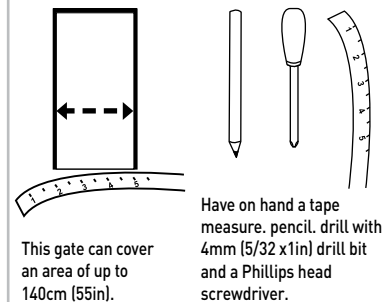

### Optional \*Accessories (sold separately)

**F821N** Spacer Sets (white)

**F944N** Spacer Sets (black)

For use when gate is fitted to Skirting boards / Baseboards

**F895** Gate Adaptor Panel

To provide a flat surface to install gate.

## 1. Choose best location for gate



Ensure the surface you are mount the gate is structurally sound such as solid timber, brick or masonry. For plaster/gyprock surface, locate the timber beam or stud behind and mount in this location (mounting on plaster/gyprock alone is not strong enough and not safe). Do not mount to glass.

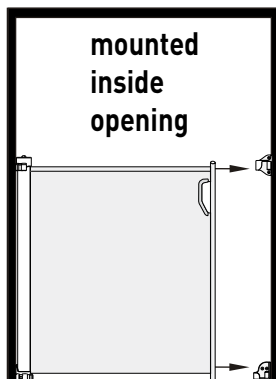

MAX - 140cm/55in

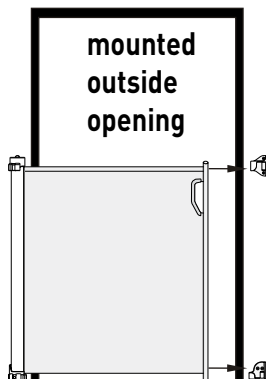

MAX - 130cm/51in

**1a.** Gate can be installed outside or inside door openings

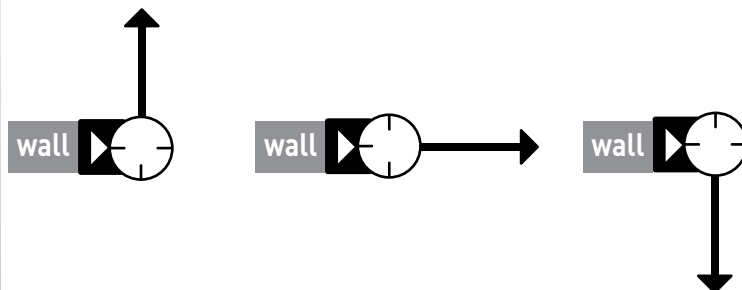

**1b.** Opening direction of the gate can be changed to suit



### Bottom of stairs

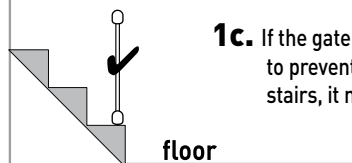

**1c.** If the gate is used at the bottom of the stairs to prevent the child from climbing up the stairs, it must be placed on the lowest stair.



### Top of stairs

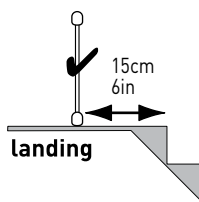

**1d.** If the gate is to be used at the top of the stairs to prevent the child from falling down the stairs, it must not be placed on any stair below the level of the top stair.  
At the top of landing, position the gate 15cm (6in) away from the top step.

### Top view of gate



**1e.** Make sure that the gate is mounted firmly and evenly in vertical position.

### Side view of gate

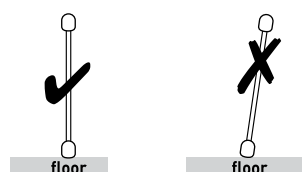

## Accessories (sold separately)

### 1f. Skirting boards (baseboards)

If there is a skirting board (baseboard) to which the Retractable Gate is to be attached, build up the wall areas equivalent to thickness of baseboard (skirting board) with Spacers F821N/F944N (sold separately).

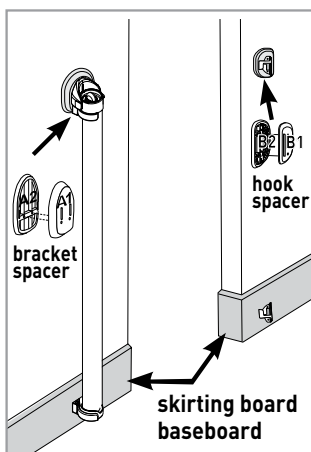

For 1.25cm (1/2in) skirting or baseboards use:

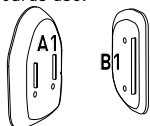

For 1.90cm (3/4in) skirting or baseboards use:

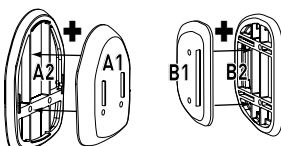

**F821N** Spacer Set (white)

**F944N** Spacer Set (black)

**A1** Bracket Spacer - 1.25cm (1/2in)

**B1** Hook Spacer - 1.25cm (1/2in)

**A1+A2** Bracket Spacer - 1.90cm (3/4in)

**B1+B2** Hook Spacer - 1.90cm (3/4in)

### 1g. Adaptor Panel

To provide a flat surface to install gate.

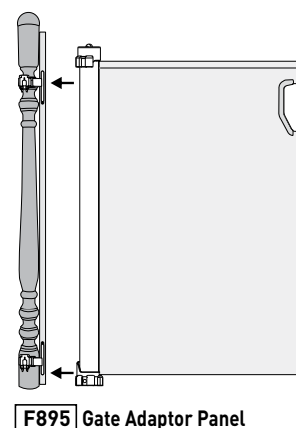

## 2. Mark position of wall Hooks and Brackets

Template 1 = Brackets (C, D).

Template 2 = Hooks (E, F).

- Locate the frame/stud and overlay Bracket Template ①.
- Keep the Template vertical and place the lower edge of Template on the floor.
- Repeat step with Template ② on other side of opening.
- Mark the position of the upper and lower holes with a pencil.

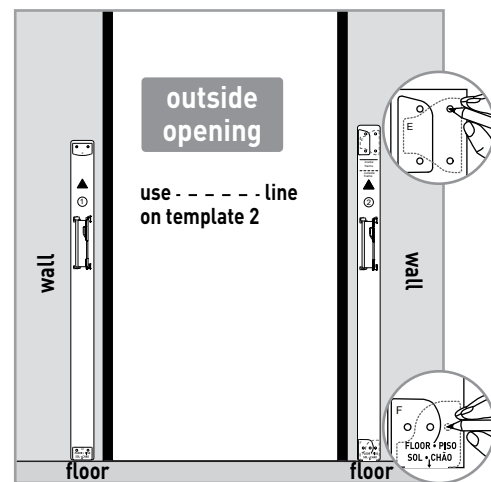
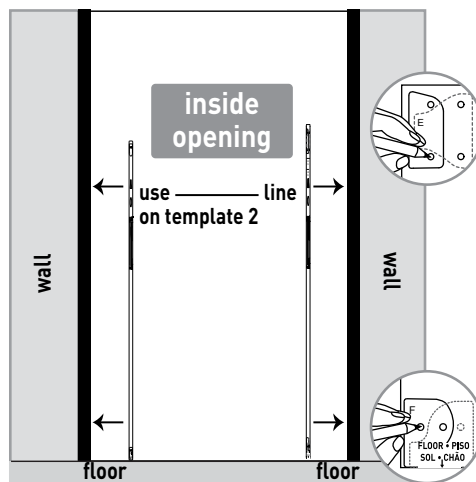
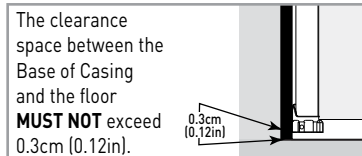

## 3. Screw the upper and lower Brackets and Hooks (C, D, E, F) into wall or door frame using screws (H)

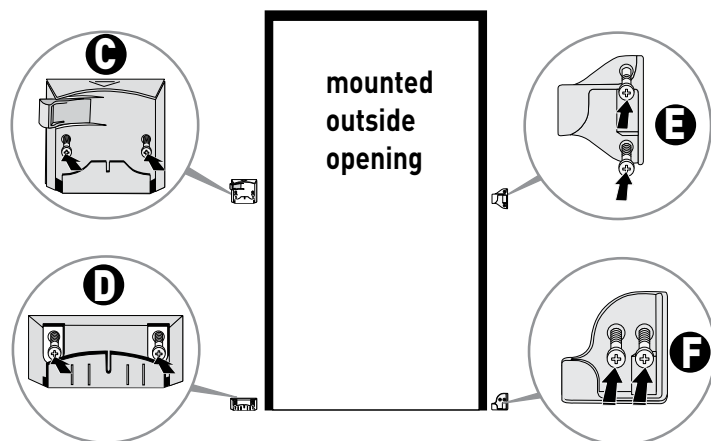
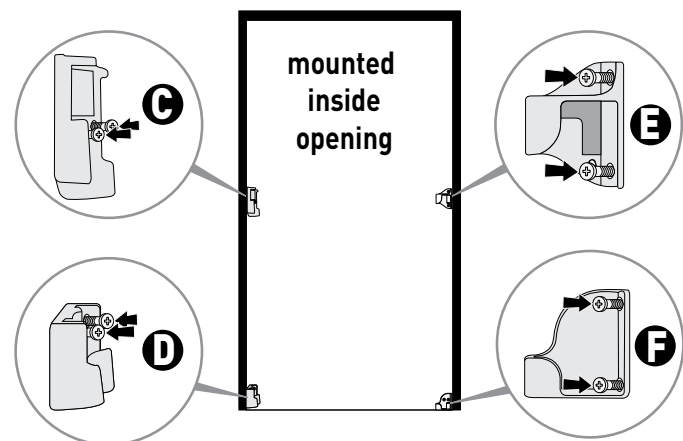

## 4. To mount gate

**4a** Checked the direction you want the gate to open / close.

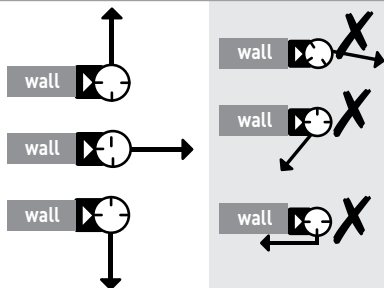

**4b** Align the notch on Top of Casing (L) with the arrow on the Upper Bracket (C) in desired open / close direction.

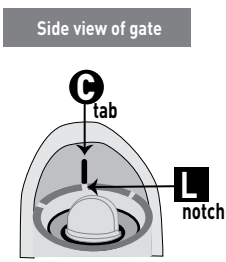
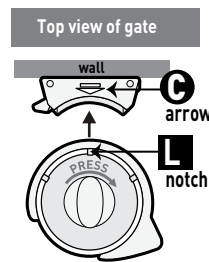

**4c** Align the lower part of gate to Lower Bracket (D) and top of gate to Upper Bracket (C). Push down gently to click into place.

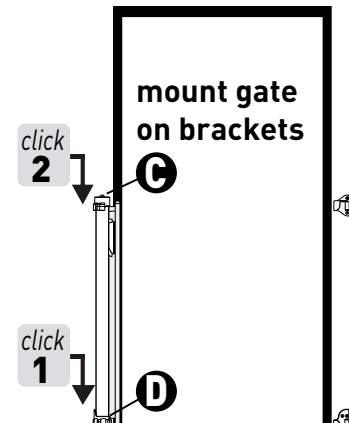

**4d** Slide Cover (B) over Upper Bracket (C) until it covers dismount Latch.

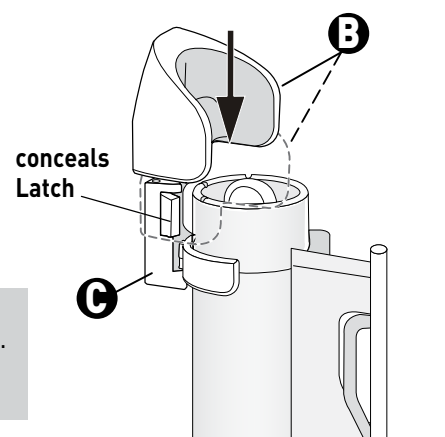

**!** The Cover locks the gate in place. It must be securely installed at all times.

## To close the gate:

Press Release Button and twist clock-wise, then pull the gate handle and without stopping fit Locking Rod (G) into Lower and Upper Hooks (E, F).

## To open gate:

Press Release Button and twist clock-wise then pull the gate handle out from Lower and Upper Hooks (E, F).

**NOTE:** The noise you hear while the gate retracts is designed to alert you, letting you know that the gate is being opened.

For silent operation, hold Release Button down when retracting gate.

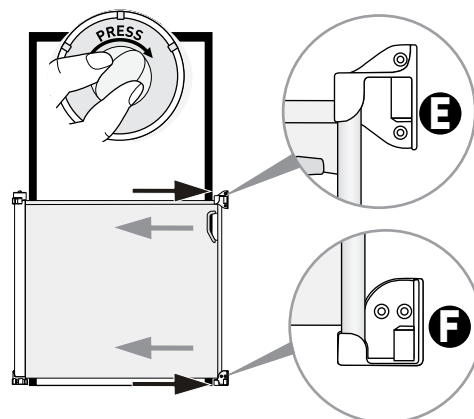

# TO REMOVE

Slide Cover (B) from Top of Casing (L).

Press dismount Latch on Upper Bracket (C) and slide gate up.

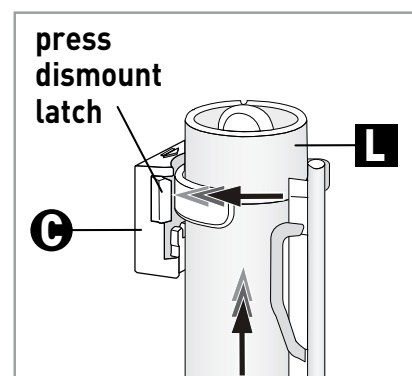
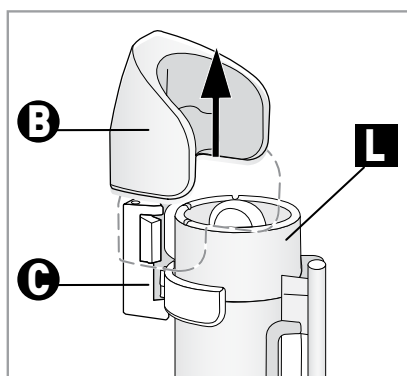

# COMPOSITION

The plastic parts are made of fibreglass-armed polyamide, Polypropylene and Polyester.

Plastic parts: Nylon & Polyoxymethylene (POM) materials.

Mesh fabric made of 40% polyester and 60% non-toxic PVC coating.

Other components are made of steel and aluminium.

The materials are used for their durability and resistance.

Spacers made of ABS (Acrylonitrile Butadiene Styrene).

# MAINTENANCE & CARE

- Gate must be fitted according to instructions, to ensure it works correctly.
- Regularly check gate to ensure it is fitted properly and securely. Adjust as required.
- Regularly check that brackets and hooks are securely in place.
- If gate is used outdoors, bring inside and keep out of rain, hail, snow or below freezing conditions.
- Do not use the safety gate if any components are damaged or missing.
- To clean, wipe surface with a damp cloth or sponge using mild detergent and warm water. Never clean with abrasive, ammonia based bleach based or spirit type cleaners.
- Any additional and replacement parts should be obtained from Tee-Zed Products.

# CONTACT DETAILS

Tee-Zed acknowledges that its customers may be entitled to statutory consumer guarantees and does not seek to exclude or limit them. These guarantees include that Tee-Zed's products are of acceptable quality. This Tee-Zed product is for the specific purpose detailed in the instructions and packaging and Tee-Zed considers use outside of that purpose to be abnormal use. To the maximum extent permitted by law, Tee-Zed does not accept any liability for damage:

- arising from abnormal use of the products;
- caused by installation or removal of the products other than in accordance with the supplied installation and removal instructions; or
- arising under the law of tort or contract.

Tee-Zed Products Pty Ltd  
PO Box 2022, Bondi Junction NSW 1355  
**Australia** Tel: +61 (0)2 9386 4000  
info@tee-zed.com.au

Tee-Zed Products (N.Z.) Ltd  
PO Box 64013, Botany Town Centre, Auckland  
**New Zealand** Tel: +64 (0)9 274 8788  
info@tee-zed.co.nz

Tee-Zed Products Ltd  
PO Box 29227, Dunfermline, KY12 2DN  
**United Kingdom** Tel: +44 (0)844 800 9445  
info@tee-zed.co.uk

[www.dreambaby.com.au](http://www.dreambaby.com.au)  
[www.dream-baby.co.nz](http://www.dream-baby.co.nz)  
[www.dreambaby.co.uk](http://www.dreambaby.co.uk)

[www.youtube.com/dreambabytv](https://www.youtube.com/dreambabytv)  
[www.facebook.com/dreambabysafety](https://www.facebook.com/dreambabysafety)  
[www.twitter.com/dreambabysafety](https://www.twitter.com/dreambabysafety)



Dreambaby® products by **Tee-Zed**

Made in Dongguan, China.

