

BELIZE TABLE LAMP INSTRUCTIONS

Please read these instructions carefully prior to installation and retain them for future reference.

This product is for indoor use only.



WASTE ELECTRICAL PRODUCTS SHOULD NOT BE DISPOSED OF WITH HOUSEHOLD WASTE. PLEASE RECYCLE WHERE FACILITIES EXIST. CHECK WITH YOUR LOCAL AUTHORITY FOR RECYCLING ADVICE.

SAFETY

This product is supplied complete with a 13-amp plug with 3-amp fuse. Our products should not be modified. If any modification is made, including tampering with the plug, it will invalidate the warranty and may render the product unsafe.

If the flexible cable on this fitting is damaged then it cannot be replaced and the fitting must be destroyed.

☐ **This fitting is double insulated and must not be earthed. If in doubt, we recommend you consult a qualified electrician.**

ASSEMBLY

1. Carefully remove all parts from their packaging.
2. Fit the recommended bulb(included): **3x Max. 10W 12V G4 BI PIN HALOGEN CAPSULE BULBS (SELF SHIELDED).**

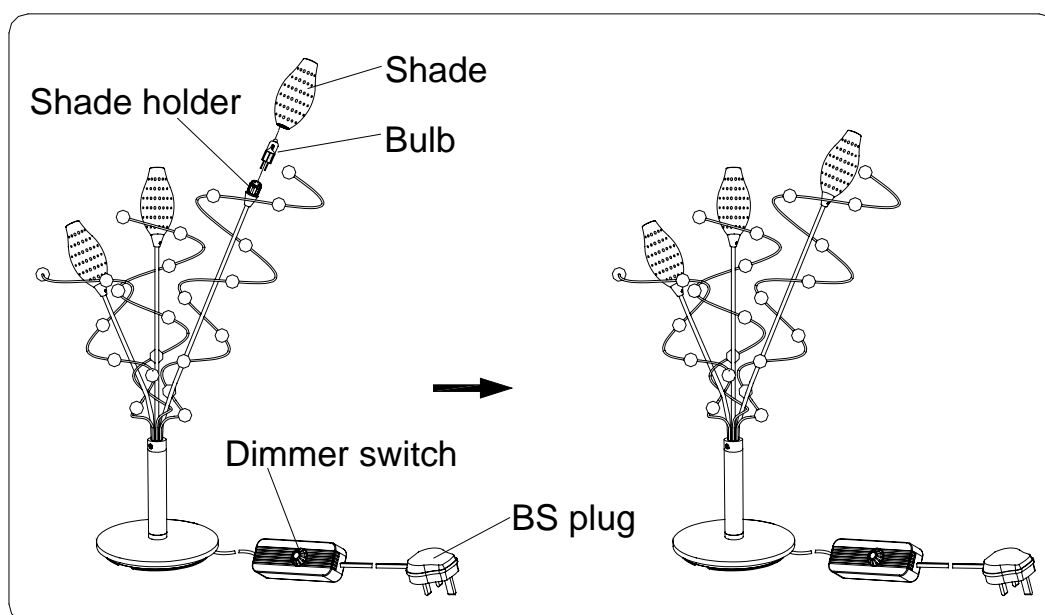

3. Fit the shade to the shade holder at the lampholder.
4. Installation is now complete, plug to test. The lamp is turned on/off and adjusted the brightness using the dimmer switch.
5. If the product fails to light, unplug before investigating.

BULB REPLACEMENT

1. Switch off the mains power supply.
2. Before replacing the bulb, allow it to cool down for at least 10 minutes.
3. Never touch the bulb with your fingers directly, cover it with a cloth.
4. Remove the shade from the lampholder by pulling out .
5. Loosen the bulb and remove it from the lamp.
6. Replace a new bulb with same voltage and wattage.
7. Replace the glass shade.



Model No. :GYTL2989

Input Voltage: 230-240V~50Hz

Max. Wattage: 30W

Bulb: **3x Max. 10W 12V G4 BI PIN HALOGEN CAPSULE BULBS (SELF SHIELDED).**

Argos Limited, Avebury, 489-499 Avebury Boulevard, Saxon Gate West, Central Milton Keynes, MK9 2NW.

10/4/07

