

COOKWORKS

ELECTRIC KNIFE

INSTRUCTION MANUAL



Safety Warnings

1. Please read these instructions carefully before using the appliance for the first time.
2. Before you connect the appliance to the mains supply, make sure that the voltage indicated on the rating plate, matches the mains voltage in your home. If it does not, contact your dealer and do not use the appliance.
3. Prevent children from pulling on the mains cord.
4. To protect against risk of electrical shock, do not put the housing in water or other liquid. Do not operate knife in water or under running water.
5. Close supervision is necessary when any appliance is used by or near children.
6. Unplug from outlet when not in use, before putting on or taking off parts, and before cleaning. Disconnect when changing blades.
7. Avoid contacting moving parts.
8. Do not operate after the appliance malfunctions, or is dropped or damaged in any manner. Repairs to electrical appliance should only be performed by a qualified electrician. Improper repairs may place the user at serious risk. Return appliance to its authorized service facility for examination, repair or electrical or mechanical adjustment.
9. The use of attachments not recommended or sold by the manufacturer may cause fire, electric shock or injury.
10. Do not let cord hang over edge of table or counter.
11. Blade are sharp. Handle carefully. Always handle blades with hand away from cutting edge. Use the spatula to extricate food. Always store blades with cutting edge away from you.
12. Do not contact any moving parts while the appliance is operating.
13. Make sure that the motor and blades have completely stopped before removing blades from housing.
14. The appliance is for household use only. Do not use outdoors.
15. Do not plug in the mains before the blades have been inserted.
16. Before cleaning the appliance disconnect from the power supply.
17. If the supply cord is damaged, it must be replaced by the manufacturer, its service agent or similarly qualified persons in order to avoid a hazard.
18. This appliance is not intended for use by persons (including children) with reduced physical, sensory or mental capabilities, or lack of experience and knowledge, unless they have been given supervision or instruction concerning use of the appliances by a person responsible for their safety.
19. Children should be supervised to ensure that they do not play with the appliance.

20. This appliance can be used by children aged from 8 years and above and persons with reduced physical, sensory or mental capabilities or lack of experience and knowledge if they have been given supervision or instruction concerning use of the appliance in a safe way and understand the hazards involved. Children shall not play with the appliance. Cleaning and user maintenance shall not be made by children without supervision.
21. Always disconnect the appliance from the supply if it is left unattended and before assembling, disassembling or cleaning.
22. This appliance shall not be used by children. Keep the appliance and its cord out of reach of children.

Know you appliance

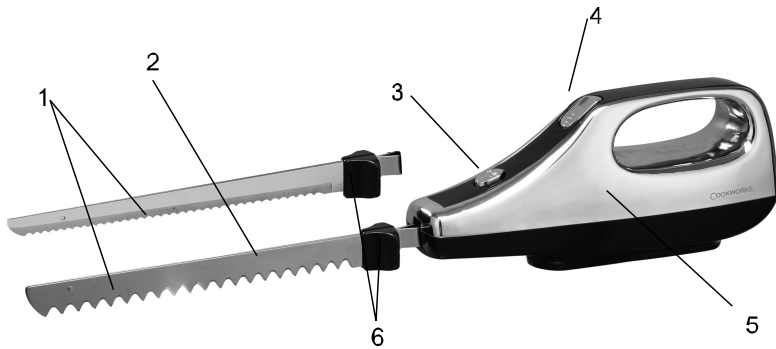

- 1. Stainless Steel Blades
- 2. Blades for frozen food
- 3. Blade lock release buttons

- 4. On / Off switch
- 5. Main unit
- 6. Safety Guard

Operation instruction

BEFORE FIRST USE

Blades are sharp. Always handle with care and the sharp edges away from hand and body.

Wash the blades in warm, soapy water, then dry thoroughly.

ASSEMBLING BLADES

- Hold the blade ends by safety guards and slip the rivet on the key hole of the other blade.
- Slide blades together lightly ensuring tips are interlocked.

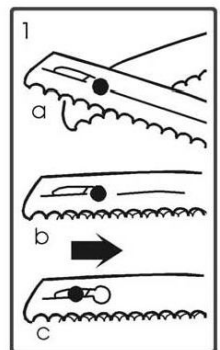

INSERTING BLADES

- Hold Assembled blades by the safety guards and insert the blades into the blade slot pushing until both blades are locked into position – an clear “click” sound will be heard.



REMOVING BLADES

- Depress the blade release buttons with one hand, at the same time pulling the blades off with the safety guards with the other hand.



HOW TO USE

- Assemble the blades together before inserting into the appliance.
- Connect to the mains and ensure the cord is clear from the blades.
- Make sure the blades are fixed securely.
- Holding the appliance with handle, then turn the On/Off switch to ON position. The blades will start to move for slicing.
- To turn the unit off, release the On/Off switch. It will return to the Off position and the blades will stop moving immediately.
- When the cutting is finished, disconnect the unit from the mains.

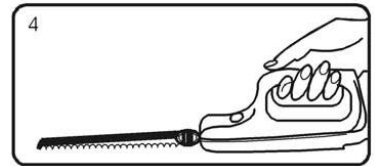

WARNING : Avoid contact the moving parts. Keeps hands, hair and clothing away from moving blades during the operation to avoid any hazard.

WARNING : Use the special blade(2) for frozen food. Never try to slice the bones. The knives are not designed to perform such operation.

NOTE : DO NOT OPERATE THIS APPLIANCE LONGER THAN 15 MINUTE AT ONE TIME. STOP AND COOL FOR 3 MINUTES THEN RESUME.

SLICING HINTS

- Always place food to be sliced on a wooden or plastic cutting board. Do not slice food on glass, metal or bench tops as scratching may occur.
- Guide blades through food. A sawing action is not necessary. Do not force blades through food.
- To maintain sharpness of blades, do not cut through bones, fruit pips, stones or any other hard substances.

- For best results when carving meat and poultry, allow cooked meat to stand for at least 10 minutes before slicing. This allows the juices to set and make carving easier and neater.
- Before carving meat or chicken, remove any skewers. If desired, string may be left around the meat while carving.
- A carving fork is recommended to use for steadying the meat and assists in carving during slicing.
- Do not attempt to sharpen blades.

Cleaning and Maintenance

- The blades is not required any regrinding as the blades always remain sharp due to the constant two-way friction.
- There is no service part inside the unit. No lubrication is needed.
- Disconnect it from the mains before cleaning.
- Dismantle the blades and wash them with hot soapy water.
- Clean the housing with damp cloth. Do not use abrasive cleaning materials.
- Do not immerse the appliance in the water or other liquid.
- Dry it through before storing or next operation.

Connection to Power

- Before connecting, check that the voltage indicated on the appliance corresponds with the main voltage in your home. If this is not the case, consult your dealer and do not use.
- This appliance may be fitted with a non-rewirable plug. If you need to change the fuse in a non-rewirable plug, the fuse cover must be refitted. If the fuse cover is lost or damaged, the plug must not be used until a replacement is obtained (available from the appliance manufacturer).
- If the plug has to be changed because it is not suitable for your socket, or becomes damaged, it should be cut off and appropriate plug fitted following the wiring instructions. The plug removed must be disposed of safely as insertion into a mains socket is likely to cause an electrical hazard.
- This equipment must be disconnected from the mains when not in use. Do not allow this unit to be exposed to rain or moisture.

For your own safety read the following instructions carefully before attempting to connect this unit to the mains.

You should only plug the appliance into a 220-240V AC, 50Hz supply. Connecting it to other power sources may damage the appliance.

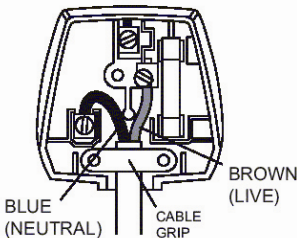

The wires in this mains lead are coloured in accordance with the following code:

BLUE = NEUTRAL
BROWN = LIVE

IMPORTANT

The colours of the wires in the mains lead of this appliance may not correspond with the coloured markings identifying the terminals in your plug, proceed as follows:



Caution
To prevent electric shock disconnect from the mains before removing the cover

- The blue wire must be connected to the terminal marked with the letter N or coloured black.
- The brown wire must be connected to the terminal marked with the letter L or coloured red.
- No connection is to be made to the earth terminal of the plug.

If a 13 Amp (BS1363) fused plug is used it must be fitted with a 3A fuse conforming to BS1362 and be ASTA approved.

If in doubt contact a qualified electrician

Disposal Information



This marking indicates that this product should not be disposed with other household wastes throughout the EU. To prevent possible harm to the environment or human health from uncontrolled waste disposal, recycle it responsibly to promote the sustainable reuse of material resources. To return your used device, please use the return and collection systems or contact the retailer where the product was purchased. They can take this product for environmental safe recycling.

Guarantee

This product is guaranteed against manufacturing defects for a period of

1 year

This does not cover the product where the fault is due to misuse, abuse, use in contravention of the instructions, or where the product has been the subject of unauthorised modifications or alterations, or has been the subject of commercial use

In the event of a problem with the product within the guarantee period please return it to your nearest Argos store

If the item is shown to have had an inherent defect present at the time of sale, the store will provide you with a replacement

Your statutory rights remain unaffected

Guarantor; Argos Ltd
489 – 499 Avebury Boulevard
Central Milton Keynes
MK9 2NW