

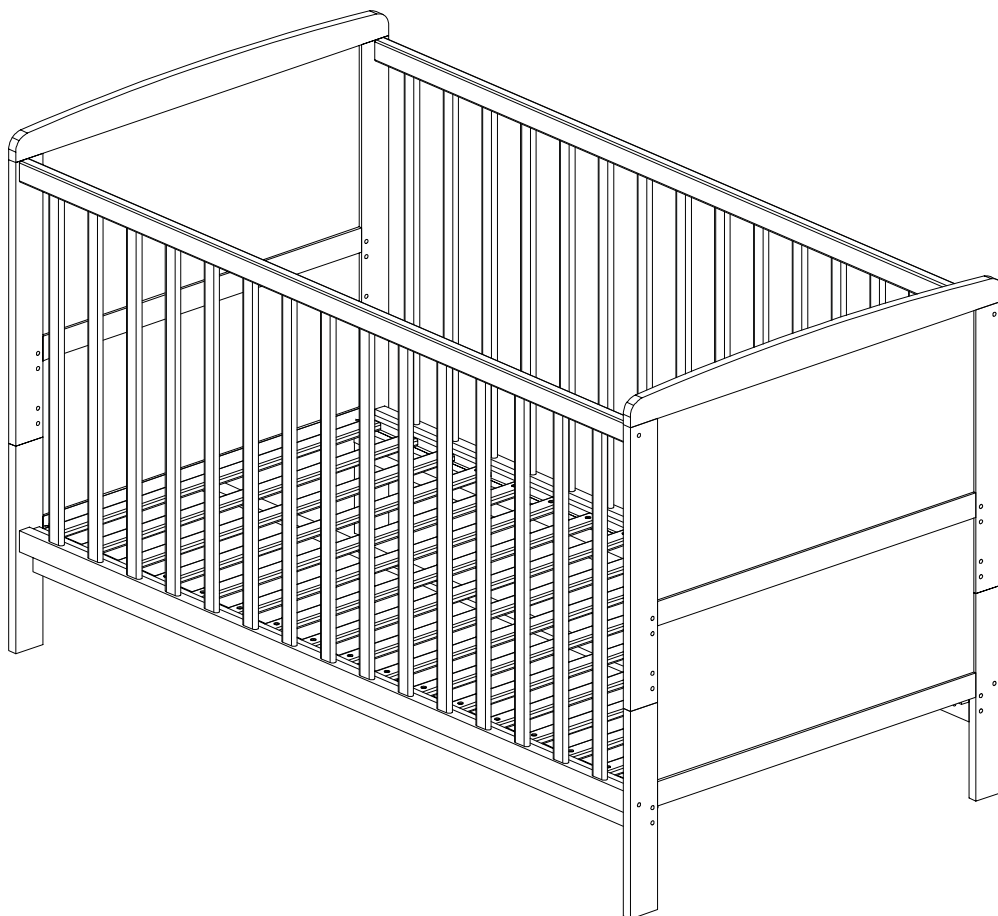

# COT / TODDLER BED



**IMPORTANT: RETAIN FOR FUTURE  
REFERENCE, READ CAREFULLY**

If you need help or have damaged or missing parts, call the Customer Helpline: 08456 400800

## Important notes

The Babystart cot / toddler bed is designed to be used from birth to approximately 4 years old or 50kg. The cot can be converted into a toddler bed.  
Once assembled, this cot / toddler bed is not designed to be dismantled, transported and reassembled. Do not discard any packaging until you have checked the parts against the list below.  
Please take a few minutes to read through the assembly instructions  
Unpack your cot carefully onto a soft level surface such as a carpeted floor.  
Familiarise yourself with the parts by comparing them with the checklist provided below.  
The cot / toddler bed conforms to BSEN716:2008 and BS8509:2008+A1:2011 Safety Standards for Cots and Children's bed.

Please sort out all parts before you begin to assemble the item.  
Make sure you always use the correct part.

### Fittings contained in the box.

**A** x 8 Long bolt

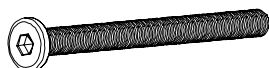

**B** x 16 Nut



**C** x 8 Short bolt



**D** Allen key



### Warning !

Keep all components out of the reach of children.

### Tools needed.



## Wooden parts contained in the box.

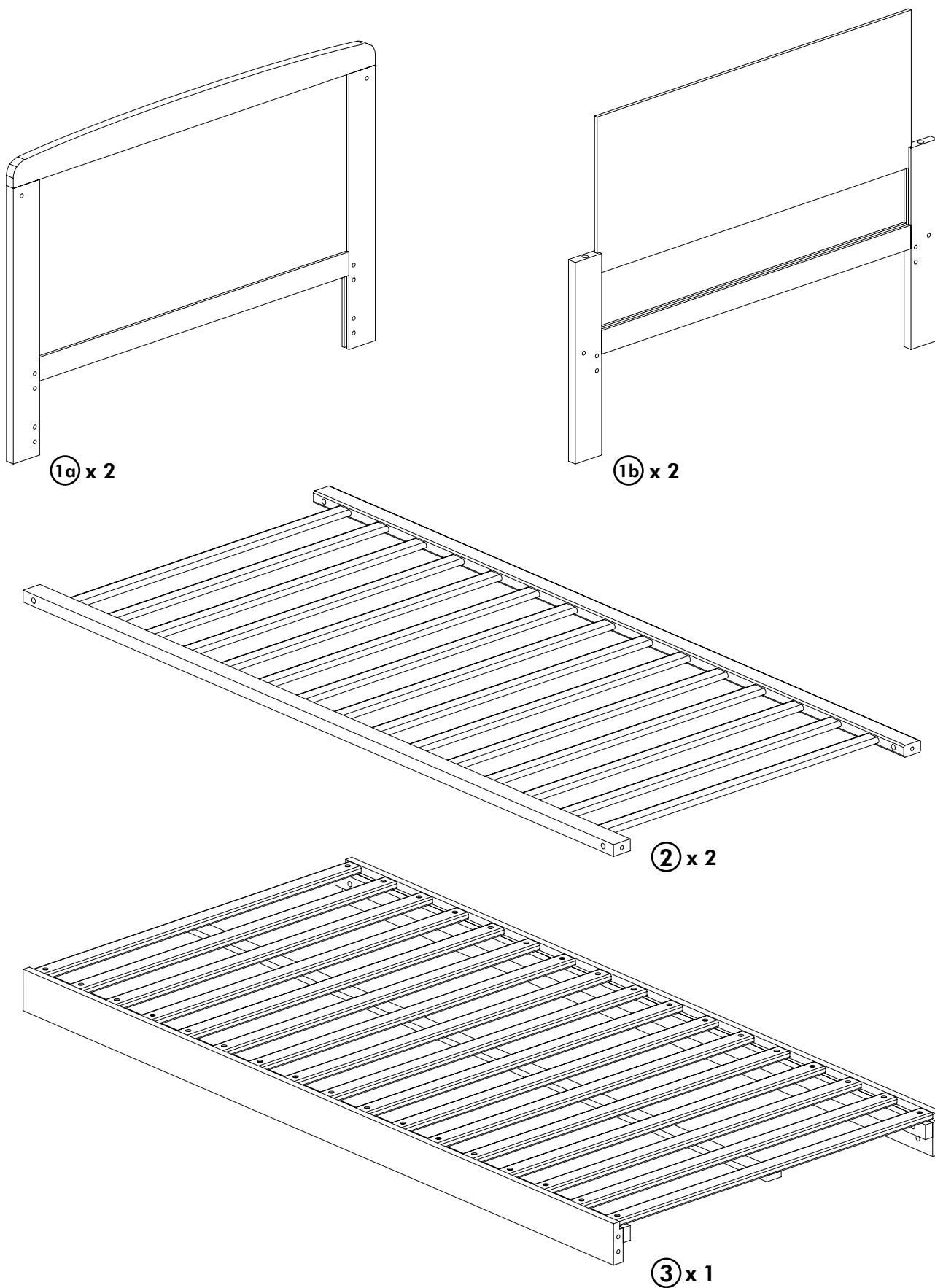

## Key diagram.

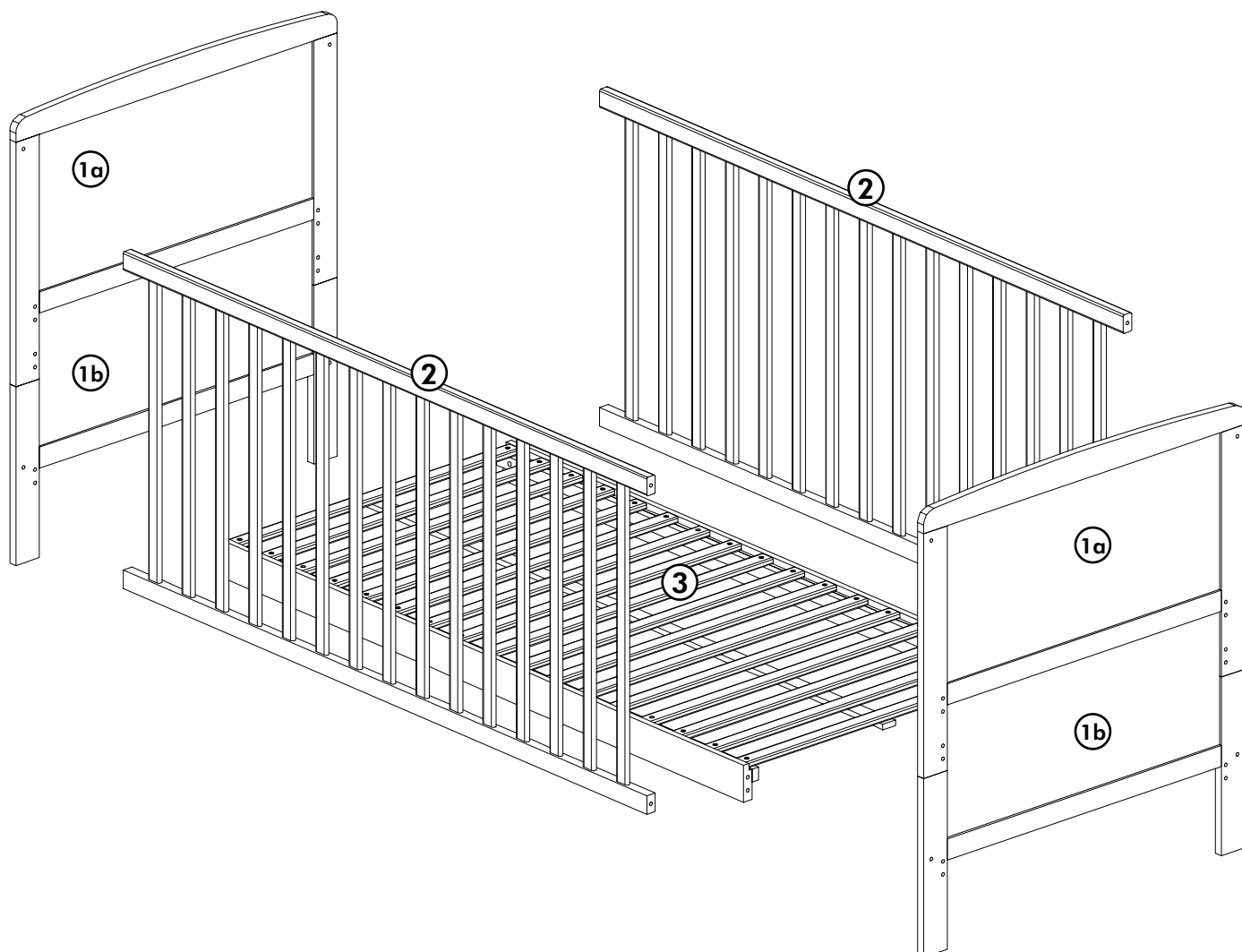

## 1. Fitting the bed base



Ax8



Bx8



Dx1

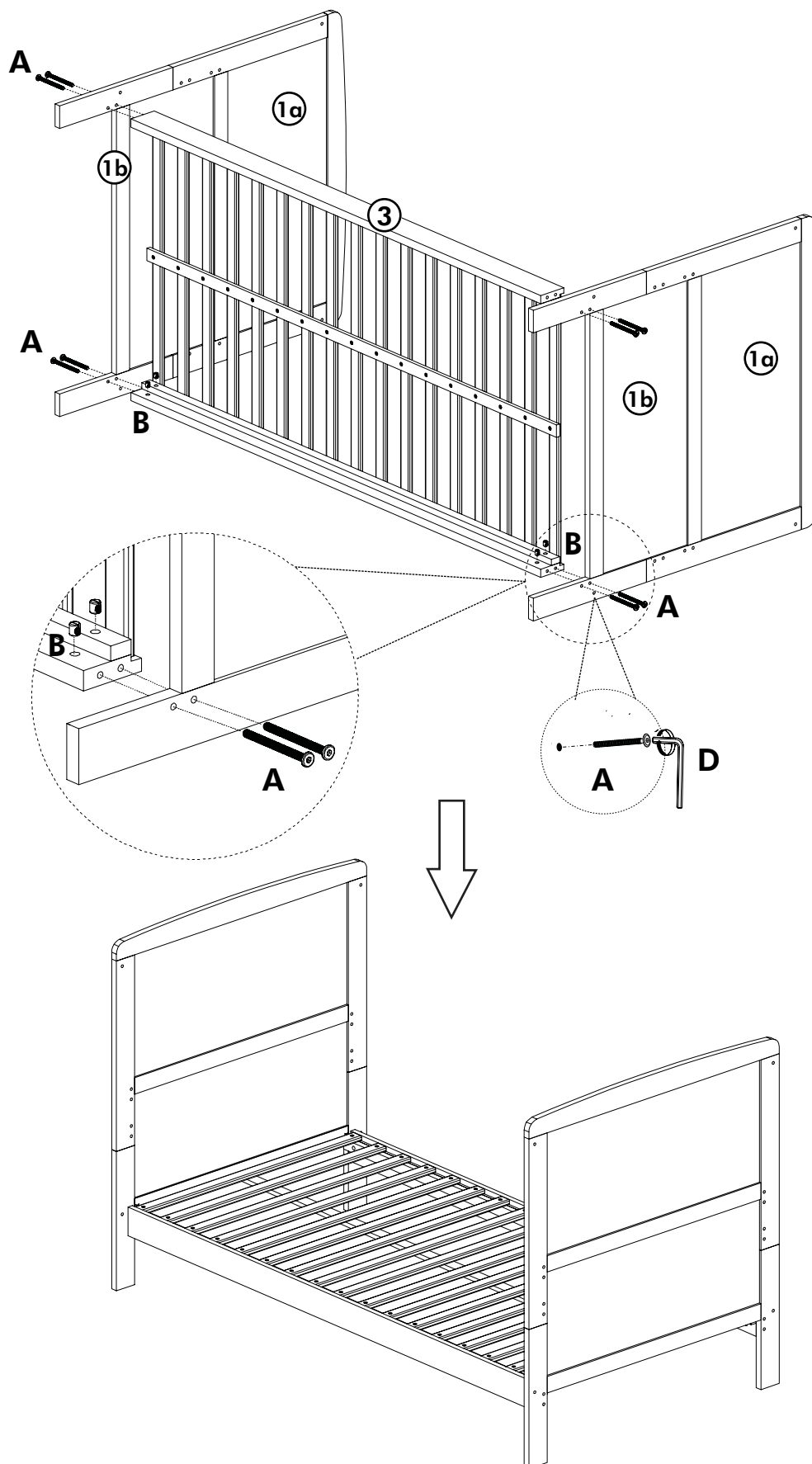

## 2. Fitting the side frames



Cx8



Bx8



Dx1

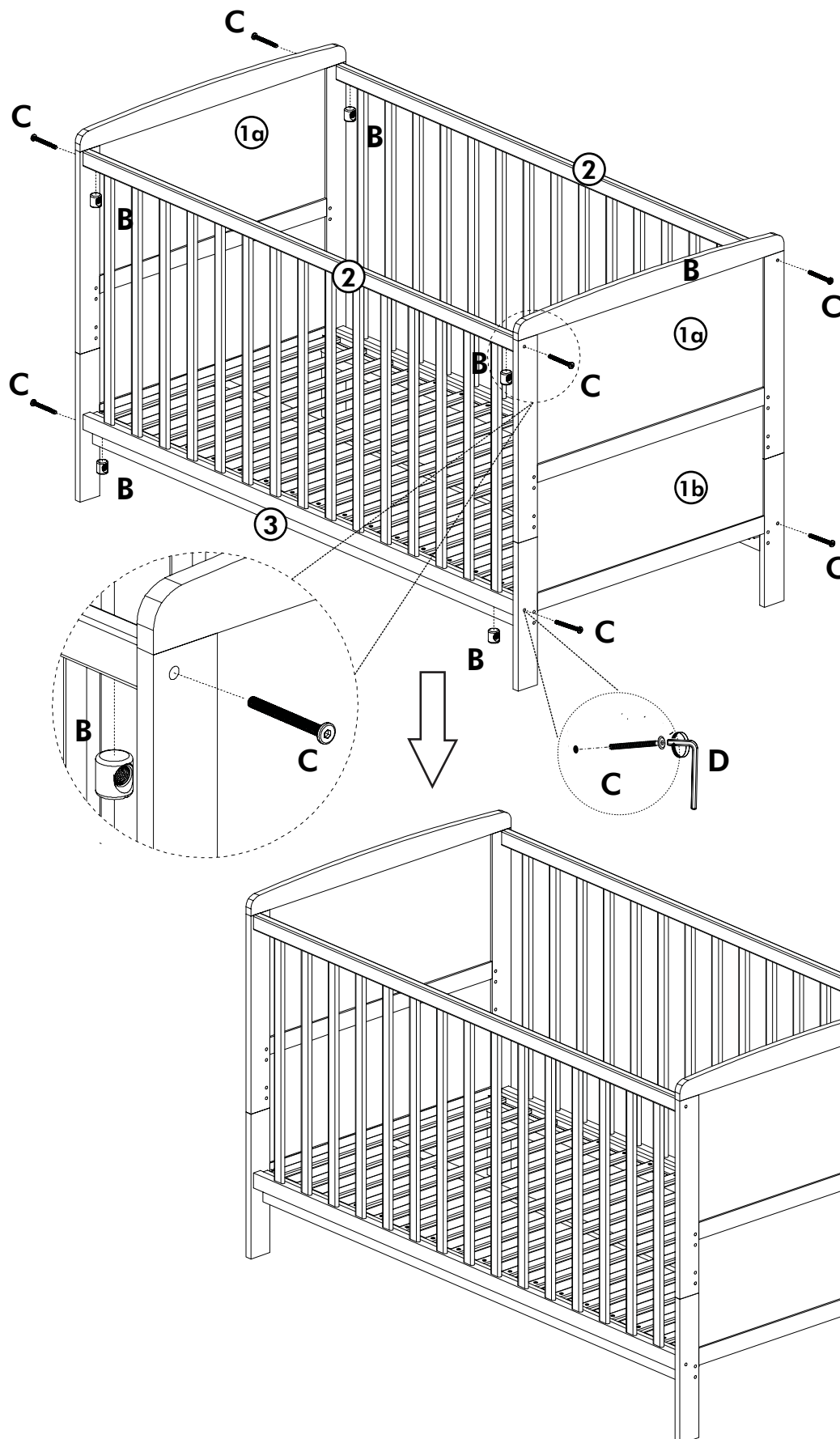

# Toddler bed

## 1. Unscrew the side and the base

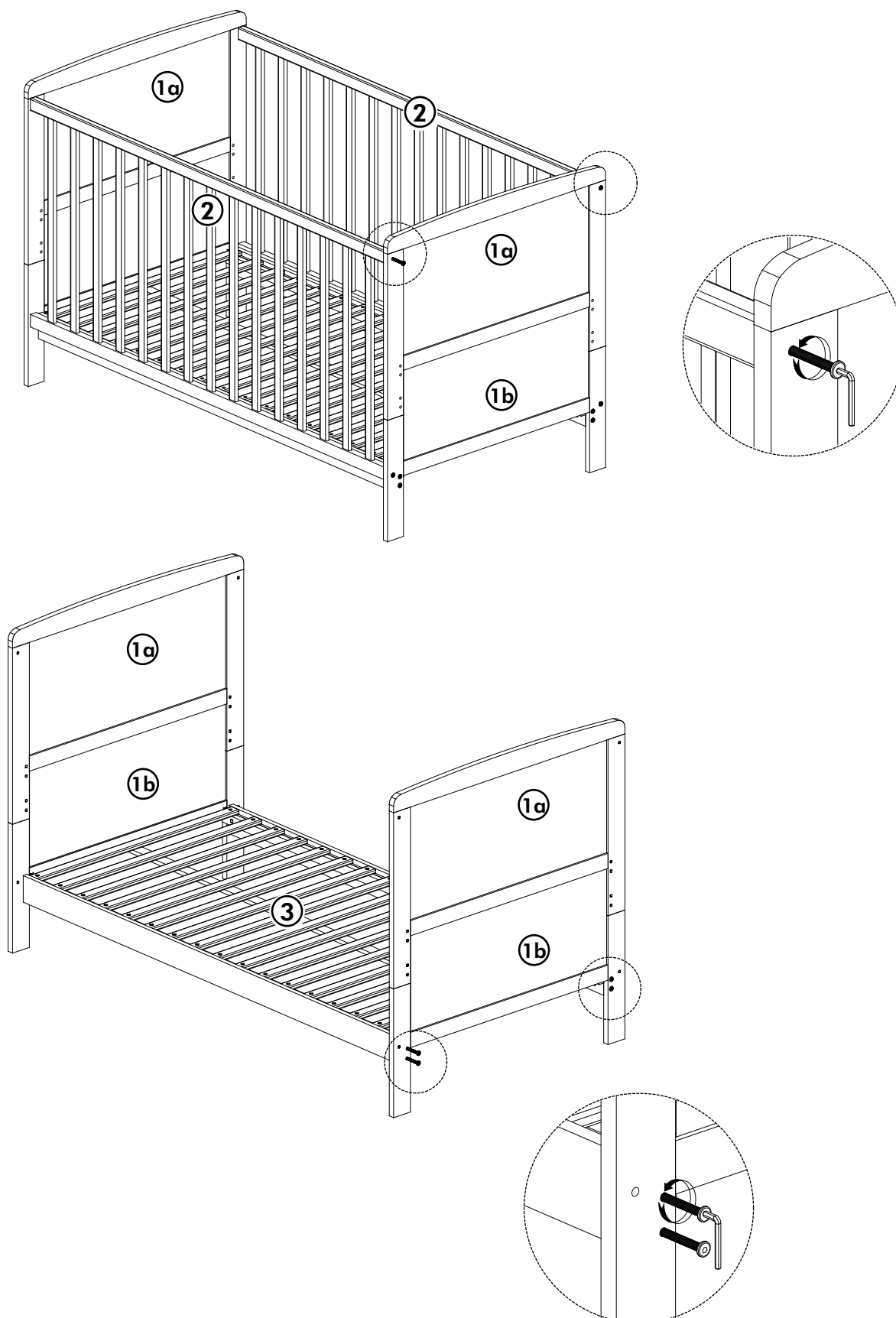

## 2. Taking the end panels into parts (1a) & (1b)

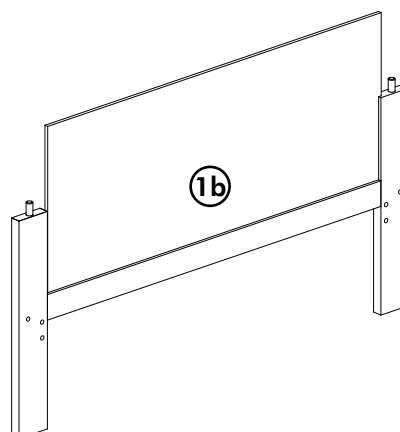
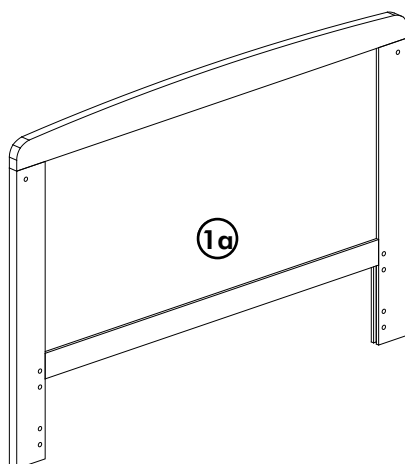
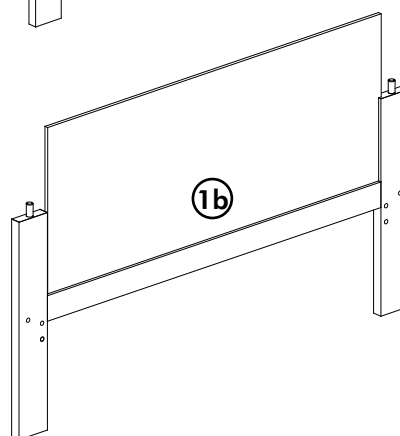
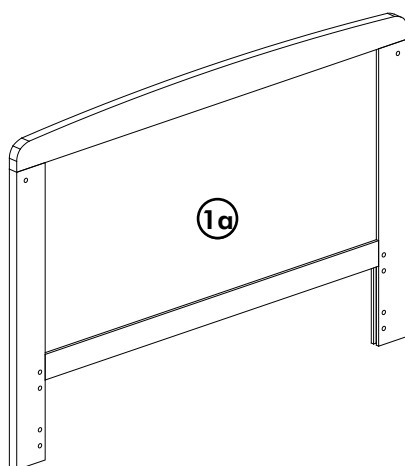
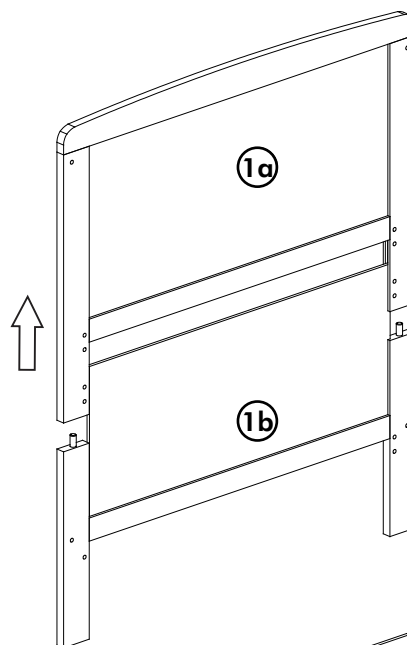
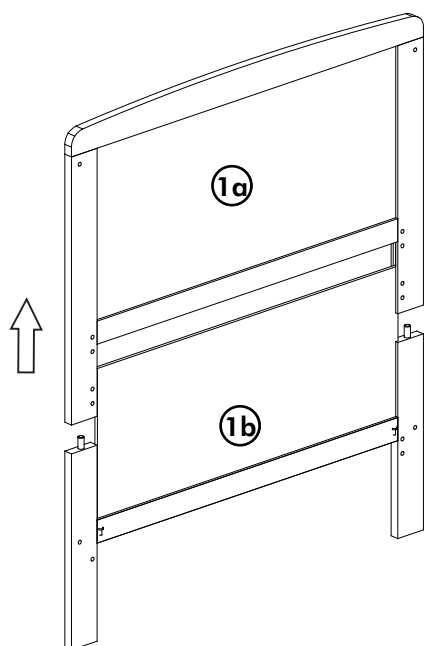



## 3. Fitting the bed base



Ax8



Bx8



Dx1

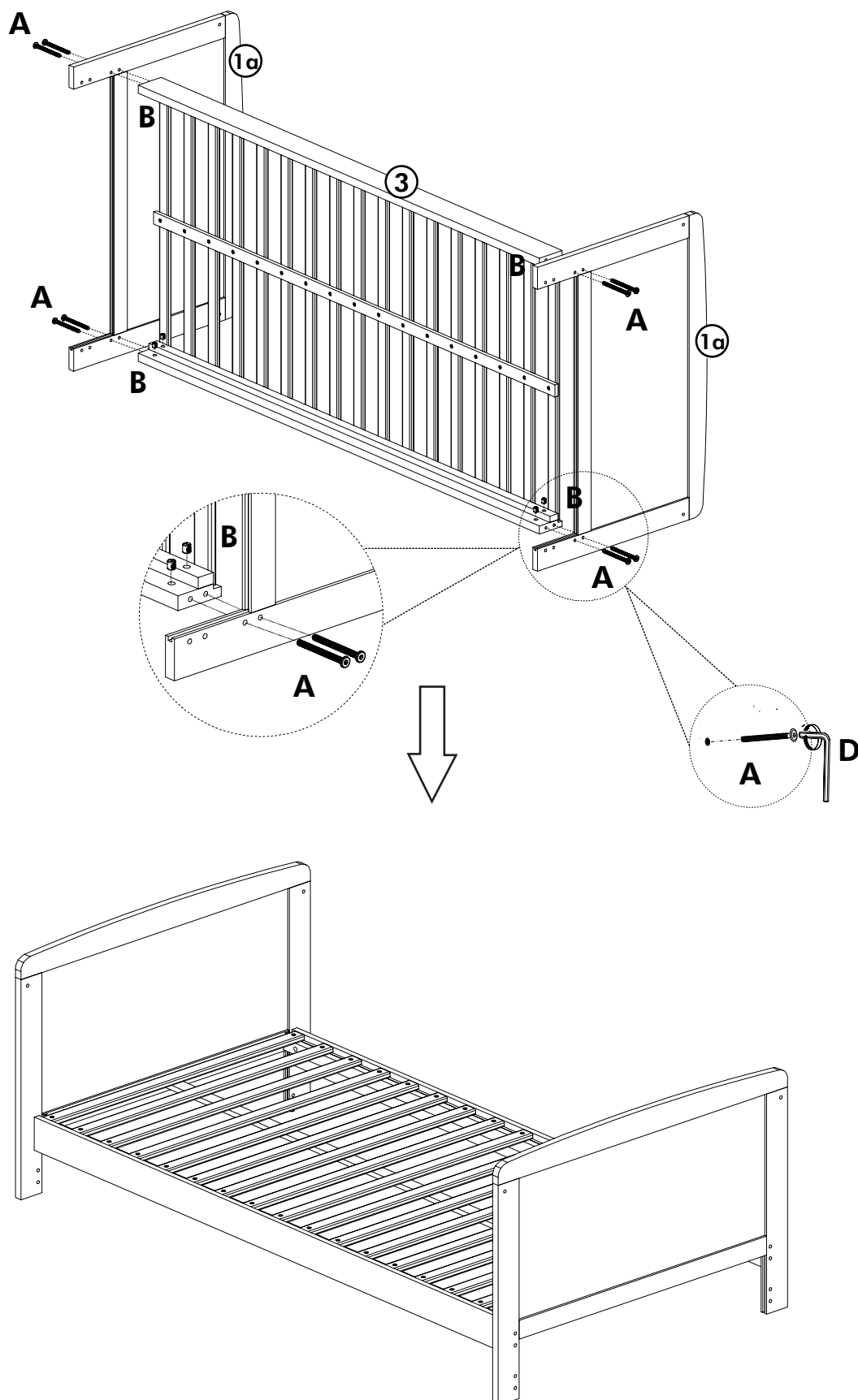

## Care and Safety

### **WARNINGS:**

1. Be aware of the risk of open fire and other sources of strong heat, such as electric bar fires, gas fires, etc. in the near vicinity of the cot.
2. Do not use the cot if any part is broken, torn or missing and use only spare parts approved by the manufacturer.
3. Do not leave anything in the cot or place the cot close to another product, which could provide a foothold or present a danger of suffocation or strangulation, e.g. strings, blind/curtain cords, etc.
4. Do not use more than one mattress in the cot.
5. Do not place this child's bed near heat sources, windows, blinds, strings, curtain cords and other furniture.

### **ADDITIONAL INFORMATION:**

1. Do not allow children to climb the cot. The safety of your child is your responsibility.
2. Before use, please ensure each item of cot is on a stable, level surface.
3. Never pivot or drag the cot / toddler bed when moving. The cot / toddler bed must always be lifted by at least two people.
4. To avoid the risk of suffocation, keep all plastic bags and packaging out of reach of babies and young children.
5. The base can be fixed in 3 positions. The lowest base position is the safest and that the base should always be used in that position as soon as the baby can sit unaided.
6. The recommended mattress size for this cot / toddler bed is 70cm (width) x 140cm (length). The thickness of the mattress used shall be such that the internal height (surface of the mattress to the upper edge of the cot frame) is at least 500mm in the lowest position of the cot base and at least 200mm in the highest position of the cot base.
7. The mattress to be used with this cot / toddler bed should be no more than 30mm shorter or narrower than the internal length or width of the cot / toddler bed.
8. All assembly fittings should always be tightened properly and that fittings should be checked regularly and retightened as necessary.
9. To prevent injury from falls, when the child is able to climb out of the cot, the cot shall no longer be used for that child.
10. Children are likely to play, bounce, jump and climb on beds, therefore the child's bed should not be placed too close to other furniture or windows, and should be placed either tight to any wall or have a gap of 300mm between the wall and the side of the bed.
11. Recommendation that any additional or replacement parts are obtained from the manufacturer or distributor.

### **CARE OF YOUR PRODUCT:**

- Periodically check all fittings to ensure that none have come loose. Any loose fittings must be tightened using the correct tool.
- Your cot / toddler bed can be cleaned by wiping with a damp cloth and drying with a soft dry cloth.
- Never clean with abrasives, ammonia based, bleach based or spirit type cleaners.
- Take care when handling or moving the bed. Careless handling can damage wooden furniture.

### **ARGOS**

Avebury 489-499 Avebury Boulevard Milton Keynes

MK9 2NW

Helpline: 08456 400 800