

Sing-A-Long CD Player

User Instructions - Please keep for future reference

349/9883

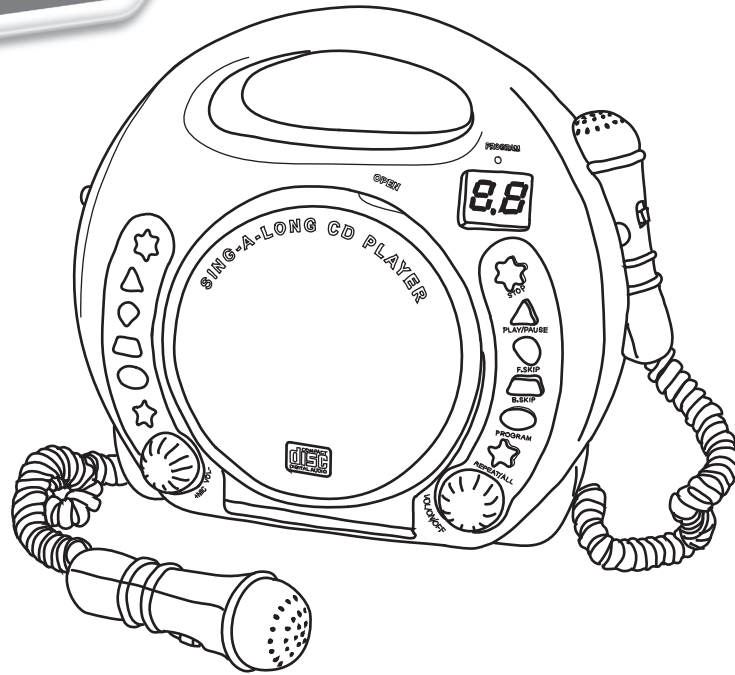

IMPORTANT

Age 3+

Important – Please read these instructions fully before use

These instructions contain important information which will help you get the best from your product and ensure safe and correct assembly, use and maintenance.

If you need help or have damaged or missing parts, call the **Customer Helpline: 08456 400 800**

Issue 1 - 25/06/2010

Safety Information

Important – Please read these instructions fully before use

IMPORTANT WARNING !

This product contains long cords. Parental supervision is recommended with this toy due to the risk of entanglement. Strangulation hazard.

Not suitable for children under 3 years due to small parts, choking hazard.

CLASS 1 LASER PRODUCT

CAUTION
INVISIBLE LASER RADIATION
WHEN OPEN AND INTERLOCKS
DEFEATED.
AVOID EXPOSURE TO BEAM



This product contains a low power laser device.
CAUTION:
THE USE OF CONTROLS OR ADJUSTMENT OR PERFORMANCE
OF PROCEDURES OTHER THAN THOSE SPECIFIED HERE MAY
RESULT IN EXPOSURE TO HAZARDOUS RADIATION.

Using Optional Transformer

(NOT INCLUDED)

- Use only recommended transformer.
- The transformer is not a toy.
- Disconnect transformer before cleaning.
- The transformers used with the toy are to be regularly examined for damage to the cord, plug enclosure and other parts, and that, in the event of such damage. The toy must not be used with this transformer until the damage has been repaired.

NOTE : When you plug the transformer into the unit, the batteries are automatically disconnected. To use battery power, remove the transformer plug from the unit.

CAUTION : This unit is designed to operate with a negative center, DC6V 5W transformers only. Connecting it to any other transformers may damage the unit. Transformers are available in most radio stores.

Battery Safety

1. Do not mix old and new batteries.
2. Do not mix alkaline, standard (carbon zinc), or rechargeable (nickel-cadmium) batteries.
3. Remove batteries if unit is not used for a long period of time to prevent battery leakage and possible damage to the unit.
4. Only batteries of the same equivalent type as recommended are to be used.
5. Exhausted batteries are to be removed from the unit.
6. The supply terminal are not to be short-circuited.
7. Batteries must be installed by an adult.
8. Do not use rechargeable batteries.
9. Non-rechargeable batteries are not to be recharged.
10. Batteries are to be inserted with the correct polarity.

General Safety



- **WARNING:** To reduce the risk of fire, electric shock or product damage, do not expose this appliance to rain, splashing, dripping or moisture.
- Never use or place this unit near a heat source. Do not leave it exposed to direct sunlight.
- The unit should be situated away from equipment or devices that generate strong magnetic fields.
- Do not place any objects on top of the unit.
- Care should be taken so that objects do not fall into and liquids are not spilled into the unit. Do not subject this unit to excessive dust, mechanical vibration or shock.
- The unit should only be serviced by qualified service personnel.

Parts

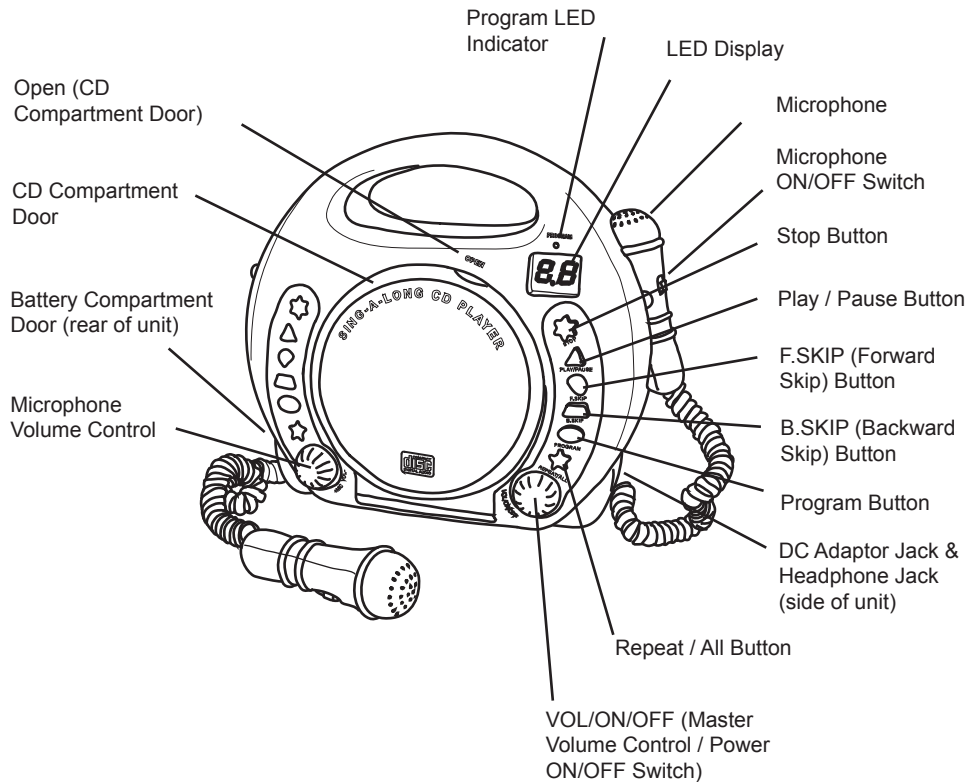
Understand all the parts of the CD Player



Technical Specifications

| | | |
|-------------------|---|---|
| Battery Operation | 4 x "C" Size (UM-2/LR14, 1.5V) | (NOT INCLUDED) |
| Power Adaptor | AC / DC Adaptor | (NOT INCLUDED) |
| Adaptor INPUT | 220V - 240V ~ 50 Hz | |
| Adaptor OUTPUT | DC 6V  600mA, polarity |  |

User Instructions

Rules of using the CD player

CD OPERATION

1. Switch the unit ON by turning VOL/ON/OFF (POWER ON/OFF SWITCH MASTER VOLUME CONTROL) knob.
2. Lift up the lid to reveal the CD player. "NO" shows on the LED DISPLAY indicating there is no disc inside the CD compartment. Lift up the CD compartment door and place a disc on the center spindle, with the printed label side facing up. Then close the CD compartment door.
3. The LED DISPLAY will show "--" for a few seconds, then the total number of tracks on the disc will appear on the display.
4. Press PLAY/PAUSE button to start playback.
5. Adjust VOL/ON/OFF (POWER ON/OFF SWITCH/ MASTER VOLUME CONTROL) knob to the desired level.
6. During CD playback, press PLAY/PAUSE button to pause the disc momentarily. Press PLAY/PAUSE button again to release pause and resume normal CD playback.
7. Press STOP button to stop playback.

SING-A-LONG

1. Place a disc inside the CD compartment.
2. Press PLAY/PAUSE button until it latches.
3. Slide MICROPHONE ON/OFF switch to ON position while singing.
4. Adjust MIC VOL (MICROPHONE VOLUME CONTROL) knob to the desired level.

NOTE :

Do not put the microphone too close to the speaker as this may cause feedback (squealing noise) through the speaker.

TO USE ASA PA (PUBLIC ADDRESS) SYSTEM

No disc is needed. Just talk through the unit.

1. Press PLAY/PAUSE button without a disc in the unit.
2. Slide MICROPHONE ON/OFF switch to ON position.
3. Adjust MIC VOL (MICROPHONE VOLUME CONTROL) knob to the desired level.
4. Speak or sing into the microphone.

NOTE :

Do not put the microphone too close to the speaker as this may cause feedback (squealing noise) through the speaker.

TO BEGIN PLAYBACK FROM A SPECIFIC TRACK

1. After you insert the disc into the CD player and the total number of tracks appear on the display, you may press either F.SKIP (FORWARD SKIP) or B.SKIP (BACKWARD SKIP) button to select a specific track for playback.
2. When the desired track number appears in the display, press PLAY/PAUSE button. Playback will begin on the track you desired.

SKIP FORWARD AND REVERSE DURING PLAYBACK

1. Press F.SKIP (FORWARD SKIP) button to listen to the next track.
2. Press B.SKIP (BACKWARD SKIP) button to listen to the previous track.

User Instructions

Rules of using the CD player

REPEAT PLAYBACK

1. To select the single track repeat function, choose the track that you want to repeat, then press PLAY/PAUSE button to play the track.
2. Press REPEAT/ALL button once to activate the single track repeat and the display will flash.
3. To select the "All Tracks Repeat" function. Press PLAY/PAUSE button to start the track. Press REPEAT/ALL button twice to activate the "All Tracks Repeat" function.

PROGRAMMED PLAYBACK

1. Press PROGRAM button twice, the LED DISPLAY showing "00", and the PROGRAM LED INDICATOR will both flash.
2. Press F.SKIP (FORWARD SKIP) or B.SKIP (BACKWARD SKIP) button to select a track.
3. Press PROGRAM button again to store the selected track number.
4. Repeat steps 2 and 3 above to program other tracks.
5. Press PLAY PAUSE button to start programmed playback and the PROGRAM LED INDICATOR should light up.
6. To erase the programmed sequence, switch the unit OFF by turning VOL/ON/OFF (POWER ON/OFF SWITCH/ MASTER VOLUME CONTROL) knob.
7. Press PROGRAM button in succession to review the tracks currently memorized and change the track number as desired.

NOTE : A maximum of 20 tracks can be programmed to play in any order.

Operation of Power Adaptor

1. Only use a common DC 6V/600mA power adaptor (not included)
2. Connect the power adaptor to the DC jack.
3. For Operation only with a short-circuit-proof safety isolating transformer according to EN61558-2-6 or toy transformer according to EN61558-2-7.

Battery Installation / Replacement

1. Open the battery compartment : Loosen the screw on the cover of battery compartment with a screwdriver and remove the cover.
2. Insert 4 x "C" Size (UM2 / LR14 1.5V) type batteries (not included). Make sure that you follow the polarity markings inside the compartment!
3. Close the battery compartment and tighten the screw.

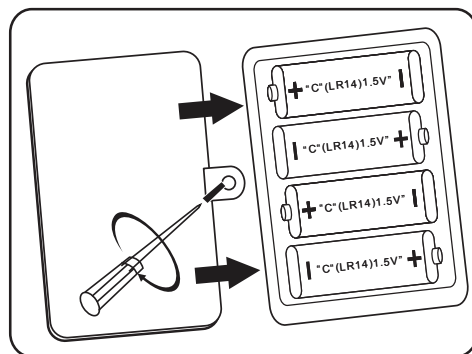

Care and Maintenance

General

Caring for Compact Discs

- Treat the compact disc carefully. Handle the compact disc only by its edge. Never allow your fingers to come in contact with the shiny, upprinted side of the compact disc.
- Do not attach adhesive tape, stickers, etc. to the compact disc label.
- Clean the compact disc periodically with a soft, lint-free, dry cloth.
- Never use detergents or abrasive cleaners to clean the compact disc. If necessary, use a CD cleaning kit.
- If a compact disc skips or gets stuck on a section of the compact disc, it is probably dirty or damaged (scratched).
- When cleaning the compact disc, wipe in straight lines from the center of the compact

disc to the outer edge of the disc, Never wipe in circular motions.

- This unit is designed to play only compact discs. Other discs may not conform to the CD standard and may not play properly.
- Compact discs should be stored in their cases after each use to avoid damage.
- Do not expose compact discs to direct sunlight, high humidity, high temperatures, or dust, etc. Prolonged exposure of extreme temperatures can warp the compact disc.
- Do not stick or write anything on either side of the compact disc.
- Sharp writing instruments or the ink may damage the surface.

Cleaning the unit

- To prevent fire or shock hazard, disconnect your unit from the AC power source when cleaning.
- The finish on your unit may be cleaned with a dust cloth and cared for as other furniture.

- Use caution when cleaning and wiping the plastic parts.
- Mild soap and a damp cloth may be used on the front panel.



WARNING: Not suitable for children under 3 years due to small parts, choking hazard and Strangulation Hazard.

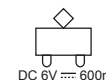

Use recommended type and rating of external transformer only

Table/Troubleshooting

General

Before requesting service for this unit, check the chart below for possible cause of the problem you are experiencing. If the remedies indicated in the chart do not solve the problem, get help on customer helpline or consult your qualified professionals.

| Problem | Check this |
|-------------------------------------|--|
| Cannot close the cover | <ul style="list-style-type: none"> • Is the disc properly secured in place? |
| Cannot play discs | <ul style="list-style-type: none"> • Is the battery exhausted? • Is the power supply disconnected? • Is there condensation on the lens? (wait for about a few hours and then try again) |
| A single track repeat all the times | <ul style="list-style-type: none"> • Is the repeat single track function activated. (see section repeat playback) |
| Speaker does not produce sound | <ul style="list-style-type: none"> • Is earphone plug being inserted to headphone jack? • Is the microphone switched on? • Is the microphone sound and master volume switch turned to minimum volume level? |
| Headphone cannot hear music | <ul style="list-style-type: none"> • Separate the unit from mobile phones. • Have the headphone plug been inserted firmly? • Is the plug dirty? (wipe away dirt on plug) |

Disposal information



The symbol on the product or its packaging indicates that this product may not be treated as household waste. Instead it should be handed over to the applicable collection point for the recycling of electrical and electronic equipment. By ensuring this product is disposed of correctly, you will help

prevent potential negative consequences for the environment and human health, which could otherwise be caused by inappropriate waste handling of this product. For more detailed information about recycling this product, please contact your local council office, your household waste disposal service or the shop where the product was purchased.

If you need help or have damaged or missing parts, call the **Customer**

Helpline: 08456 400 800

Produced for Chad Valley Toys.

Country of origin: China

Address: 489 - 499 Avebury Boulevard, Central Milton Keynes, MK9 2NW.