



3 years +

## CV Singalong Keyboard Stand & Stool



ITEM NO: 6141S

## ASSEMBLY INSTRUCTIONS

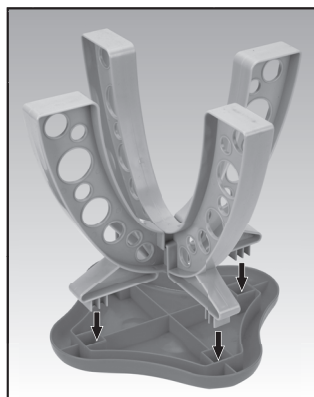
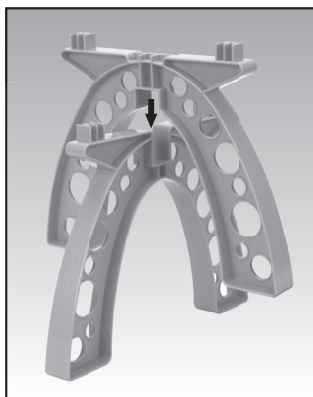
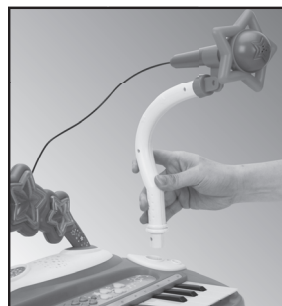

## CV SINGALONG KEYBOARD STAND & STOOL

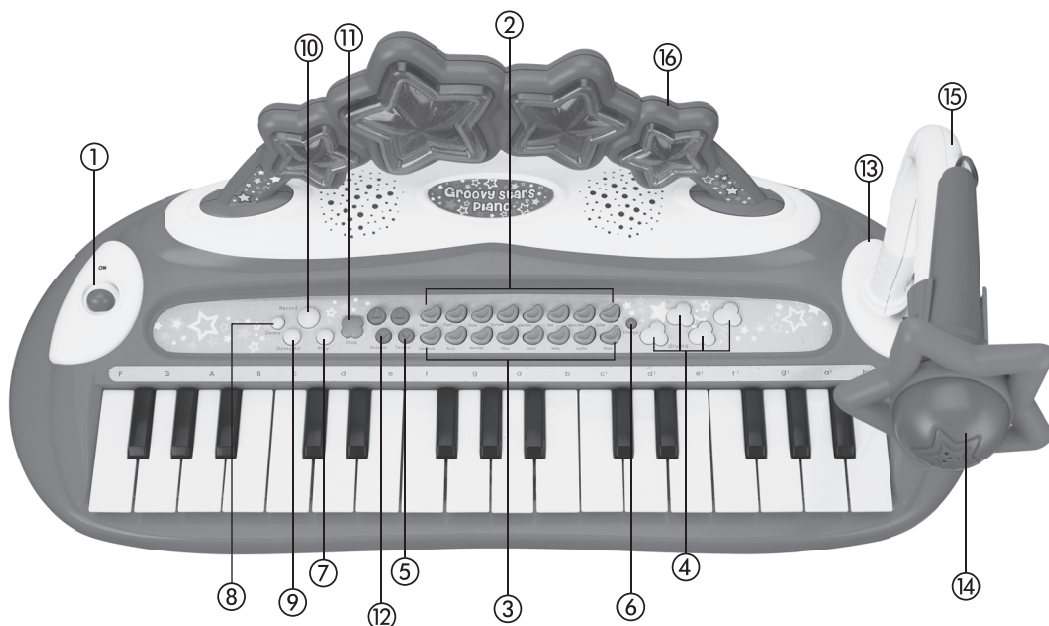

### 1. ON/OFF

Switching On/Off

### 2. Musical instruments selection

### 3. Rhythms selection

### 4. Drum

Percussion instruments or animal voices

### 5. Tempo

To regulate the rhythm speed

### 6. Change

Selection of rhythm instruments or animal voices

### 7. Play

To listen to the last recording

### 8. Demo

Demo song

### 9. Demo All

All the demo songs

### 10. Record

To record the notes played

### 11. Stop

To stop the rhythm or the demosong

### 12. Volume

To regulate the general volume

### 13. Microphone socket

### 14. Microphone

### 15. Microphone holder

### 16. Flashing stars

## POWER SUPPLY

Open the battery compartment. Insert 4 x 1,5V batteries LR6/AA (not included). Re-fit battery cover. Use new batteries for best performance.



ATTENTION – BATTERY CARE: • Non-rechargeable batteries are not to be recharged. • Rechargeable batteries must be removed from the toy before being charged. • Rechargeable batteries are only to be charged under adult supervision. • Different types of batteries or new and old batteries are not to be mixed. • Use only batteries of the same or equivalent type. • Batteries are to be inserted with correct polarity. • Remove exhausted batteries to prevent leakage. • Do not short-circuit supply terminals. • Remove batteries during long periods of non-use

DISPOSAL OF BATTERIES - Protect the environment. Batteries can be recycled and should be disposed of in the right containers. Do not throw them in the ordinary rubbish.



## SWITCHING ON/OFF

To switch on the instrument move selector (1) to **ON**. To switch the instrument off move the same selector to **OFF**. The keyboard switches off automatically after 3 minutes of non-use.



## DEMO SONGS

This keyboard has **8 demo songs**. Press **Demo** (8), to listen to one of the 8 demo songs. Press **Demo All** (9), to listen to the six demo songs in sequence. Press **Stop** (11) to interrupt.

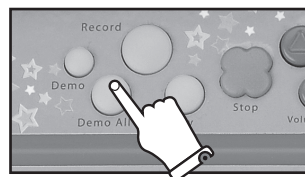

## VOLUME CONTROL

Adjust volume to desired level by using the **Volume** buttons (12); ▲ to increase and ▼ to reduce.

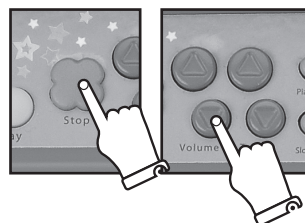

## MUSICAL

You can select one of the **8 instruments** (Trumpet, Organ, Violin, Piano, Mandolin, Bell, Music box, Guitar) by pressing the related button (2).



## RHYTHMS

You can select one of the **8 rhythms** (March, Waltz, Samba, Slow rock, Blues, Rock, New Age, Disco) by pressing the related buttons (3).

Press the **Tempo** buttons (5) to reduce (▲) or increase (▼) the rhythm speed. Press **Stop** (11) to interrupt.

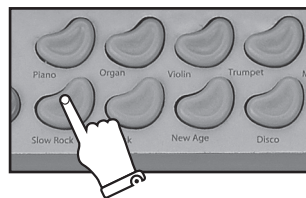

## RECORD/PLAYBACK FUNCTION

This function enables you to record and playback a tune played either on the keyboard or on the pads. Press **Record** (10) before playing a tune. When you have finished press **Play** (7) to listen to the tune. Press the **Tempo** buttons (5) to reduce (▲) or increase (▼) the speed.

ATTENTION: press **Stop** to activate the recording function, otherwise the instrument continues recording any further tunes played.

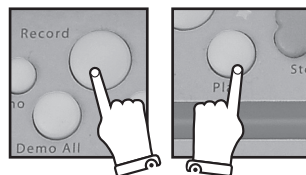

## PADS

By pressing the button **Change** (6) you can alternatively utilize the 4 pads either to play percussion instruments (DRUM) or to reproduce the animal voices (ANIMAL).



## MICROPHONE

Insert microphone in the special holder (15) and connect into the **MIC** socket.

Speak or sing into the microphone; your voice will be heard through the speaker. The led light will flash.



## TROUBLE SHOOTING GUIDE

Problem	Solution
The instrument doesn't work or distorted sound	<i>Batteries low – fit new batteries. Batteries incorrectly fitted – check.</i>
Microphone doesn't work.	<i>Check that the jack-pin is inserted.</i>



**WARNING-** Not for children under the age of 36 months due to small parts may present a choking hazard! Risk of strangulation due to the cable!  
Adult supervision is recommended at all times. Color and contents may vary.  
**Caution:** Remove all packaging and attachments before giving this toy to a child.  
Please retain all information relating to this product for future reference.

Stool not for children with a body weight of more than 50 lbs or 22 kgs.  
Check the stool regularly for any damage and to ensure correct assembly.  
Only use the stool on level, stable surfaces.



Argos MK9 2NW

**WASTE ELECTRICAL PRODUCTS SHOULD NOT BE  
DISPOSED OF WITH HOUSEHOLD WASTE. PLEASE  
RECYCLE WHERE FACILITIES EXIST. CHECK WITH  
YOUR LOCAL AUTHORITY FOR RECYCLING ADVICE.**

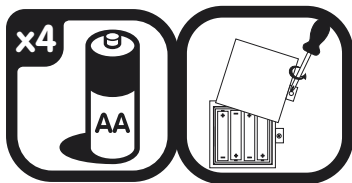

Only use the batteries specified (4 x 1,5 V LR6)! Put positive and negative pole in the right place! Do not throw away used batteries in the household garbage, but only give them to the collection station or dispose of them at a special garbage depot. Remove empty batteries from the toy. Non-rechargeable batteries must not be recharged. Before charging remove rechargeable batteries from the toy. Rechargeable batteries must be charged under adult supervision only. Do not use different types of batteries and do not mix new and used batteries. Do not short circuit connector clips. Do not mix old and new batteries. Do not mix alkaline, standard (carbon-zinc), or rechargeable (nickel-cadmium) batteries.

