

INSTALLATION PROCEDURE

1 Take out the bath pillars. Do not mix the two different bath pillars up.

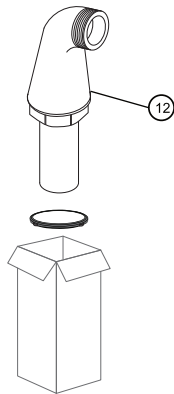

2 Remove the backnuts and washers from the bath pillars.

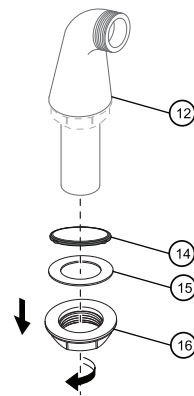

3 Fit the washers to the connector.

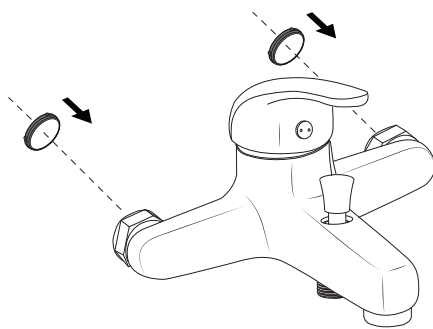

4 Tighten the bath pillars to the connectors, ensuring the bath legs are in the right place, HOT&COLD.

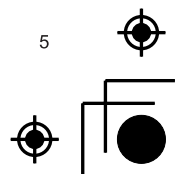
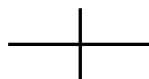
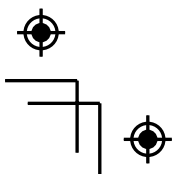
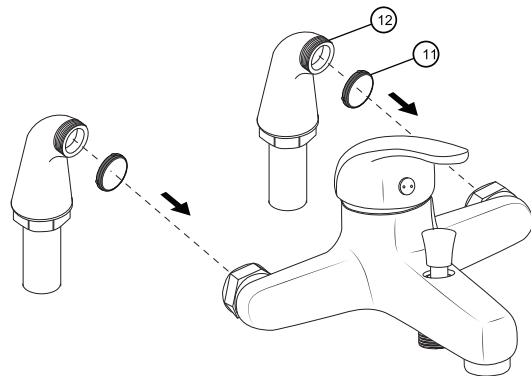

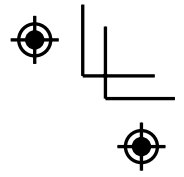
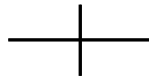
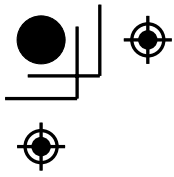

INSTALLATION PROCEDURE

- 5** Carefully assemble the mixer on to the bath, ensuring rubber washers are in place at the base.

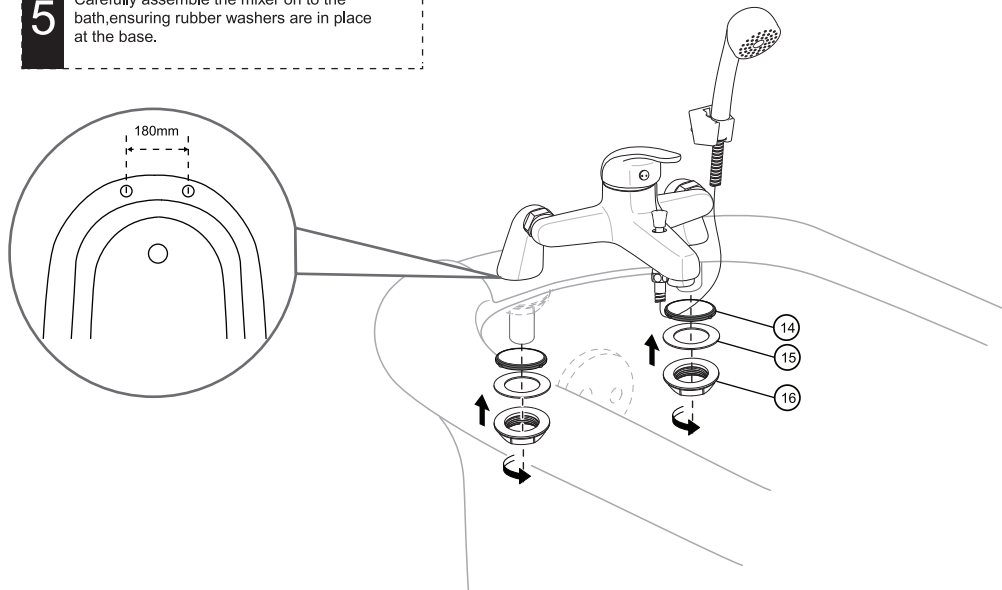

- 6** Tighten the backnuts, ensuring equal torque is applied to both nuts.

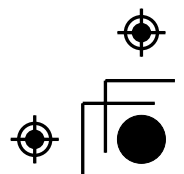
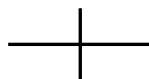
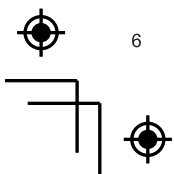
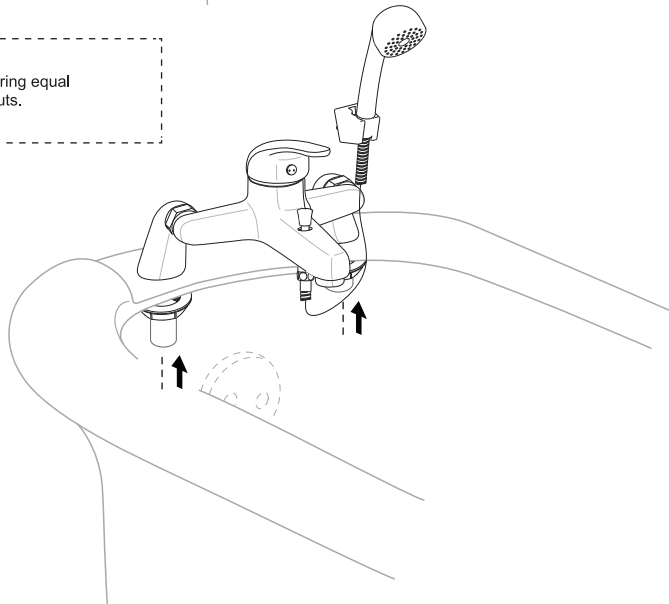

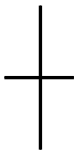
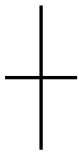
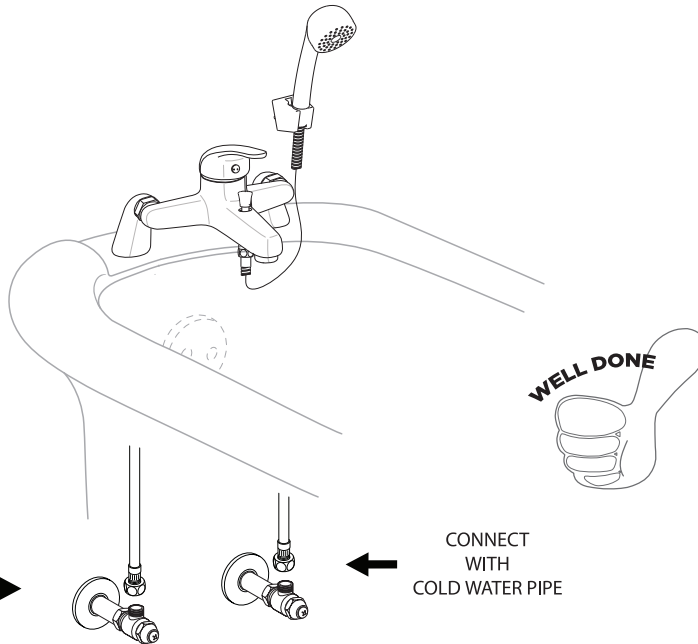
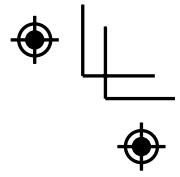
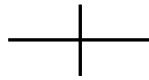
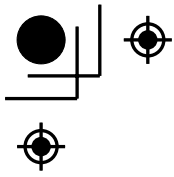

AFTER INSTALLATION

Ensure that all connections are tight. Ensure that the handle is in the O position. Turn on the drain and main water supply, and check for leaks. Repair as needed.

CARE & CLEANING

Your new tap is designed for years of trouble-free performance. Keep it looking new by cleaning it periodically with mild soap, rinse thoroughly with warm water and dry with a clean, soft cloth. Do not use abrasive cleaners, steel wool or harsh chemicals, as these will dull the finish. Failure to follow these instructions may void your warranty.

