

WORX

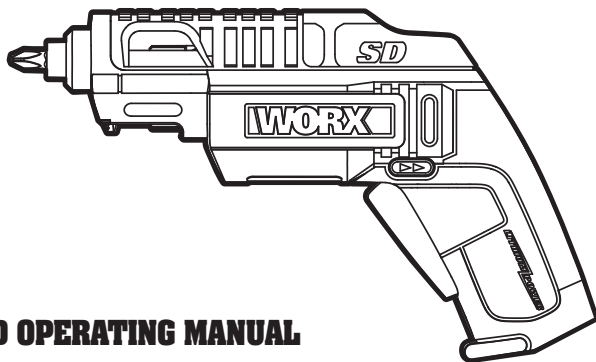

SAFETY AND OPERATING MANUAL
ORIGINAL INSTRUCTIONS

SD SLIDE
DRIVER™

WX254 WX254.1 WX254.3 WX254.4 WX254.6 WX254.7

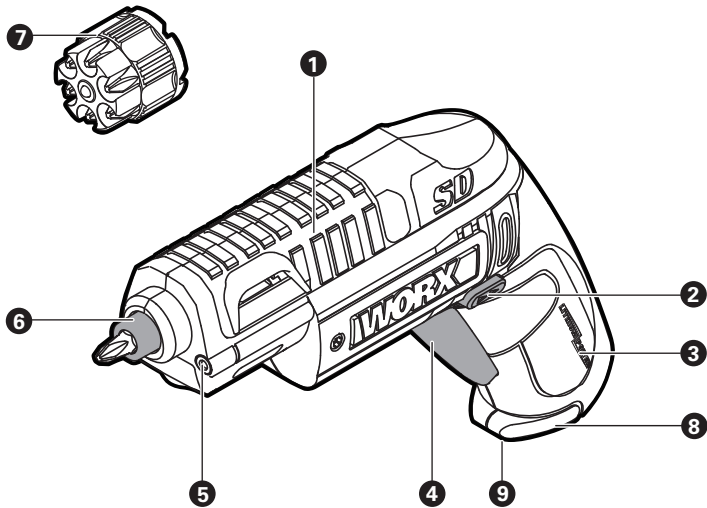

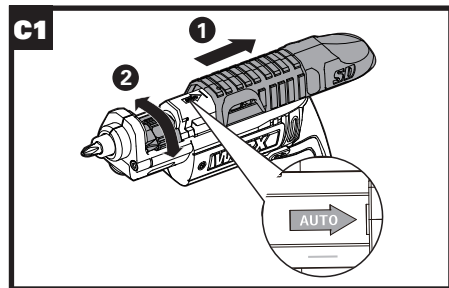
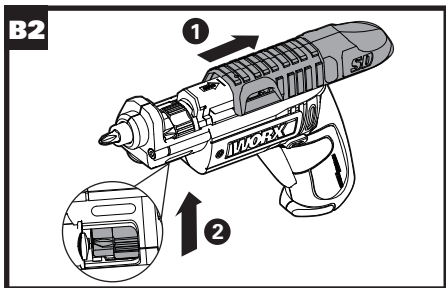
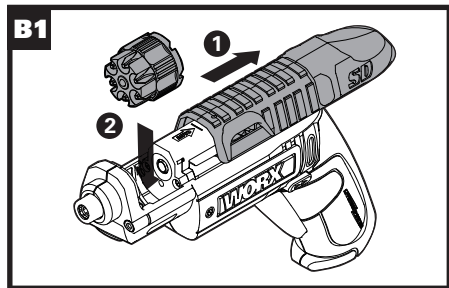
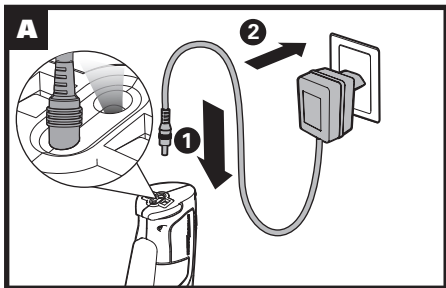

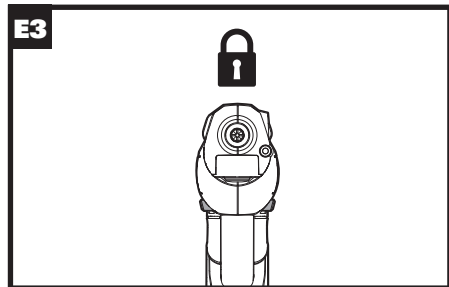
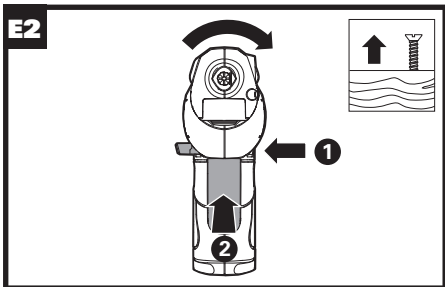
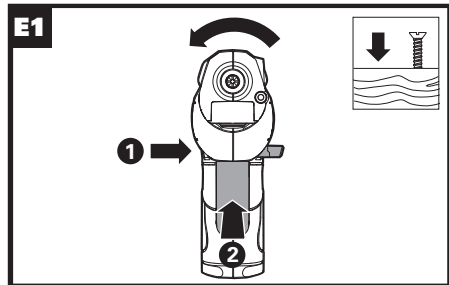
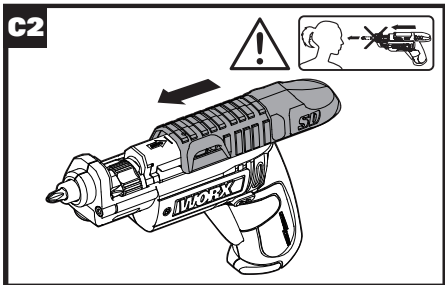

F

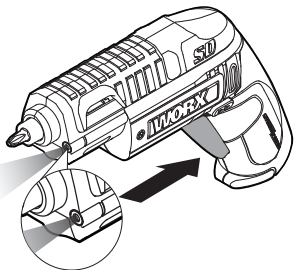

- 1. COVER**
- 2. FORWARD/REVERSE ROTATION CONTROL**
- 3. SOFT GRIP HANDLE**
- 4. ON/OFF SWITCH**
- 5. LED LIGHT**
- 6. BIT HOLDER OR CHUCK**
- 7. BIT CARTRIDGE**
- 8. CHARGING INDICATOR**
- 9. CHARGING SOCKET**

Not all the accessories illustrated or described are included in standard delivery.

TECHNICAL DATA

6

Type **WX254 WX254.1 WX254.3 WX254.4 WX254.6 WX254.7 (250~269-designation of machinery, representative of Battery-powered Screwdriver)**

Charger input	100-240V~ 50/60Hz 190mA
Charger output	4.2V 500mA
Charger voltage	100- 240V ~ 50 /60Hz
Rated voltage	4V  Max*
Battery capacity	1.5Ah lion
No-load speed	230/min
Max.torque	3N.m
Machine weight	0.5kg
Charging time	3-5 hours

* Voltage measured without workload. Initial battery voltage reaches maximum of 4volts. Nominal voltage is 3.6volts.

NOISE INFORMATION

A weighted sound pressure	L_{pA} : 65dB(A)
A weighted sound power	L_{wA} : 76dB(A)
K_{pA} & K_{wA}	3.0dB(A)
Wear ear protection when sound pressure is over	80dB(A) 

VIBRATION INFORMATION

Vibration total values (triax vector sum) determined according to EN 60745:

Drilling into metal	Vibration emission value $a_h = 0.7m/s^2$
	Uncertainty $K = 1.5m/s^2$

The declared vibration total value may be used for comparing one tool with another, and may also be used in a preliminary assessment of exposure.

 **WARNING:** The vibration emission value during actual use of the power tool can differ from the declared value depending on the ways in which the tool is used dependant on the following examples and other variations on how the tool is used:

How the tool is used and the materials being cut or drilled.

The tool being in good condition and well maintained.

The use the correct accessory for the tool and ensuring it is sharp and in good condition.

The tightness of the grip on the handles and if any anti vibration accessories are used.

And the tool is being used as intended by its design and these instructions.

This tool may cause hand-arm vibration syndrome if its use is not adequately managed.



WARNING: To be accurate, an estimation of exposure level in the actual conditions of use should also take account of all parts of the operating cycle such as the times when the tool is switched off and when it is running idle but not actually doing the job. This may significantly reduce the exposure level over the total working period.

Helping to minimize your vibration exposure risk.

ALWAYS use sharp chisels, drills and blades.

Maintain this tool in accordance with these instructions and keep well lubricated (where appropriate).

If the tool is to be used regularly then invest in anti vibration accessories.

Avoid using tools in temperatures of 10°C or less.

Plan your work schedule to spread any high vibration tool use across a number of days.

ACCESSORIES

	WX254	WX254.1	WX254.3	WX254.4	WX254.6	WX254.7
8 25mm Screwdriver Bits	5	11	6	5	5	11
25mm Pilot Hole Drill Bit	1	1	/	1	1	1
3-5hr Charger	1	1	1	1	1	1
Bit Cartridges	1	2	1	1	1	2
Holster	/	1	/	/	/	1

We recommend that you purchase your accessories from the same store that sold you the tool. Refer to the accessory packaging for further details. Store personnel can assist you and offer advice.

GENERAL POWER TOOL SAFETY WARNINGS



WARNING Read all safety warnings and all instructions. Failure to follow the warnings and instructions may result in electric shock, fire and/or serious injury.

Save all warnings and instructions for future reference.

The term “power tool” in the warnings refers to your mains-operated (corded) power tool or battery-operated (cordless) power tool.

1) WORK AREA SAFETY

- a) **Keep work area clean and well lit.** Cluttered or dark areas invite accidents.
- b) **Do not operate power tools in explosive atmospheres, such as in the presence of flammable liquids, gases or dust.** Power tools create sparks which may ignite the dust or fumes.
- c) **Keep children and bystanders away while operating a power tool.** Distractions can cause you to lose control.

2) ELECTRICAL SAFETY

- a) **Power tool plugs must match the outlet. Never modify the plug in any way. Do not use any adapter plugs with earthed (grounded) power tools.** Unmodified plugs and matching outlets will reduce risk of electric shock.
- b) **Avoid body contact with earthed or grounded surfaces, such as pipes, radiators, ranges and refrigerators.** There is an increased risk of electric shock if your body is earthed or grounded.
- c) **Do not expose power tools to rain or wet**

conditions. Water entering a power tool will increase the risk of electric shock.

- d) **Do not abuse the cord. Never use the cord for carrying, pulling or unplugging the power tool. Keep cord away from heat, oil, sharp edges or moving parts.** Damaged or entangled cords increase the risk of electric shock.
- e) **When operating a power tool outdoors, use an extension cord suitable for outdoor use.** Use of a cord suitable for outdoor use reduces the risk of electric shock.
- f) **If operating a power tool in a damp location is unavoidable, use a residual current device (RCD) protected supply.** Use of an RCD reduces the risk of electric shock.

3) PERSONAL SAFETY

- a) **Stay alert, watch what you are doing and use common sense when operating a power tool. Do not use a power tool while you are tired or under the influence of drugs, alcohol or medication.** A moment of inattention while operating power tools may result in serious personal injury.
- b) **Use personal protective equipment. Always wear eye protection.** Protective equipment such as dust mask, non-skid safety shoes, hard hat, or hearing protection used for appropriate conditions will reduce personal injuries.
- c) **Prevent unintentional starting. Ensure the switch is in the off-position before connecting to power source and/or battery pack, picking up or carrying the tool.** Carrying power tools with your finger on the switch or energising power tools

that have the switch on invites accidents.

- d) **Remove any adjusting key or wrench before turning the power tool on.** A wrench or a key left attached to a rotating part of the power tool may result in personal injury.
- e) **Do not overreach. Keep proper footing and balance at all times.** This enables better control of the power tool in unexpected situations.
- f) **Dress properly. Do not wear loose clothing or jewellery. Keep your hair, clothing and gloves away from moving parts.** Loose clothes, jewellery or long hair can be caught in moving parts.
- g) **If devices are provided for the connection of dust extraction and collection facilities, ensure these are connected and properly used.** Use of dust collection can reduce dust-related hazards.

4) POWER TOOL USE AND CARE

- a) **Do not force the power tool. Use the correct power tool for your application.** The correct power tool will do the job better and safer at the rate for which it was designed.
- b) **Do not use the power tool if the switch does not turn it on and off.** Any power tool that cannot be controlled with the switch is dangerous and must be repaired.
- c) **Disconnect the plug from the power source and/or the battery pack from the power tool before making any adjustments, changing accessories, or storing power tools.** Such preventive safety measures reduce the risk of starting the power tool accidentally.
- d) **Store idle power tools out of the reach of children and do not allow persons unfamiliar with the power tool or these instructions**

to operate the power tool. Power tools are dangerous in the hands of untrained users.

- e) **Maintain power tools. Check for misalignment or binding of moving parts, breakage of parts and any other condition that may affect the power tool's operation. If damaged, have the power tool repaired before use.** Many accidents are caused by poorly maintained power tools.
- f) **Keep cutting tools sharp and clean.** Properly maintained cutting tools with sharp cutting edges are less likely to bind and are easier to control.
- g) **Use the power tool, accessories and tool bits etc. in accordance with these instructions, taking into account the working conditions and the work to be performed.** Use of the power tool for operations different from those intended could result in a hazardous situation.

5) BATTERY TOOL USE AND CARE

- a) **Recharge only with the charger specified by the manufacturer.** A charger that is suitable for one type of battery pack may create a risk of fire when used with another battery pack.
- b) **Use power tools only with specifically designated battery packs.** Use of any other battery packs may create a risk of injury and fire.
- c) **When battery pack is not in use, keep it away from other metal objects, like paper clips, coins, keys, nails, screws or other small metal objects, that can make a connection from one terminal to another.** Shorting the battery terminals together may cause burns or a fire.
- d) **Under abusive conditions, liquid may be ejected from the battery; avoid contact. If contact accidentally occurs, flush with water.**

If liquid contacts eyes, additionally seek medical help. Liquid ejected from the battery may cause irritation or burns.

6) SERVICE

- a) Have your power tool serviced by a qualified repair person using only identical replacement parts.** This will ensure that the safety of the power tool is maintained.

SCREW DRIVER AND IMPACT WRENCH SAFETY WARNING

- 1. Hold power tool by insulated gripping surfaces, when performing an operation where the fastener may contact hidden wiring.** Fasteners contacting a “live” wire may make exposed metal parts of the power tool “live” and could give the operator an electric shock.

SAFETY WARNINGS FOR BATTERY CHARGERS

 **WARNING Read all safety warnings and all instructions.** Failure to follow the warnings and instructions may result in electric shock, fire and/or serious injury.

Save all warnings and instructions for future reference.

This appliance can be used by children aged from 8 years and above and persons with reduced physical, sensory or mental capabilities or lack of experience and knowledge if they have been given supervision or instruction

concerning use of the appliance in a safe way and understand the hazards involved. Children shall not play with the appliance. Cleaning and user maintenance shall not be made by children without supervision.

ADDITIONAL SAFETY INSTRUCTIONS FOR YOUR BATTERY CHARGER

1. Before charging, read the instructions.
2. After charging, disconnect the battery charger from the supply mains. Then remove the chassis connection and then the battery connection.
3. Do not charge a leaking battery.
4. Do not use chargers for works other than those for which they are designed.
5. Before charging, ensure your charger is matching the local AC supply.
6. For indoor use, or do not expose to rain.
7. The charging device must be protected from moisture.
8. Do not use the charging device in the open.
9. Do not short out the contacts of battery or charger.
10. Respect the polarity “+/-” when charging.
11. Do not open the unit and keep out of the reach of children.
12. Do not charge the batteries of other manufactures or ill-suited models.
13. Ensure that the connection between the battery charger and battery is correctly positioned and is not obstructed by foreign bodies.
14. Keep battery charger’s slots are free of foreign objects and protect against dirt and humidity. Store in a dry and frost-free place.
15. When charging batteries, ensure that the battery

charger is in a well-ventilated area and away from inflammable materials. Batteries can get hot during charging. Do not overcharge any batteries. Ensure that batteries and chargers are not left unsupervised during charging.

16. Do not recharge non-rechargeable batteries, as they can overheat and break.
17. Longer life and better performance can be obtained if the battery pack is charged when the air temperature is between 18°C and 24°C. Do not charge the battery pack in air temperatures below 4.5°C, or above 40.5°C. This is important as it can prevent serious damage to the battery pack.
18. Charge only battery pack of the same model provided by WORX and of models recommended by WORX.





12 SAFETY WARNINGS FOR BATTERY CELLS INSIDE THE TOOL





- a) **Do not dismantle, open or shred cells.**
- b) **Do not short-circuit charging terminal. Do not store power tool haphazardly in a box or drawer where charging terminal may short-circuit each other or be short-circuited by conductive materials.** When power tool is not in use, keep it away from other metal objects, like paper clips, coins, keys, nails, screws or other small metal objects, that can make a connection from one charging terminal to another.
- c) **Do not expose power tool to heat or fire. Avoid storage in direct sunlight.**
- d) **Do not subject power tool to mechanical shock.**
- e) **In the event of battery leaking, do not allow**

the liquid to come into contact with the skin or eyes. If contact has been made, wash the affected area with copious amounts of water and seek medical advice.

- f) **Seek medical advice immediately if a cell has been swallowed.**
- g) **Keep power tool clean and dry.**
- h) **Wipe the charging terminals with a clean dry cloth if they become dirty.**
- i) **Power tool needs to be charged before use. Always refer to this instruction and use the correct charging procedure.**
- j) **Do not maintain power tool on charge when not in use.**
- k) **After extended periods of storage, it may be necessary to charge and discharge the power tool several times to obtain maximum performance.**
- l) **Battery gives its best performance when it is operated at normal room temperature (20°C ± 5°C).**
- m) **When disposing of cells, keep cells of different electrochemical systems separate from each other.**
- n) **Recharge only with the charger specified by WORX. Do not use any charger other than that specifically provided for use with the equipment.** A charger that is suitable for one type of battery may create a risk of fire when used with another battery.
- o) **Keep power tool out of the reach of children.**
- p) **Retain the original product literature for future reference.**
- q) **Dispose of properly.**

SYMBOLS

	Do not stare directly into the tool holder. When changing the tool insert, it can be thrown out toward the front
	To reduce the risk of injury, user must read instruction manual
	Warning
	Wear eye protection
	Wear ear protection
	Wear dust mask
	Do not burn
	Do not expose to rain or water

	For indoor use only
	The output plug is with positive center pole and negative outer pole
	Fuse
	Waste electrical products must not be disposed of with household waste. Please recycle where facilities exist. Check with your local authorities or retailer for recycling advice.
	Do not dispose of batteries, Return exhausted batteries to your local collection or recycling point.
	xINR18/65-y: Cylindrical lithium ion battery cells with max diameter of 18mm and max height of 65mm; “x” represents a number cells serial connected, blank if 1; “-y” represents a number of cells paralleled connected, blank if 1

OPERATING INSTRUCTIONS



NOTE: Before using the tool, read the instruction book carefully.

INTENDED USE

The power tool is intended for driving in and loosening screws as well as for drilling in wood, metal and plastic.

ACTION	FIGURE
Before operation	
Charging the Battery NOTE: 1. Maximize Battery Performance Prior to initial use, the battery must be charged 5 hours to fully utilize the battery capacity. 2. When the battery is full charged, the light turns green.	See Fig. A
Assembly and adjustment	
Inserting and Removing the Bit Cartridge	See Fig B1,B2
Selecting the Proper Bit  WARNING: Do not stare directly into the tool holder. When changing the tool insert, it can be thrown out toward the front. NOTE: Slide the Cover fully open, past the red line on the tool. The Bit Cartridge will advance automatically. (The Bit Cartridge may be manually rotated to the left to select the Bit as well.)	See Fig C1,C2

Forward/reverse/lock



WARNING: Never change the direction of rotation when the chuck is rotating, wait until it is stopped!

See Fig. E1,E2,E2

Operation

Operating the On/Off Switch



WARNING: Do not operate for long periods at low speed because excess heat will be produced internally.

See Fig. F

LED Light Indicator

See Fig. F

MAINTENANCE

Your power tool requires no additional lubrication or maintenance. There is no user serviceable parts in your power tool. Never use water or chemical cleaners to clean your power tool. Wipe clean with a dry cloth. Always store your power tool in a dry place. Keep the motor ventilation slots clean. Keep all working controls free of dust. If you see some sparks flashing in the ventilation slots, this is normal and will not damage your power tool.

ENVIRONMENTAL PROTECTION



Waste electrical products must not be disposed of with household waste. Please recycle where facilities exist. Check with your local authorities or retailer for recycling advice.

DECLARATION OF CONFORMITY

We,
Positec PowerTools (Europe) Ltd, PO Box 6242, Newbury,
RG14 9LT, UK

Declare that the product,

Description **Cordless Screwdriver**

Type **WX254 WX254.1 WX254.3 WX254.4
WX254.6 WX254.7 (250~269-designation of
machinery, representative of Battery-powered
Screwdriver)**

Function **Tightening and loosening screws, nuts**

Complies with the following directives,

2006/42/EC

2011/65/EU

2014/30/EU

2014/35/EU

Standards conform to:

EN 55014-1

EN 55014-2

EN 60745-1

EN 60745-2-2

EN 60335-1

EN 60335-2-29

EN 62233

EN 61000-3-2

EN 61000-3-3

The person authorized to compile the technical file,

Name Russell Nicholson

Address Positec Power Tools (Europe) Ltd,

PO Box 6242, Newbury, RG14 9LT, UK



Suzhou 2016/03/28

Allen Ding

Deputy Chief Engineer, Testing & Certification

LITHIUM ION BATTERY

**Handle With Care. Do Not Load or
Transport Package If Damaged.
A Fire Hazard Could Exist.**

For more information, call: +86-512-65152811



www.worx.com

Copyright © 2016, Positec. All Rights Reserved.
AR01232300